



Connells

Martock Road  
Bristol



### Property Description

Set in a well-connected pocket of BS5, this inviting home blends everyday practicality with warm, lived-in comfort. The ground floor opens with a bright living room, leading through to a dedicated dining room that naturally becomes the centre of family life. Beyond this, a separate kitchen offers a practical workspace with direct access to the rear garden — ideal for stepping out with a morning coffee or keeping an eye on children playing outside.

Upstairs, two bedrooms offer generous versatility. The main bedroom is a surprisingly spacious retreat, with built-in storage and room to shape the space around your own rhythm. The second bedroom, currently arranged with twin beds, is bright and balanced, making it a natural fit for children, guests, or a dedicated workspace. A well-kept bathroom completes the first floor, with a double-glazed rear window and a clean, practical layout.

Outside, the garden provides a private backdrop for family life — enclosed, easy to maintain, and with space for seating, play, and storage. With its straightforward footprint, natural light, and adaptable rooms, this is a home that quietly supports the way you live, offering comfort, convenience, and a sense of place within a friendly Bristol neighbourhood.

### Living Room

14' 5" x 11' 9" (4.39m x 3.58m)  
A bright and welcoming living space with a double-glazed front-aspect window drawing natural light across the room. The layout comfortably accommodates both seating and a workspace. A radiator sits along the side wall, warming the room without interrupting the arrangement of furniture.

### Dining Room

11' 8" x 7' 11" (3.56m x 2.41m)  
A dedicated dining room positioned between the living room and kitchen, offering a natural setting for family meals. A double-glazed rear-aspect window brings in soft light from the garden side, giving the room an easy, relaxed feel.

### Kitchen

12' 7" x 7' 9" (3.84m x 2.36m)  
A practical kitchen with generous worktop space, wooden cabinetry, and room for appliances. A double-glazed rear-aspect window sits above the sink, offering a pleasant view out to the garden, while the rear door provides direct access outside.

### Wc

A compact and convenient ground-floor cloakroom finished in a simple, neutral style.

### Bedroom One

14' 10" max x 9' 9" max (4.52m max x 2.97m max)  
A spacious main bedroom with a double-glazed front-aspect window. Built-in cupboards and the boiler unit sit neatly along one wall, with the boiler tucked around a small corner out of the way. A wall-mounted radiator is positioned underneath one of the windows.

### Bedroom Two

9' 5" x 6' 11" (2.87m x 2.11m)  
Currently shown with two single beds, this bright room features a double-glazed rear-aspect window overlooking the garden. Its balanced proportions make it ideal for children, guests, or a flexible workspace.

### Bathroom



A clean, well-kept bathroom with a frosted double-glazed window providing natural light and ventilation. The suite includes a panelled bath with shower over, WC and wash hand basin with vanity unit. Partially tiled walls, linoleum flooring and wall-mounted radiator.

### Garage

20' 6" x 11' 6" ( 6.25m x 3.51m )

A generous detached garage offering excellent storage, workshop potential, or secure parking. No windows or radiator visible.





**Ground Floor**

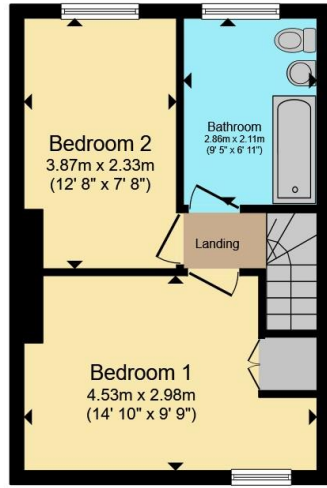

**First Floor**

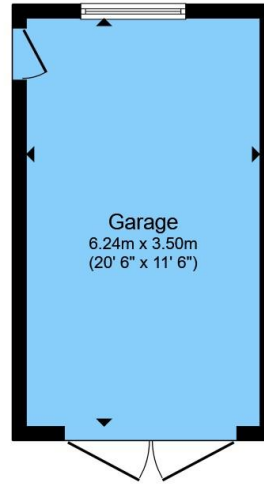

**Garage**



Total floor area 93.4 m<sup>2</sup> (1,005 sq.ft.) approx

This floor plan is for illustrative purposes only. It is not drawn to scale. Any measurements, floor areas (including any total floor area), openings and orientation are approximate. No details are guaranteed, they cannot be relied upon for any purpose and they do not form part of any agreement. No liability is taken for any error, omission or misstatement. A party must rely upon its own inspection(s). Powered by [www.propertybox.io](http://www.propertybox.io)



To view this property please contact Connells on

**T 0117 966 4278**

**E [southville@connells.co.uk](mailto:southville@connells.co.uk)**

243 North Street Southville  
BRISTOL BS3 1JN

EPC Rating: C Council Tax  
Band: B

**view this property online [connells.co.uk/Property/BMR312369](http://connells.co.uk/Property/BMR312369)**

Tenure: Freehold



1. MONEY LAUNDERING REGULATIONS Intending purchasers will be asked to produce identification documentation at a later stage and we would ask for your co-operation in order that there will be no delay in agreeing the sale. 2. These particulars do not constitute part or all of an offer or contract. 3. The measurements indicated are supplied for guidance only and as such must be considered incorrect. Potential buyers are advised to recheck measurements before committing to any expense. 4. We have not tested any apparatus, equipment, fixtures, fittings or services and it is in the buyers interest to check the working condition of any appliances.

Connells Residential is registered in England and Wales under company number 1489613, Registered Office is Cumbria House, 16-20 Hockliffe Street, Leighton Buzzard, Bedfordshire, LU7 1GN. VAT Registration Number is 500 2481 05.

**See all our properties at [www.connells.co.uk](http://www.connells.co.uk) | [www.rightmove.co.uk](http://www.rightmove.co.uk) | [www.zoopla.co.uk](http://www.zoopla.co.uk)**

Property Ref: BMR312369 - 0002