



Redmayne Arnold & Harris
estate agents, letting agents & surveyors

rah.co.uk



TO LET



245a The Sycamores, Milton, Cambridge, Cambridgeshire, CB24 6ZD

£2,400 PCM



THE PROPERTY

A beautifully presented four bedroom detached family home, located on the outskirts of Cambridge in this popular village. The property has been thoughtfully designed by its owners and comprises entrance hall, living room, open-plan kitchen/dining room, W/C, four double bedrooms with en-suite to master, and a family bathroom. There is a garden to the rear, with garage and driveway parking. The property will be managed by RAH.

- EPC Rating: C
- Council Tax Band: E
- Minimum 12 Month Tenancy
- Deposit: £2760
- Holding Deposit: £390

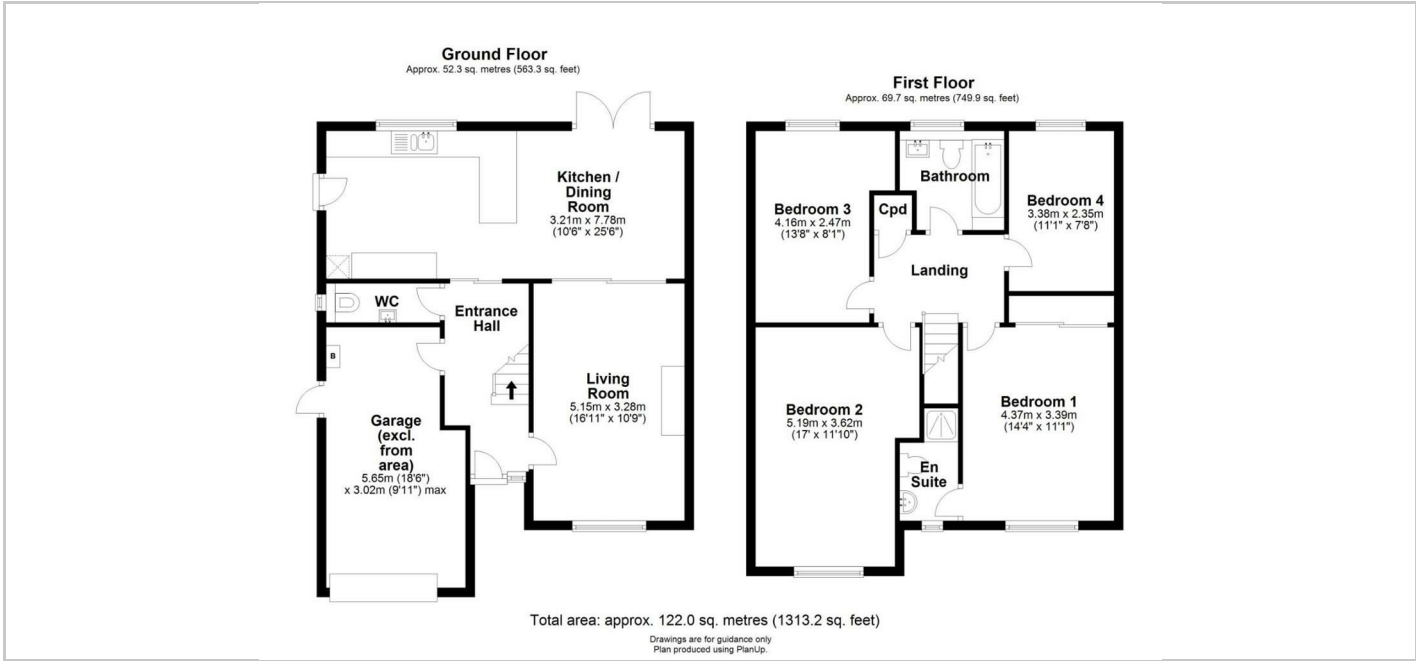

Directions

SITUATION

