

Fords.

SALES | LETTINGS | NEW HOMES



Flat 29 Victoria House 28-32 Desborough Street, High Wycombe, HP11 2NF

A spacious and modern two-bedroom apartment ideally located in the heart of High Wycombe. The property boasts a bright open-plan living area with a contemporary fitted kitchen and integrated appliances, two well-proportioned double bedrooms, and a stylish family bathroom.

- **Two Double Bedrooms**
- **Recently Renovated Apartment**
- **Residents Parking Available**
- **Newly Fitted Kitchen**
- **Newly Installed Family Bathroom**
- **Close to Town Centre**
- **Available immediately**
- **Arrange your viewing today!**

£1,450 Per month

Victoria House

Approx. Gross Internal Area 479 Sq Ft - 44.50 Sq M

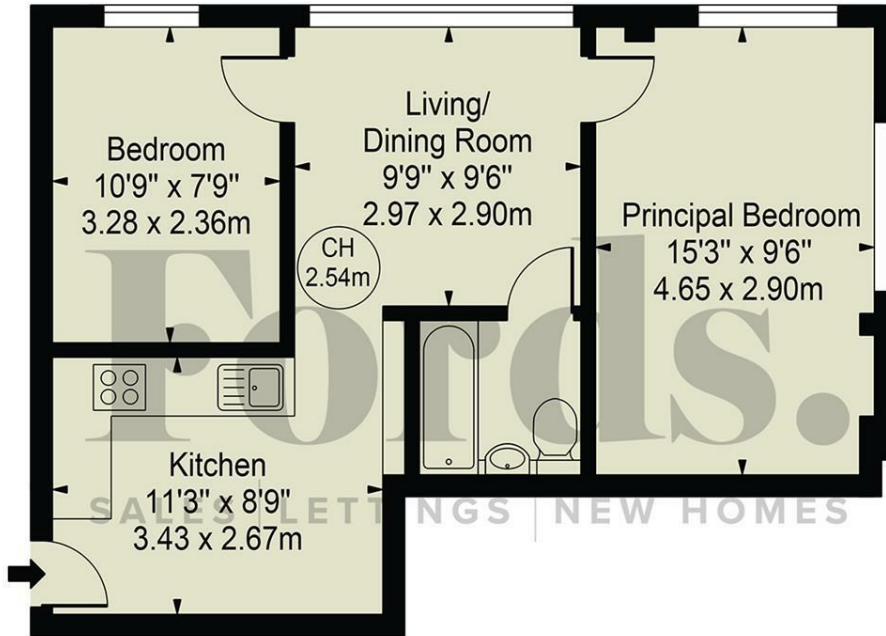

Second Floor

For Illustration Purposes Only - Not To Scale

This floor plan should be used as a general outline for guidance only and does not constitute in whole or in part an offer or contract. Any intending purchaser or lessee should satisfy themselves by inspection, searches, enquiries and full survey as to the correctness of each statement. Any areas, measurements or distances quoted are approximate and should not be used to value a property or be the basis of any sale or let. Copyright Morriarti Photography & Design LTD

Energy Efficiency Rating		Current	Potential
Very energy efficient - lower running costs			
(92 plus) A			
(81-91) B			
(69-80) C			
(55-68) D			
(39-54) E			
(21-38) F			
(1-20) G			
Not energy efficient - higher running costs			
England & Wales	EU Directive 2002/91/EC	69	

Environmental Impact (CO ₂) Rating		Current	Potential
Very environmentally friendly - lower CO ₂ emissions			
(92 plus) A			
(81-91) B			
(69-80) C			
(55-68) D			
(39-54) E			
(21-38) F			
(1-20) G			
Not environmentally friendly - higher CO ₂ emissions			
England & Wales	EU Directive 2002/91/EC		



18 Crendon Street, High Wycombe, HP13 6LS

Tel: 01494 840 600 Email: sales@fordandpartners.com www.fordandpartners.com