



John Ruskin Street | London | SE5

Leasehold

£390,000

- Three double bedrooms
- Private balcony
- Split level
- Lots of natural light
- Plenty of storage
- Chain free
- Local amenities
- Oval tube
- Excellent bus routes
- Kennington Park



A spacious, split level 3 bedroom flat that feels light and bright and situated over the first and second floors of a purpose built residential block, this great city pad is well located with easy access to Oval tube. Laminate flooring in the reception and neutral decor throughout, everything is in place for you to put your own stamp and style on this apartment. Two good sized double bedrooms and another single bedroom, a spacious separate lounge, a large kitchen, bathroom and separate W.C with built in storage and a private balcony. Neighbouring Kennington Park has a café, tennis courts and sports facilities, farmers market at St Marks church is also popular. Transport links: Northern line at nearby Oval tube station, multiple buses to Victoria, Marble Arch or Paddington.

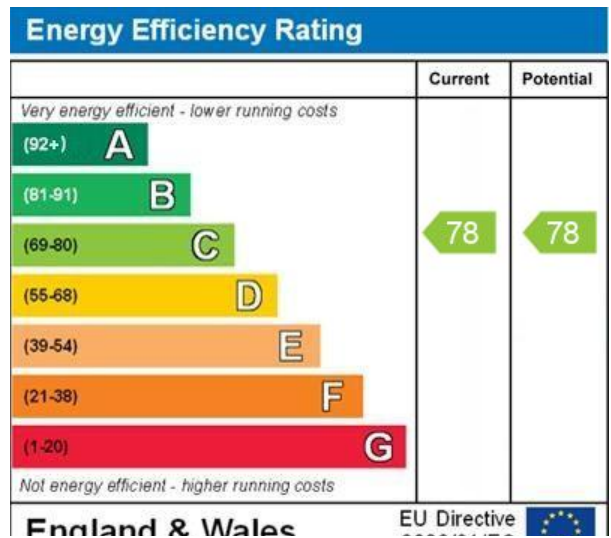

GROUND FLOOR
494 sq.ft. (45.9 sq.m.) approx.

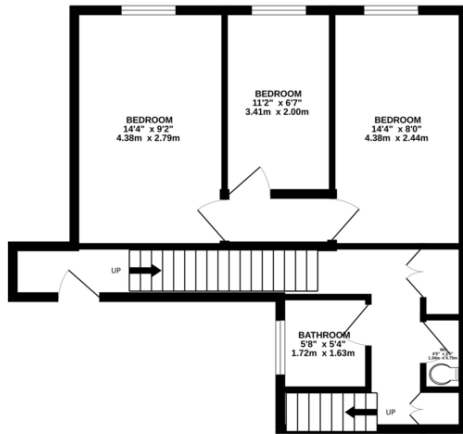

1ST FLOOR
305 sq.ft. (28.4 sq.m.) approx.

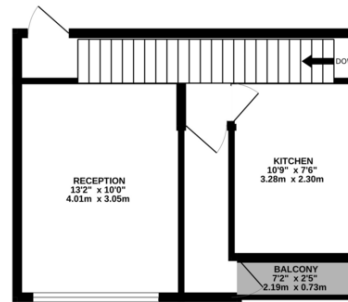

TOTAL FLOOR AREA : 800 sq.ft. (74.3 sq.m.) approx.

Whilst every attempt has been made to ensure the accuracy of the floorplan contained here, measurements of doors, windows, rooms and any other items are approximate and no responsibility is taken for any error, omission or mis-statement. This plan is for illustrative purposes only and should be used as such by any prospective purchaser. The services, systems and appliances shown have not been tested and no guarantee as to their operability or efficiency can be given.
Made with Metropix 12/2005

Viewing Arrangements

Strictly by appointment

Contact Details

121 Denmark Hill

London

SE5 8EN

www.urbanvillagehomes.co.uk

sales@urbanvillagehomes.com

020 3519 9121

Agents Note: Whilst every care has been taken to prepare these sales particulars, they are for guidance purposes only. All measurements are approximate and for general guidance purposes only and whilst every care has been taken to ensure their accuracy, they should not be relied upon and potential buyers are advised to recheck the measurements