



49 Whirlow Lane

Whirlow, Sheffield, S11 9QF

Asking Price £1,450,000



6



3



4



10 D

49 Whirlow Lane



Description

Standing in nearly an acre of grounds (0.9 of an acre) and offering above 4741 square feet of accommodation over three floors this is clearly one of the cities most desirable roads. With a lovely feel throughout and plenty of space on both the inside and out, this is the perfect home for large families and keen gardeners. Situated a short stroll away from the bucolic charm of The Limb Valley which adds a rural slant to this urban idyll. The property is also conveniently placed for local, highly regarded schooling and Whirlow Farms excellent café/restaurant.

- ELR Premium Sale - Buyers fees of £595 including VAT will apply.
- Two spacious reception rooms alongside a versatile garden room and a ground floor home office/snug.
- Three bathrooms including two ensuites.
- Six bedrooms which include five good doubles and a principal suite which has an ensuite dressing room.
- Large and very well presented dining kitchen with a central island and a lantern light, perfect for family life and entertaining guests.
- Off road parking for a number of cars and a large, integrated double garage.





Floor Plan

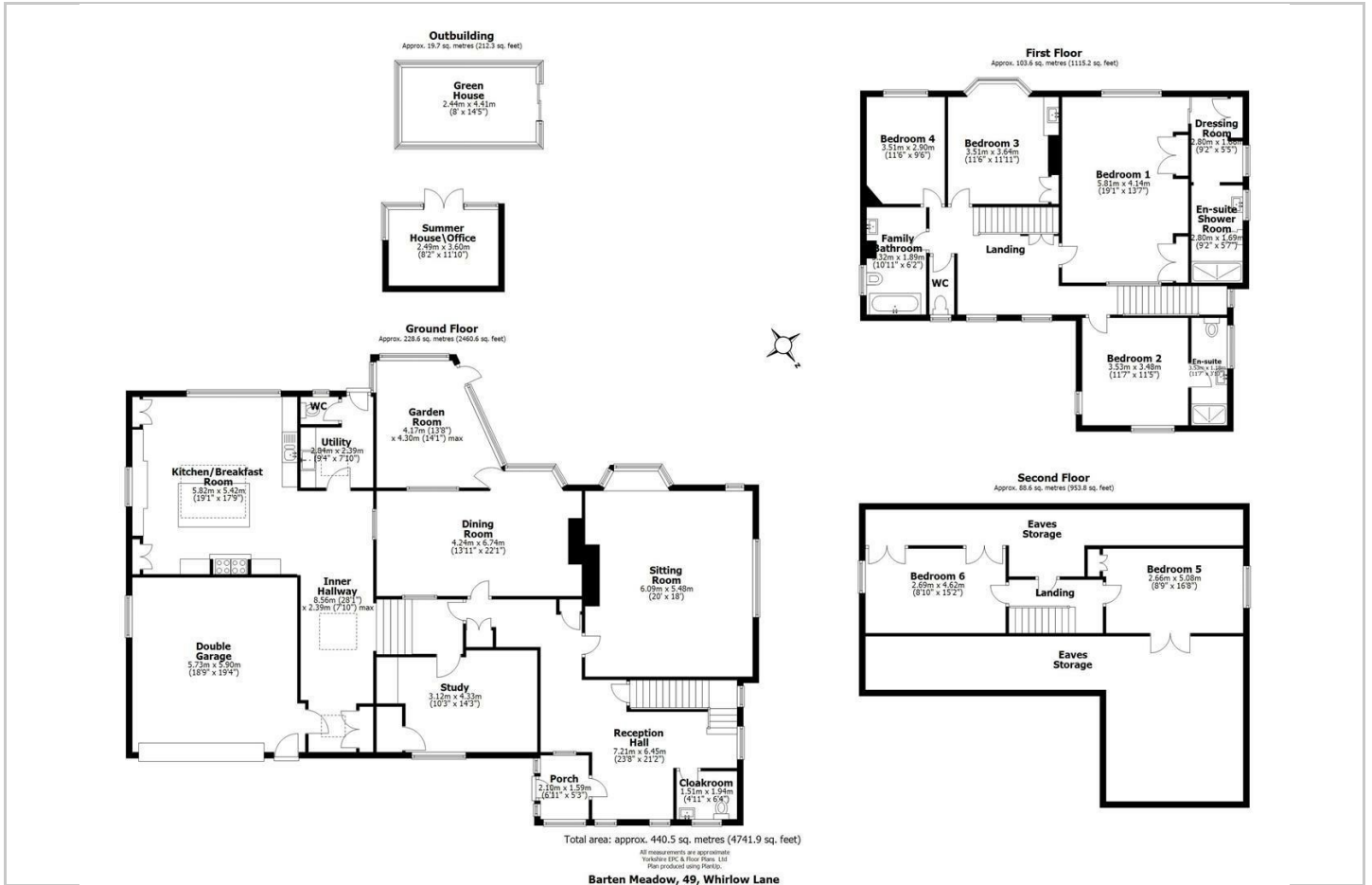

Area Map

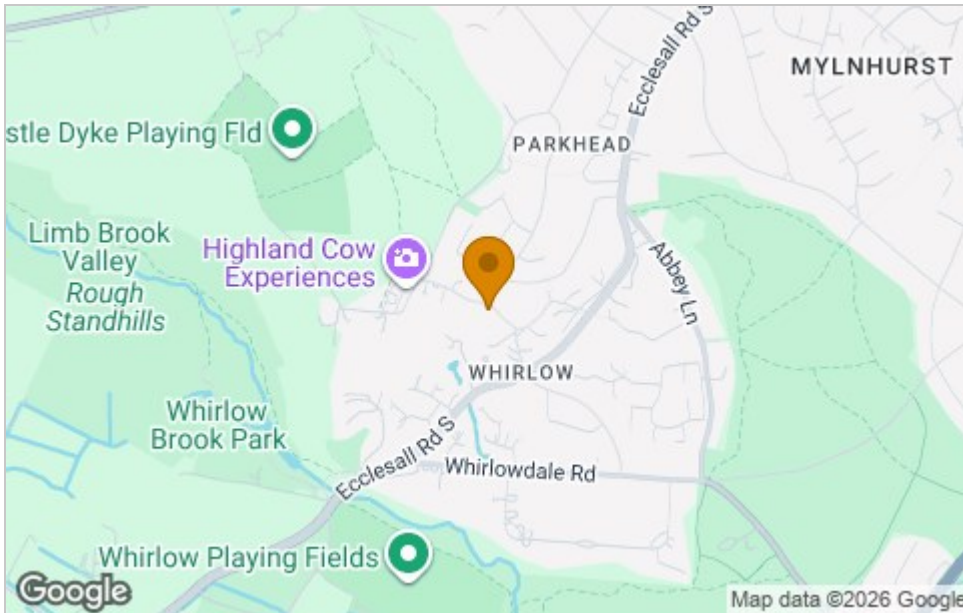

Viewing

Please contact our ELR Banner Cross Office on 0114 268 3388 if you wish to arrange a viewing appointment for this property or require further information.

Energy Efficiency Graph

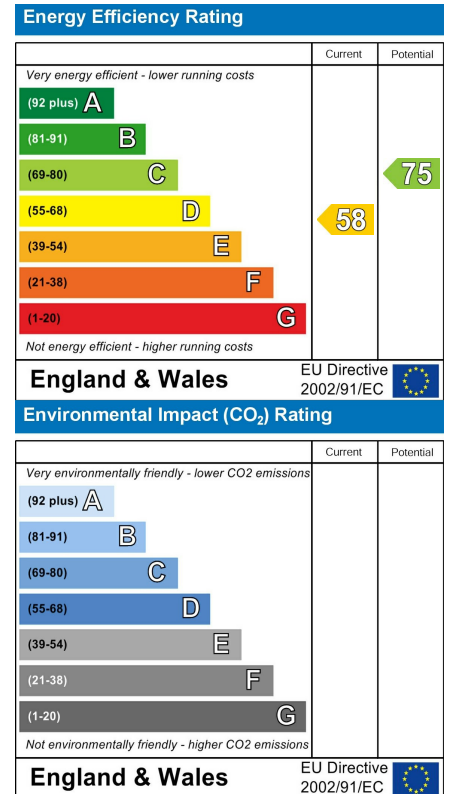

These particulars, whilst believed to be accurate are set out as a general outline only for guidance and do not constitute any part of an offer or contract. Intending purchasers should not rely on them as statements of representation of fact, but must satisfy themselves by inspection or otherwise as to their accuracy. No person in this firm's employment has the authority to make or give any representation or warranty in respect of the property.