



jordan fishwick

BURNAGE
Devon Avenue



Devon Avenue, Burnage, M19 2JH

£370,000



The Property

An attractive period semi detached property which has been well cared for over the years, offering a great blend of original characteristics alongside today's more modern comforts, with a southerly facing garden, cul-de-sac location and no onward chain. 1059 sq ft. The living space benefits from gas central heating and majority uPVC double glazing. The property comprises: Entrance hall with staircase to the first floor, lounge with bay window with plantation shutters and cast iron feature fire place, separate dining room with wood burner and French doors to the rear garden and kitchen extending over 16ft. To the first floor: three double bedrooms and family bathroom with white suite and rain forest shower over bath. The property is set behind a paved garden to the front, with a south facing rear garden and mature borders. No chain.

Directions

M19 2JH

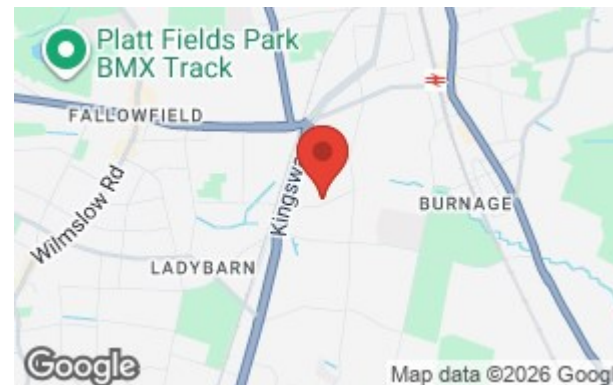

- Period semi detached property
- Three double bedrooms
- Two reception rooms
- Re-fitted extended kitchen
- Re-fitted bathroom
- Residential cul de sac
- Period features
- No chain

Postcode - M19 2JH

EPC Rating - D

Floor Area - 1059.00 sq ft

Local Authority - Manchester City Council

Council Tax - C



GROUND FLOOR
553 sq.ft. (51.4 sq.m.) approx.

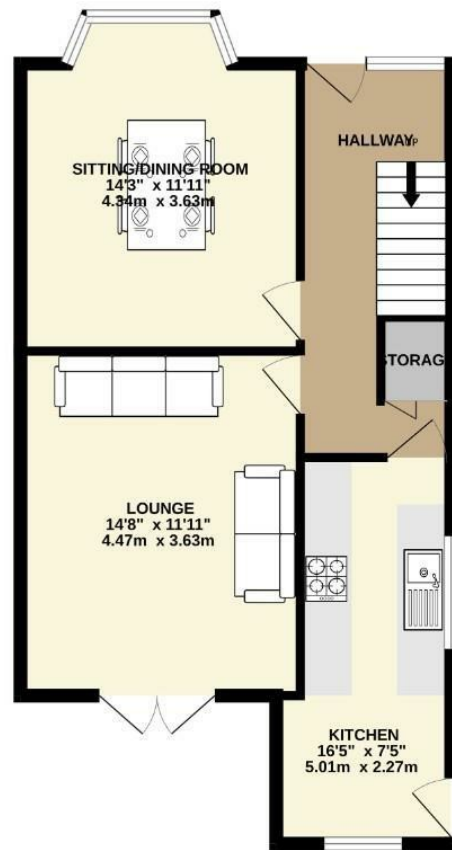

1ST FLOOR
506 sq.ft. (47.0 sq.m.) approx.

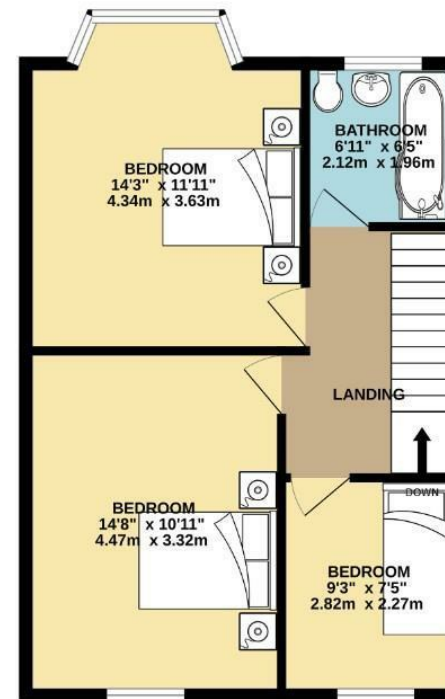

TOTAL FLOOR AREA: 1059 sq.ft. (98.4 sq.m.) approx.
Measurements are approximate. Not to scale. Illustrative purposes only
Made with Metropix ©2025



These particulars are believed to be accurate but they are not guaranteed and do not form a contract. Neither Jordan Fishwick nor the vendor or lessor accept any responsibility in respect of these particulars, which are not intended to be statements or representations of fact and any intending purchaser or lessee must satisfy himself by inspection or otherwise as to the correctness of each of the statements contained in these particulars. Any floorplans on this brochure are for illustrative purposes only and are not necessarily to scale.

Offices also at: Wilmslow, Macclesfield, Hale, Sale, Chorlton, Glossop, Manchester & Salford

757-759 Wilmslow Road, Didsbury Village, Manchester

0161 445 4480

didsbury@jordanfishwick.co.uk
www.jordanfishwick.co.uk