



Lyndhurst Court

Finchley Road, St John's Wood, NW8 6ET

£680 Per Week

A unique two double bedroom detached cottage, situated within the grounds of Lyndhurst Court, and only a moments walk from St John's Wood station. This spacious property has its own private entrance with the living space spread out across the first floor. Comprising of:- Entrance hallway leading out into a sunny private terrace to the rear of the building, staircase leading up to large reception room, two double bedrooms, both with fitted wardrobes, large bathroom and separate fitted kitchen. The cottage has recently been redecorated and re-carpeted throughout. The property also benefits from having access to parking for one car in a secure car park and has central heating. The property is offered furnished and will be available from early June (please note garage does NOT come with the property)

- Cottage
- Two Bedrooms
- Private Terrace
- Secure Parking
- Moments from Station
- Gas Central Heating

Viewing

Please contact our Messila Residential Office on 020 7586 6699 if you wish to arrange a viewing appointment for this property or require further information.



Floor Plan

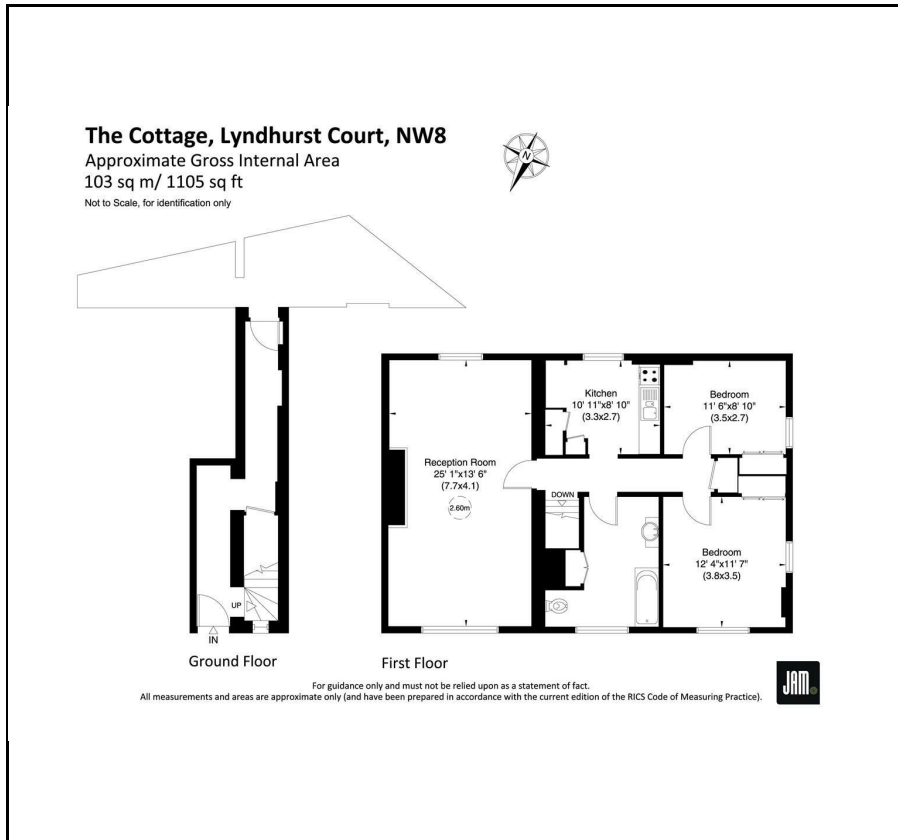

Area Map

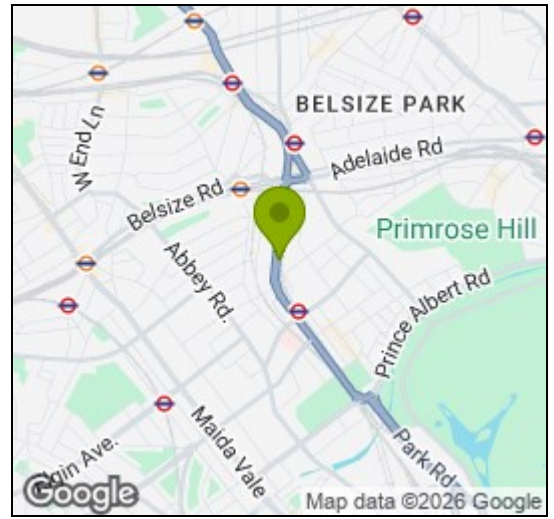

Energy Efficiency Graph

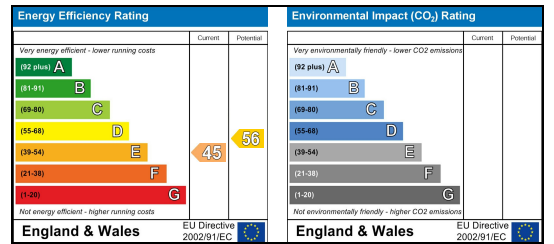

These particulars, whilst believed to be accurate are set out as a general outline only for guidance and do not constitute any part of an offer or contract. Intending purchasers should not rely on them as statements of representation of fact, but must satisfy themselves by inspection or otherwise as to their accuracy. No person in this firm's employment has the authority to make or give any representation or warranty in respect of the property.

Messila Residential

137 Park Road, London, NW8 7HT

T: 020 7586 6699 E: regentspark@messilaresidential.com W: messilaresidential.com