

Location:

Brougham Road is an access only road and less than five minutes walk from Acton Main Line station (Elizabeth line). North Acton (Central line) and Acton Central (Overground) stations are just over three quarters of a mile away.

Key points:

- Three bedrooms
- First floor flat
- 885 sq ft / 82.26 sq m
- Private terrace
- Share of freehold
- No onward chain

Do Better:

Acton
sales@astonrowe.co.uk

57-59 Churchfield Road,
Acton, London, W3 6AY

020 8992 3600

Brougham Road, W3 6JD

Approx Gross Internal Area = 82.26 sq m / 885 sq ft
Terrace = 9.76 sq m / 105 sq ft
Total = 92.02 sq m / 990 sq ft

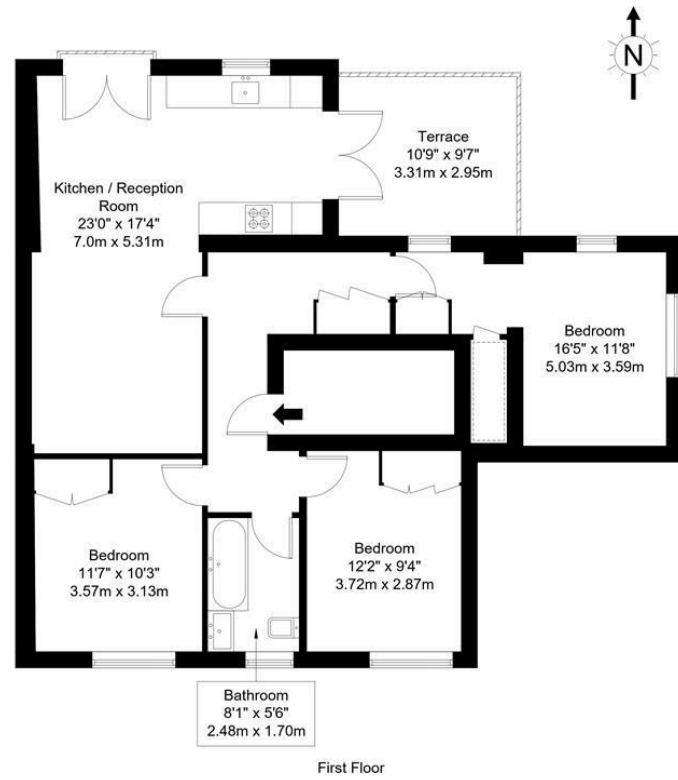

Ref :

Copyright **BLEU PLAN**

The Floor plan is not to scale and measurements and areas shown are approximate and therefore should be used for illustrative purposes only. The plan has been prepared in accordance with the RICS code of Measuring Practice and whilst we have confidence in the information produced it must not be relied on. Maximum lengths and widths are represented on the floor plan. If there is any aspect of particular importance, you should carry out or commission your own inspection of the property.
Copyright @ BLEUPLAN

Energy Efficiency Rating		Environmental Impact (CO ₂) Rating	
Current	Potential	Current	Potential
79	83		

England & Wales EU Directive 2002/91/EC

£600,000

Brougham Road, Acton W3 6JD

- 1 Reception Rooms
- 3 Bedrooms
- 1 Bathrooms





The current owner says:

The property is in a fantastic location for the local shops, schools, parks and transport links.

A first floor three bedroom apartment with a large private terrace. The property is in excellent condition throughout, offers almost 900 sq.ft of accommodation and has no onward chain.

Situated on an access only road and less than five minutes walk from Acton Main Line station (Elizabeth line). North Acton (Central line) and Acton Central (Overground) stations are just over three quarters of a mile away.

What's better:

A first floor three bedroom apartment with a large private terrace. The property is in excellent condition throughout, offers almost 900 sq.ft of accommodation and has no onward chain.

