

# FLETCHERS

ESTATE AGENTS



## Russell Road, W14

£745,000

An immaculately presented two bedroom apartment situated in a highly sought after purpose built development moments from Kensington High Street. Situated on the ground floor, this lovely flat benefits from two large double bedrooms, a wonderful open plan kitchen/living area that has been modernised tastefully and comes complete with high spec fitted appliances. The master bedroom benefits from an en-suite bathroom and Juliette balcony allowing plenty of natural light. The second bedroom has built in storage and access to a modern family bathroom.

Russell Road is a quiet tree lined street in the Borough of Kensington & Chelsea only a street away from Kensington High Street renowned for its exceptional shops, bars & array of restaurants. The green spaces of Holland Park are nearby. There are excellent transport links under a mile away with Kensington Olympia Station (District Line & Overground) only 260ft & Shepherds Bush (Central Line) under a mile away.

- Gated Allocated Parking • Two Double Bedrooms • Lift Access • Immaculate Condition • Open Plan Kitchen/Living Area • Kensington High Street Location •

# FLETCHERS

ESTATE AGENTS

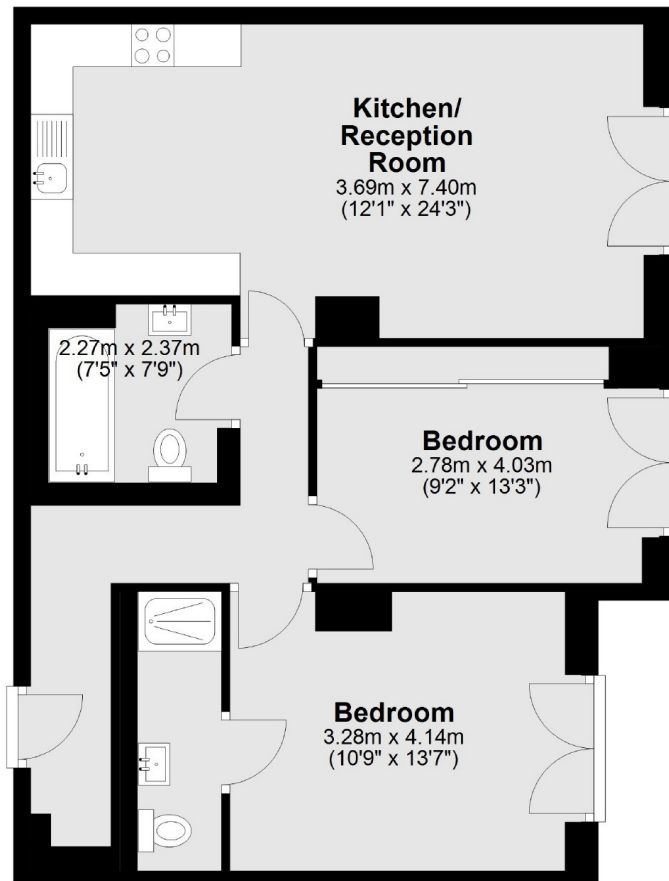

Total area: approx. 70.6 sq. metres (759.8 sq. feet)

Fletchers Brook Green Sales  
144 Shepherds Bush Road, Hammersmith, London, W6 7PB  
020 7603 1415  
[brookgreensales@fletcherestates.com](mailto:brookgreensales@fletcherestates.com)

Energy Rating: C. We aim to make our particulars both accurate and reliable. However they are not guaranteed; nor do they form part of an offer or contract. If you require clarification on any points then please contact us, especially if you're traveling some distance to view. Please note that appliances and heating systems have not been tested and therefore no warranties can be given as to their good working order.