



 **patrick**
gardner
LETTINGS

Middle Road, Leatherhead, KT22 7HN

£1,175 PCM



- AVAILABLE 15TH APRIL
- ONE BEDROOM APARTMENT
- MODERN BATHROOM
- CLOSE TO LEATHERHEAD TOWN CENTRE
- UNFURNISHED
- OPEN PLAN KITCHEN/LIVING
- OFF STREET PARKING FOR ONE VEHICLE
- WALKING DISTANCE TO MAIN LINE STATION

Description

One bedroom apartment with off street parking and close to Leatherhead town centre and mainline station. Property comprises open plan living/kitchen, double bedroom and modern bathroom.

Situation

Leatherhead town centre offers a variety of shops, quality independent restaurants and coffee shops. Within the area there are highly regarded both state and private schools including St Andrews R.C. School, St John's School and Downsden School whilst at nearby Mickleham is Box Hill School.

Leatherhead's mainline railway station offers commuter access to London Waterloo & Victoria and access south to Guildford & Dorking. Junction 9 of the M25 at Leatherhead provides access to the national motorway network together with Heathrow and Gatwick Airports.

The general area abounds in Green Belt countryside, much of which is National Trust owned offering plentiful of outdoor activities at Bocketts Farm, Denbies Wine Estate, and Polesden Lacy. Epsom Downs (home of the famous Epsom Derby horse race) is within 15 minutes drive and Headley Heath is just 10 minutes away.

EPC	D
Council Tax Band	B

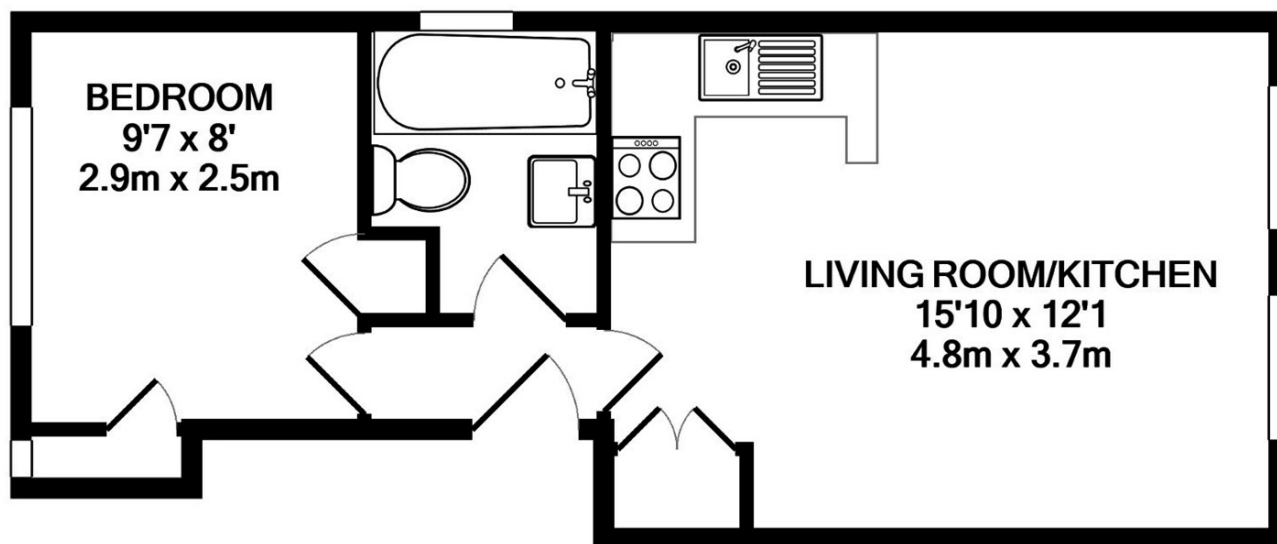

TOTAL APPROX. FLOOR AREA 327 SQ.FT. (30.4 SQ.M.)

Whilst every attempt has been made to ensure the accuracy of the floor plan contained here, measurements of doors, windows, rooms and any other items are approximate and no responsibility is taken for any error, omission, or mis-statement. This plan is for illustrative purposes only and should be used as such by any prospective purchaser. The services, systems and appliances shown have not been tested and no guarantee as to their operability or efficiency can be given

Made with Metropix ©2019

INFORMATION FOR TENANTS

Holding Deposit

We require one weeks' rental, payable by bank transfer as a holding deposit to secure a property. Once we have received your holding deposit, current legislation stipulates that the necessary paperwork should be completed by all parties within 15 days or such longer period as might be agreed.

Should your offer be agreed and you decide to proceed with a tenancy we require:

A refundable holding deposit of one weeks' rent at the beginning of negotiations. This amount will be deducted from your first months' rent prior to the commencement of the tenancy. Please be aware that should you withdraw from the negotiations, or be unable to provide suitable references this amount is **non-refundable**. Please further note that until this initial amount is paid the property may continue to be offered for rental.

References

We use the referencing company, Rightmove Referencing. The most straightforward way to complete the reference form is via an online link that your Lettings Negotiator will send by e-mail.

Rent

Rent will be paid monthly in advance by bankers' standing order set up to leave your account 3 days before the rent due date in order to allow funds to clear.

Deposit

A deposit of five weeks rental is held during the tenancy against damage and dilapidation Patrick Gardner & Co. are members of the Tenancy Deposit Scheme to safeguard your deposit.

Inventory and schedule of condition

A professional inventory clerk will check you into the property at the beginning of the tenancy. The charge for this is borne by the Landlord.

These particulars, whilst believed to be accurate are set out as a general outline only for guidance and do not constitute any part of an offer or contract. Intending purchasers should not rely on them as statements of representation of fact, but must satisfy themselves by inspection or otherwise as to their accuracy. No person in this firms employment has the authority to make or give any representation or warranty in respect of the property.