



Howard Building  
368 Queenstown Road, SW11









A fantastic studio apartment on the ground floor in Chelsea Bridge Wharf with a large private terrace.

This apartment benefits from a large open plan area that is flexible for a resident and how they would like to decide on layout.

The modern kitchen is compact but has been well designed to incorporate all appliances needed as well as not compromising on storage. The peaceful location of this beautiful riverside development is a short walk from Battersea Park and the buzz of Battersea Power Station.

The apartment is a great investment opportunity and can be purchased with tenants in residence if desired, please enquire for rental details.

The transport links of Queenstown Road and Battersea Park rail stations, running into Waterloo and London Victoria are close by. The Northern line tube can be found at Battersea Power Station and there are multiple buses available giving easy access to Central London.

Battersea Power Station offers an extensive range of amenities including upmarket shops, bars and restaurants.

- Studio Apartment
- Private Terrace on the water feature
- 24hr Concierge
- Fantastic location close the River Thames
- 392sq ft
- No onward chain

Guide Price £375,000

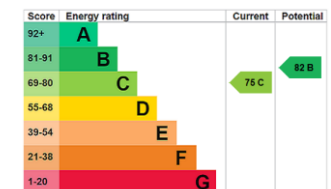

**Tenure:** Leasehold 973 years 10 months

**Service Charge:** TBA

**Ground Rent:** TBA

**Local Authority:** Wandsworth Council

**Council Tax Band:** E

*Chestertons Battersea Park & Nine Elms Sales*

62-64 Battersea Bridge Road

London

SW11 3AG

batterseapark@chestertons.co.uk

0203 040 8700

chestertons.co.uk

# Howard Building, Queenstown Road, SW11

Approximate gross internal area

36.42 sq m / 392 sq ft

Key :  
CH - Ceiling Height

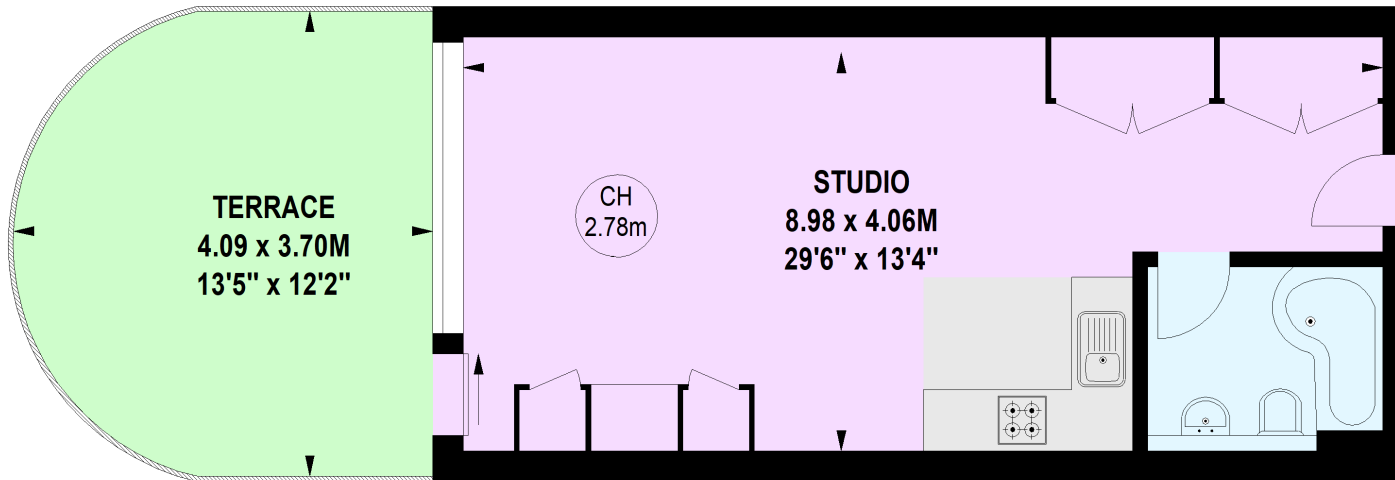

## Ground Floor

**Not to scale, for guidance only and must not be relied upon as a statement of fact.  
All measurements and areas are approximate only**

