



ADDISON ROAD, W14

£1,100,000

Top floor flat
Two double bedrooms
Communal gardens
Prime location
Natural light
Westerly aspect

@marshandparsons
marshandparsons.co.uk

MARSH &
PARSONS



ABOUT THE PROPERTY

Offering a spacious reception room with a delightful westerly aspect overlooking the superb communal gardens, this fantastic apartment benefits from plenty of natural light and comprises two double bedrooms, a modern fitted well appointed kitchen and bathroom. The property further boasts access to spacious well-maintained communal gardens.

Addison Road, one of Holland Park's most prestigious addresses, is just a short walk from the fantastic array of shops, restaurants and amenities of Holland Park and Kensington High Street, while the green spaces of Holland Park itself are moments away.



STEP INSIDE ADDISON ROAD

Addison Road, W14

APPROX. GROSS INTERNAL FLOOR AREA 833 SQFT / 77.39 SQM

Key :
CH - Ceiling Height

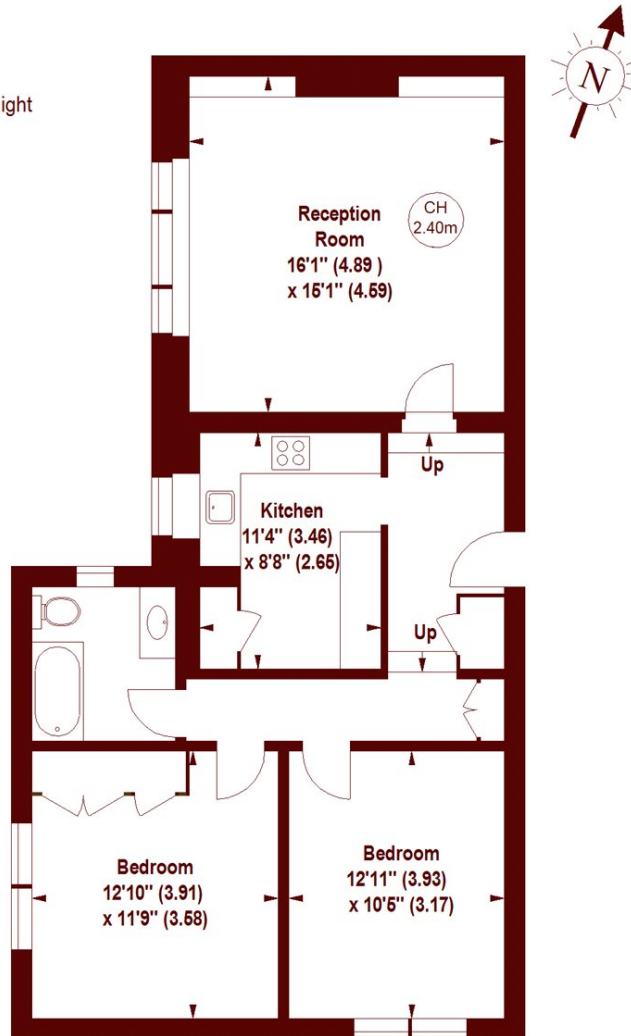

THIRD FLOOR

The floor plan is not to scale and measurements and areas shown are approximate and therefore should be used for illustrative purposes only. The plan has been prepared in accordance with the RICS code of Measuring Practice and whilst we have confidence in the information produced, it must not be relied on. If there is any aspect of particular importance, you should carry out or commission your own inspection of the property.
Copyright of FeaturePRO.

Holland Park
020 7605 6890

Energy Rating: D We aim to make our particulars both accurate and reliable. However, they are not guaranteed; nor do they form part of an offer or contract. If you require clarification on any points then please contact us, especially if you're traveling some distance to view. Please note that appliances and heating systems have not been tested and therefore no warranties can be given as to their good working order

MARSH &
PARSONS