



1 Bed
Flat
located in

£1,250



TAYLOR
MICHAEL

Lorna Road, Hove, BN3 3EP

Approximate Gross Internal Area = 38.8 sq m / 418 sq ft

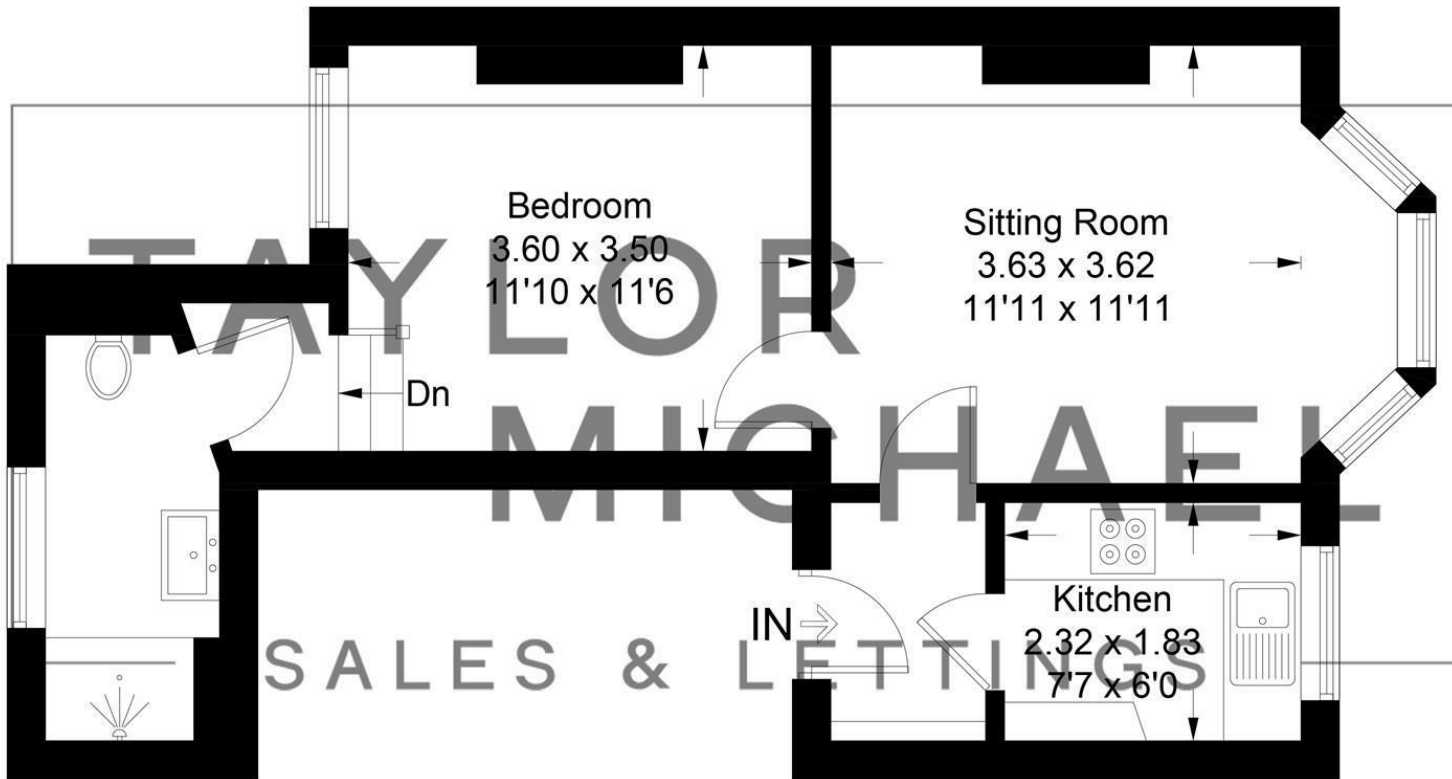

First Floor

Illustration for identification purposes only, measurements are approximate, not to scale.
Imageplansurveys @ 2026

Energy Efficiency Rating	
	Potential
Very energy efficient - lower running costs	
(92 plus) A	
(81-91) B	
(69-80) C	
(55-68) D	80
(39-54) E	68
(21-38) F	
(1-20) G	
Not energy efficient - higher running costs	
England & Wales	EU Directive 2002/91/EC

DIRECTIONS

CONTACT

62 Church Road
Hove
East Sussex
BN3 2FP

E: lettings@taylormichael.agency
T: 01273 600100
<https://taylormichael.agency/>

TAYLOR
MICHAEL