

Storer Road
Earl Shilton
LE9 7SW

£1,650 Per Month



OSCAR JAMES

...expect excellence

FLOOR PLANS

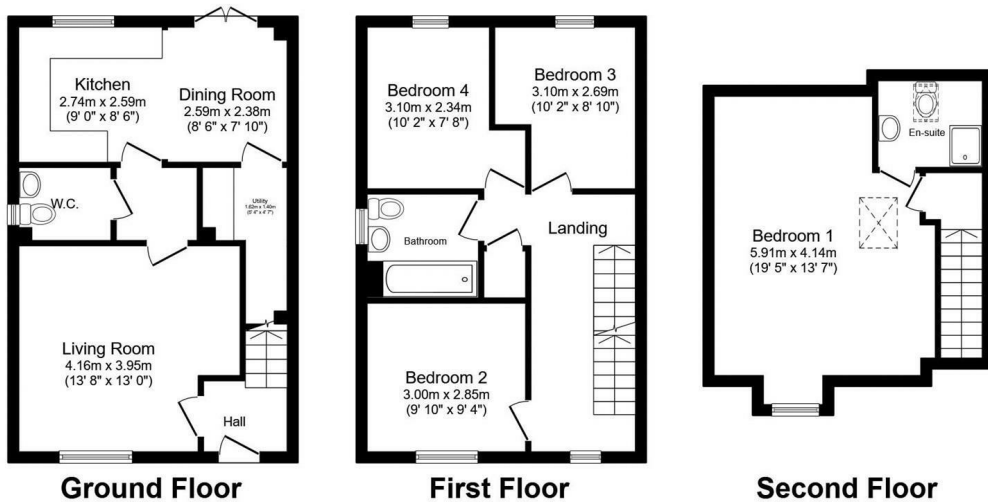

Total floor area 111.8 sq.m. (1,203 sq.ft.) approx

This floor plan is for illustrative purposes only. It is not drawn to scale. Any measurements, floor areas (including any total floor area), openings and orientation are approximate. No details are guaranteed, they cannot be relied upon for any purpose and they do not form part of any agreement. No liability is taken for any error, omission or misstatement. A party must rely upon its own inspection(s). Powered by www.focalagent.com



AT A GLANCE...



custom text 1



custom text 4



custom text 2



custom text 5



custom text 3



custom text 6



WHAT'S GREAT?

Welcome to this stunning new build property located on Storer Road in the charming town of Earl Shilton, Leicestershire. This beautifully designed semi detached house boasts four spacious bedrooms, making it an ideal family home. With two modern bathrooms, morning routines will be a breeze for everyone.

As you enter, you will find a welcoming reception room that offers a perfect space for relaxation or entertaining guests. The heart of the home is undoubtedly the fully fitted kitchen, which comes complete with integrated appliances, ensuring that cooking and dining experiences are both enjoyable and convenient.

This property is not only stylish but also practical, featuring off-road parking for two vehicles, which is a significant advantage in today's busy world. The location benefits from excellent local transport links, making commuting and exploring the surrounding areas effortless.

Built in 2025, this house is a brand new build, offering the latest in modern living with

energy-efficient features and contemporary design. Earl Shilton is a delightful community with a range of amenities, ensuring that you have everything you need right at your doorstep.

Offered fully furnished through Loft Furniture Collection at an additional rate pcm.

The property is managed by Touchstone Corporate Property Services who have received Landlord of the year awards.

Pets will be considered for an extra charge per month.

Early viewing is highly recommended to appreciate the quality, location and lifestyle this new build home provides.

EPC Rating - B

...expect excellence



SELLER'S SECRET



Why we like it....

OSCAR JAMES

1 Newland Street | Kettering | NN16 8JH
01536 415777
www.oscar-james.com

To buy or not to buy....
