



TARVES WAY, SE10

£1,800 per month

Modern Top Floor Apartment
Spacious Living Room with Dining Space
Fully Fitted Kitchen & Bathroom
Double Size Bedroom
Long Balcony with Views over Greenwich
Moments From Greenwich Mainline & DL
Offered

@marshandparsons
marshandparsons.co.uk

MARSH &
PARSONS



ABOUT THE PROPERTY

A fantastic opportunity to rent this lovely top floor apartment, built by Bellway Homes and just a few yards away from Greenwich mainline station and DLR stations, making this a dream for commuters.



STEP INSIDE TARVES WAY

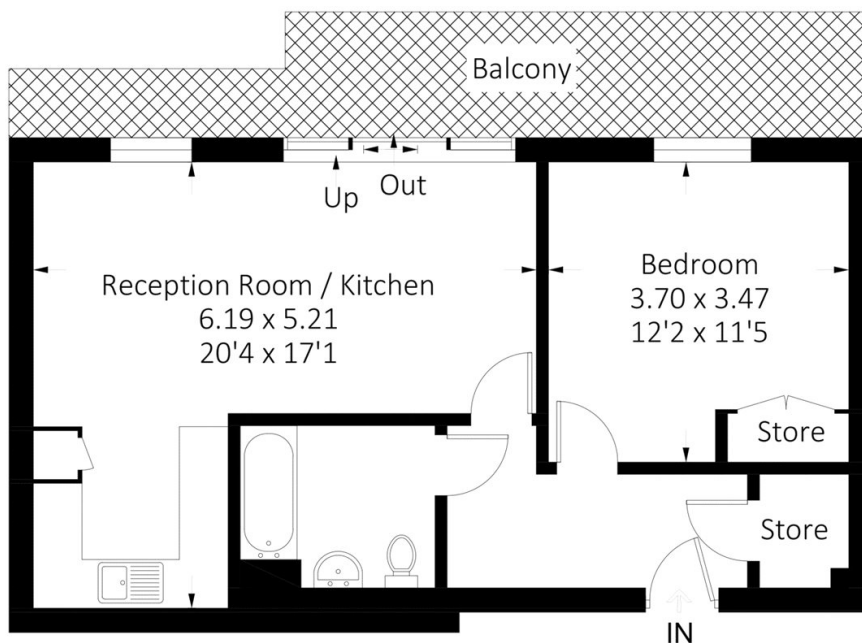

Fifth Floor



Approximate Gross Internal Area = 54.5 sq m / 587 sq ft

Greenwich
020 8815 2230

Energy Rating: C We aim to make our particulars both accurate and reliable. However, they are not guaranteed; nor do they form part of an offer or contract. If you require clarification on any points then please contact us, especially if you're traveling some distance to view. Please note that appliances and heating systems have not been tested and therefore no warranties can be given as to their good working order

MARSH &
PARSONS