

# HARRY CHARLES

Property Specialists

Call us  
01923 731313

INTRODUCING

Melia Close, Watford WD25 9PH

1 Bedroom Apartment - Purpose Built for sale

£225,000

Price



1 Bedrooms/1 Bathrooms EPC Rating: C

- First Floor Modern Apartment
- Open Plan Lounge/Diner/Kitchen
- Family Bathroom
- Approx 102 Year Lease Remaining
- Additional Visitor Parking
- Balcony To Front
- Double Bedroom With Fitted Wardrobe
- Council Tax Band D
- 1 Allocated Parking Space
- Security Intercom Entrance

arla | propertymark

PROTECTED

196 St Albans Road, Watford, Herts WD24 4AS  
Tel: 01923 731313 Email: info@harrycharles.co.uk

 The Property  
Ombudsman  
LETTINGS

# Floor Plan

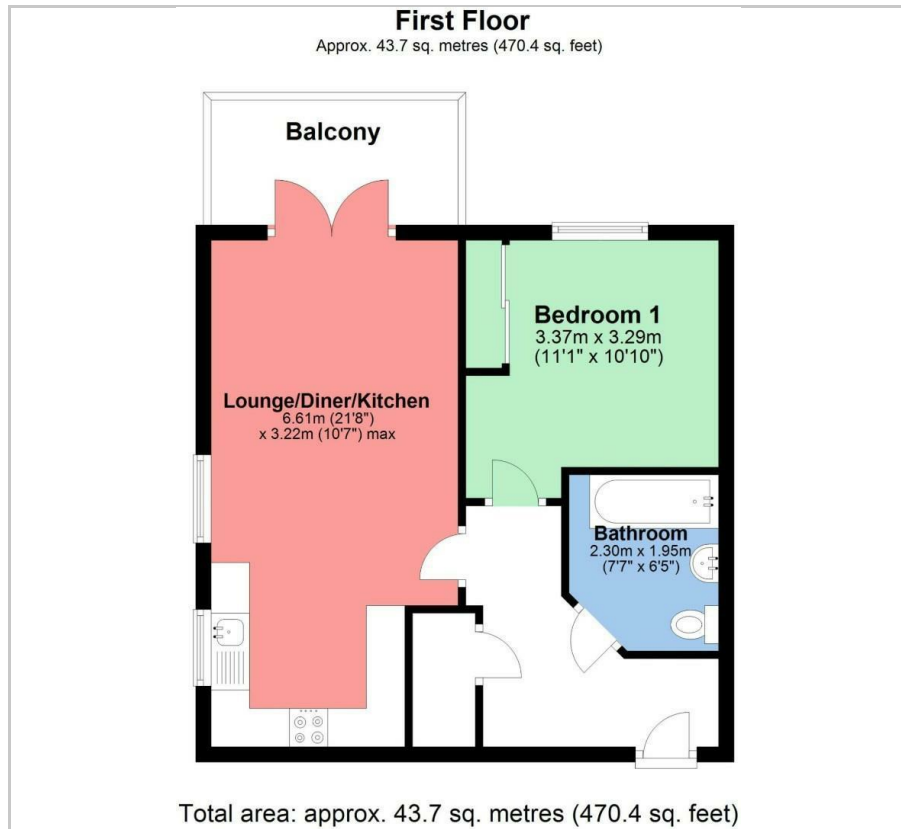

# Map



# Energy Efficiency

Energy Efficiency Rating		Current	Potential
Very energy efficient - lower running costs			
(92 plus) <b>A</b>			
(81-91) <b>B</b>			
(69-80) <b>C</b>		<b>78</b>	<b>78</b>
(55-68) <b>D</b>			
(39-54) <b>E</b>			
(21-38) <b>F</b>			
(1-20) <b>G</b>			
Not energy efficient - higher running costs			
<b>England &amp; Wales</b>		EU Directive 2002/91/EC	

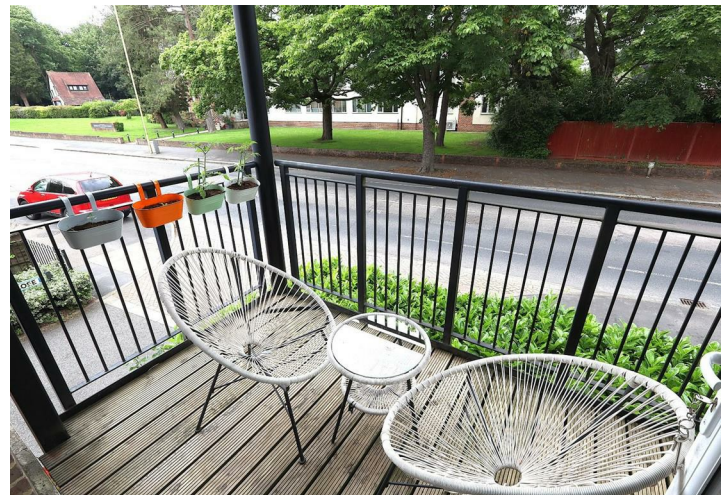

These particulars, whilst believed to be accurate are set out as a general outline only for guidance and do not constitute any part of an offer or contract. Intending purchasers should not rely on them as statements of representation of fact, but must satisfy themselves by inspection or otherwise as to their accuracy. No person in this firm's employment has the authority to make or give any representation or warranty in respect of the property.



196 St Albans Road, Watford, Herts WD24 4AS  
Tel: 01923 731313 Email: info@harrycharles.co.uk

