

ROBERTSON PHILLIPS
Estate Agents, Valuers,
Lettings and Property Management

40 Station Road, North Harrow,
Middlesex, HA2 7SE
Tel: 0208 863 1122

Email: harrow@robertsonphillips.co.uk

Harrow Lettings: 0208 092 4045
Hatch End/Pinner Sales: 0208 428 7161

**ROBERTSON
PHILLIPS**
Est. 1991

CUMBERLAND ROAD, HARROW



Four Bedroom Semi Detached House

£715,000



www.robertsonphillips.co.uk



Description

Robertson Phillips is delighted to present this charming four-bedroom, two-bathroom semi-detached property, ideally located for the modern family. Situated within easy reach of North Harrow's vibrant shopping amenities, highly regarded schools, and the Metropolitan Line station, this home offers both comfort and convenience. The well-proportioned accommodation features a welcoming lounge, a separate dining room, and an impressive extended kitchen/breakfast room—perfect for family gatherings. The ground floor also benefits from a practical guest cloakroom. On the upper floors, you will find four bright bedrooms, including a master suite with its own private en-suite, alongside a contemporary family bathroom. Key Features: Outdoor Living: A delightful 100ft rear garden featuring a dedicated decking area and patio, ideal for outdoor entertaining. Modern Comforts: Fully equipped with gas central heating and double glazing throughout. Prime Location: Just a short walk from North Harrow station and sought-after local schooling. This property represents a fantastic opportunity to secure a spacious home in a premier residential location.





- *Four bedroom semi detached house with parking*
- *Extended to the rear and into the loft*
- *Offered for sale in good order throughout*
- *Gas central heating and double glazed windows*
- *Modern kitchen/diner*
- *Viewing advised*



TENURE. FREEHOLD

LOCAL AUTHORITY. LONDON BOROUGH OF HARROW

ENERGY EFFICIENCY RATING. T/B/A

Ground Floor

Approx. 72.3 sq. metres (778.6 sq. feet)

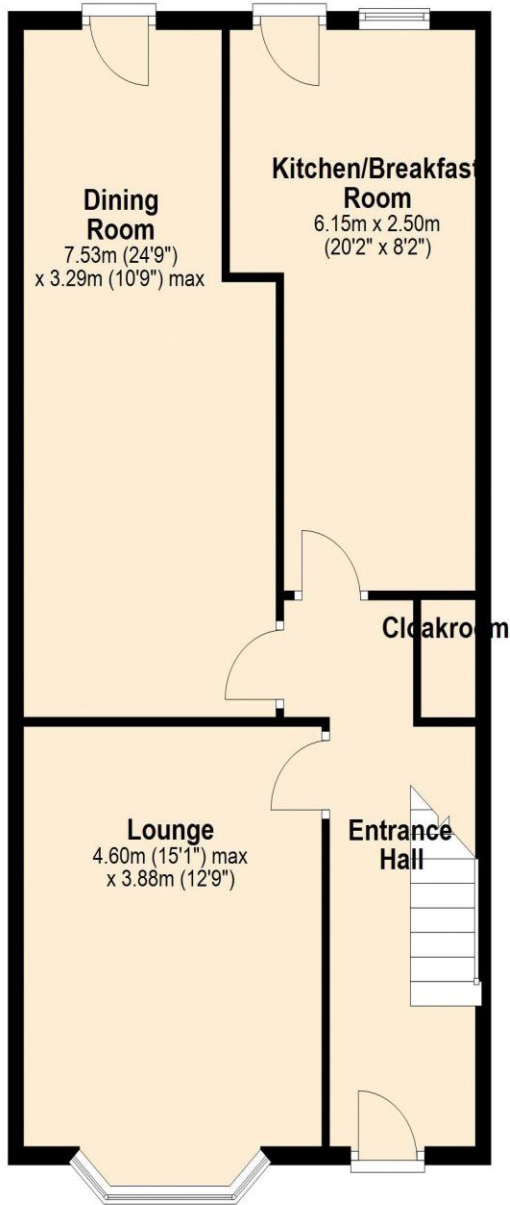

First Floor

Approx. 52.5 sq. metres (565.5 sq. feet)

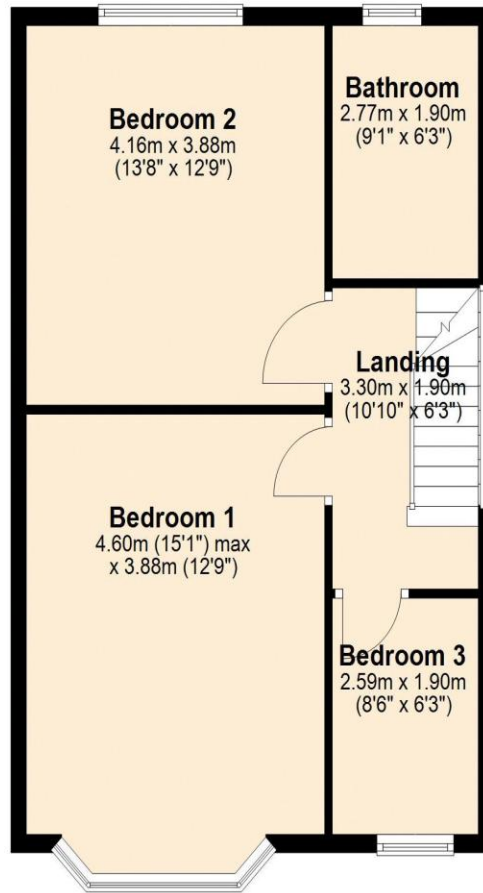

Second Floor

Approx. 30.4 sq. metres (327.5 sq. feet)

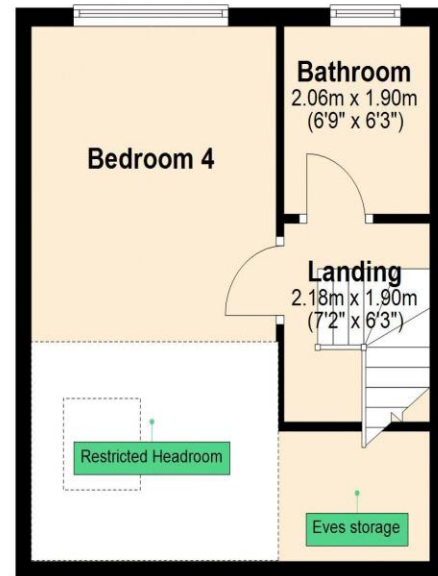

Total area: approx. 155.3 sq. metres (1671.6 sq. feet)



We have not sought to verify the legal title of the property, the existence of planning permissions and/or building regulation approvals and have been unable to check the working condition of any services or appliances.

Property layouts are for general guidance and are not drawn exactly to scale. Measurements are taken at the widest points and bays, alcoves, wardrobes etc. may not be shown.