



OLDCOTES, NOTTINGHAMSHIRE
44.52 Acres (18.02 Hectares) or thereabouts



OLDCOTES NOTTINGHAMSHIRE

PRODUCTIVE GRADE 2 ARABLE LAND

44.52 Acres (18.02 Hectares) or thereabouts
(Blyth 3 miles, Bawtry 5 miles)

FOR SALE AS A WHOLE

BY PRIVATE TREATY



Location

The land is situated to the north of the B6463 Styrrup to Oldcotes Road and to the north east of Oldcotes in Nottinghamshire. The city of Doncaster lies approximately eleven miles to the north and the town of Worksop lies approximately nine miles to the south.

Selling Agents

DDM Agriculture
2 Doncaster Road, Bawtry
DN10 6NF

Tel: 01302 714399

Ref: Andrew Houlden

E-mail: andrew.houlden@ddmagriculture.co.uk



the mark of
property
professionalism
worldwide



General Remarks and Stipulations

The Land

The land comprises a block of easy working arable land split into two separate fields, both of which are of a reasonably regular shape. It extends to 44.52 acres (18.02 hectares) and is offered for sale as a whole.

The land is classified as being Grade 2 on Sheet 103 of the Provisional Agricultural Land Classification Maps of England and Wales as historically published by the Ministry of Agriculture, Fisheries and Food.

The Soil Survey of England and Wales identifies the soils as being from the "Aberford 1" Association with their characteristics described as "well drained calcareous fine loamy soils over limestone" and as suitable for "cereals with some sugar beet and potatoes".

Basic Payment Scheme

The land is registered on the Rural Payments Agency Rural Land Register and was used to activate entitlements under the Basic Payment Scheme.

A copy of the relevant LPIS maps for the land are available for inspection at the Selling Agent's office by prior appointment or can be e-mailed out on request. Purchaser(s) should satisfy themselves as to the accuracy of the same. Any statement made within these sales particulars is given in good faith but carries no warranty.

Schedule & Back Cropping

A schedule of the land with back cropping for the last five years is available on request from the Selling Agent's Offices.

Tenure and Possession

The land is sold freehold with the benefit of vacant possession upon completion.

Early Entry

Early entry onto the land will be possible, subject to the payment of a 20% deposit and following an exchange of contracts.

Outgoings

Isle of Axholme and North Nottinghamshire Water Level Management Board	
Assessable Area:	13.474 acres
Annual Value:	£536
2025/2026 drainage rates payable	£84.74

Nitrate Vulnerable Zone

The land all lies within a designated Nitrate Vulnerable Zone. For further details visit www.defra.gov.uk

Easements, Wayleaves & Rights of Way

There are wayleave agreements with National Grid Electricity Distribution (East Midlands) plc for the overhead lines that cross both Lots.

The land is sold subject to all rights of way, reservation of minerals, water, drainage, other easements and wayleaves and all rights of access whether mentioned in these particulars or not.

Tenantright

There will be no tenantright payable not will there be any consideration or allowance made whatsoever for dilapidations or any deductions of any kind.

Sporting/Timber Rights/Minerals

Sporting, timber and mineral rights are included in the sale of this land, insofar as they are owned.

Value Added Tax (VAT)

The sale price is agreed on a VAT exclusive basis and the Purchaser(s) shall indemnify the Vendor for any VAT which may subsequently be payable.

Viewing

The land may be viewed at any reasonable time during daylight hours in possession of a set of these sales particulars.

Method of Sale

The property is offered for sale by private treaty. Interested parties are invited to speak to Andrew Houlden of the Selling Agents on 01302 714399 to discuss their interest.



SITE PLAN

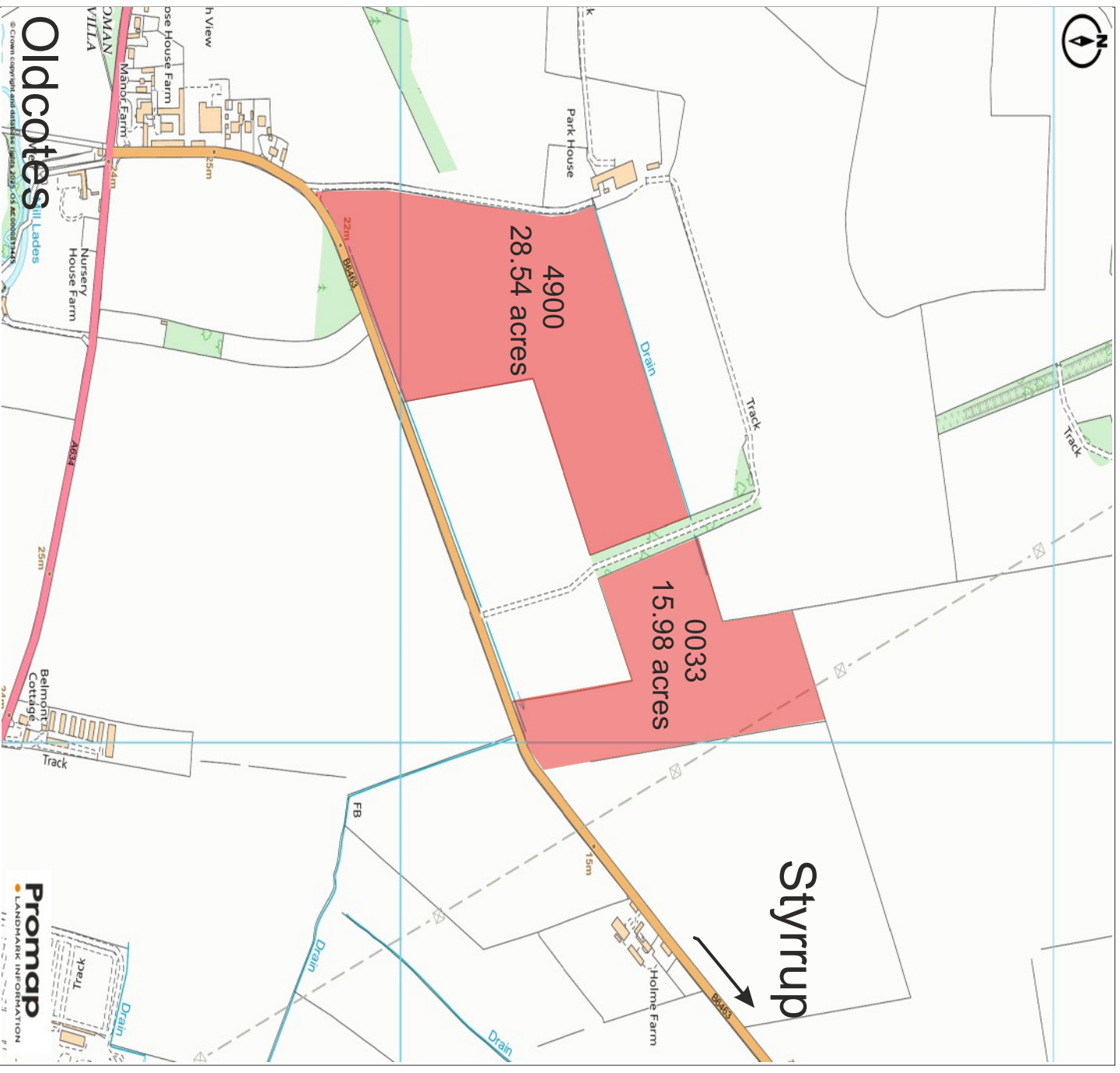

FOR IDENTIFICATION PURPOSES ONLY

Important Notice

- DDM Agriculture for themselves and the Owner of this property, whose agents they are, give notice that:
- (i) These particulars have been prepared in good faith to give a fair overall view of the property, do not form any part of an offer or contract, and must not be relied upon as statements or representations of fact.
 - (ii) The purchaser(s) must rely on their own enquiries by inspection or otherwise on all matters.
 - (iii) The information in these particulars is given without responsibility on the part of DDM Agriculture nor their clients. Neither DDM Agriculture nor their employees have any authority to make or give any representation or warranties whatsoever in relation to this property.
 - (iv) Any areas and/or measurements or distances referred to are given as a guide and are not precise