



**8 Peterhead Mews Grampian Way, Langley, Slough, SL3 8UH**  
**£349,950**

 **HORLER**

## 8 Peterhead Mews Grampian Way, Langley, Slough, SL3 8UH

Welcome to this beautifully presented two-bedroom ground floor maisonette, located on Grampian Way in the vibrant area of Langley, Slough. This delightful property is ideally situated close to local amenities and excellent transport links, making it a perfect choice for both families and professionals.

This maisonette presents an excellent opportunity for those seeking a comfortable and modern living space in a desirable location. Don't miss the chance to make this charming property your new home.

Call 01753 621234 to arrange a viewing



## Property Summary

Welcome to this beautifully presented two-bedroom ground floor maisonette, located on Grampian Way in the vibrant area of Langley, Slough. This delightful property is ideally situated close to local amenities and excellent transport links, making it a perfect choice for both families and professionals.

There is a spacious open plan living room that boasts an abundance of natural light, thanks to the French doors that lead directly to a secluded private rear garden. This outdoor space features a large patio area, perfect for al fresco dining or simply enjoying a quiet moment in the sun.

The kitchen/diner is well-equipped with a range of eye and base level units, appliances, and a complementary work surface, providing a functional and stylish space for cooking and entertaining. The maisonette comprises two generously sized double bedrooms, ensuring ample space for relaxation and rest. A family bathroom and a convenient store cupboard complete the interior layout.

To the front of the property, you will find a paved driveway that offers off-road parking for two cars, along with a side access gate for added convenience. This maisonette presents an excellent opportunity for those seeking a comfortable and modern living space in a desirable location. Don't miss the chance to make this charming property your new home.

## General Information

Council Tax Band 'C'

Lease Information 125 years from 2003 - 102 years remaining

Service Charge £1550 pa

Ground Rent £10 pa

## Legal Note

\*\*\*Although these particulars are thought to be materially correct their accuracy cannot be guaranteed and they do not form part of any contract\*\*\*





# Peterhead Mews SL

Approximate Gross Internal Floor Area = 72.2 sq m / 778 sq ft

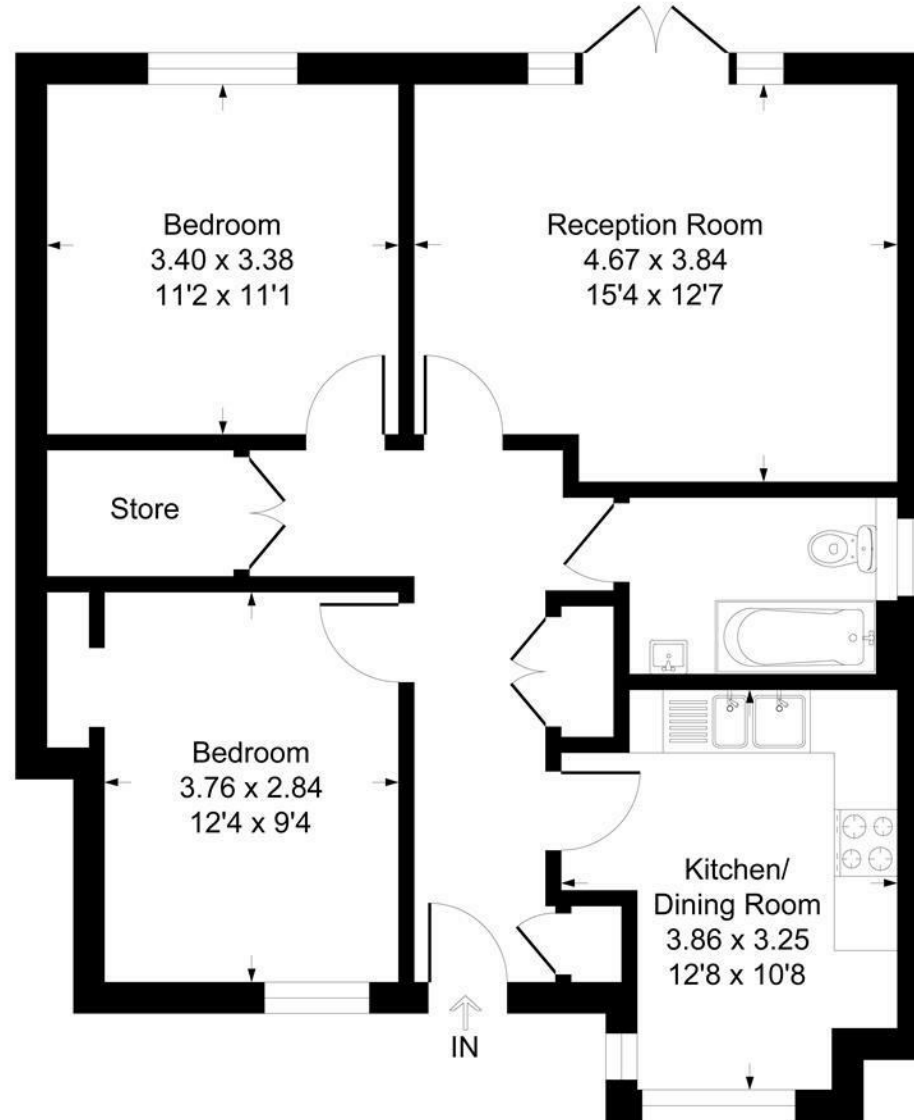

Illustration for identification purposes only, measurements are approximate, not to scale.  
Produced By Esjay Property Marketing