

Addington Road Irthlingborough

richard james

www.richardjames.net

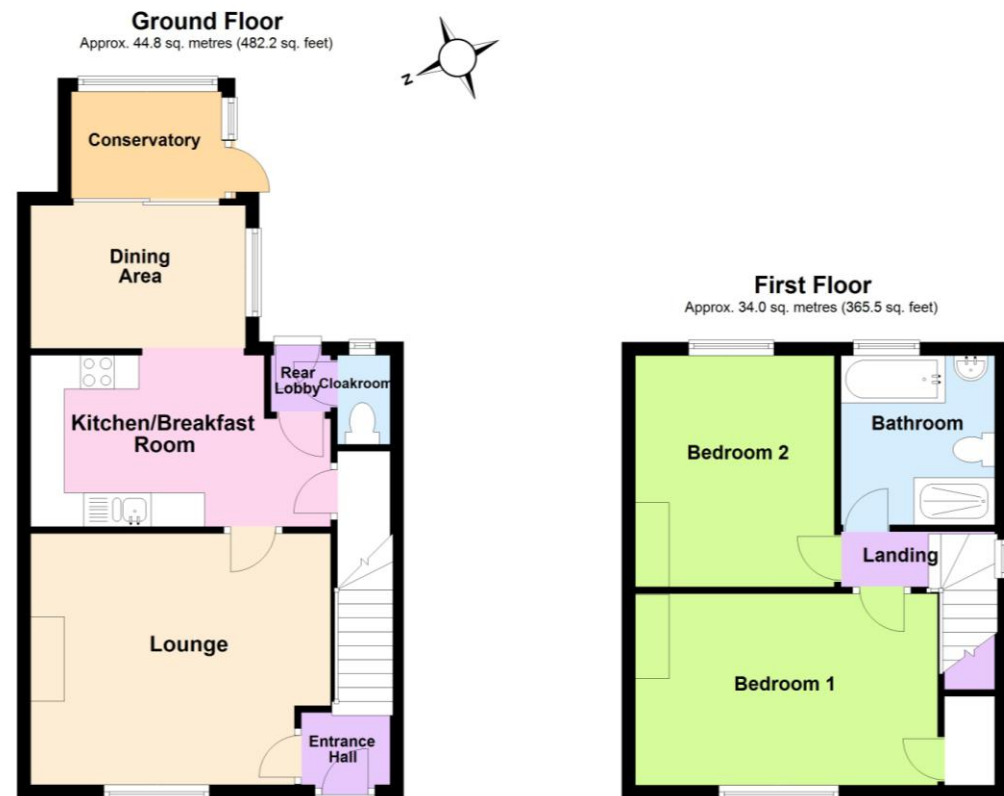

Total area: approx. 78.8 sq. metres (847.8 sq. feet)



This plan is a guide only to represent the layout of the property and is not totally to scale. The bathroom fittings and kitchen units may vary in shape and size.



Addington Road Irthlingborough NN9 5UT
Freehold Price 'Offers In Excess Of' £200,000

The information given in these particulars is intended to help you decide whether you wish to view this property and to avoid wasting your time in viewing unsuitable properties. We have tried to make sure that these particulars are accurate, but to a large extent we have to rely on what the seller tells us about the property. We do not check every single piece of information ourselves as the cost of doing so would be prohibitive and we do not wish to unnecessarily add to the cost of moving house. Once you find the property you want to buy, you will need to carry out more investigations into the property than it is practical or reasonable for an estate agent to do when preparing sales particulars. For example, we have not carried out any kind of survey of the property to look for structural defects and would advise any homebuyer to obtain a surveyor's report before exchanging contracts. If you do not have your own surveyor, we would be pleased to recommend one. We have not checked whether any equipment in the property (such as central heating) is in working order and would advise homebuyers to check this. You should also instruct a solicitor to investigate all legal matters relating to the property (e.g. title, planning permission etc) as these are specialist matters in which estate agents are not qualified. Your solicitor will also agree with the seller what items (e.g. carpets, curtains etc) will be included in the sale.

Wellingborough Office
27 Sheep Street Wellingborough
Northants NN8 1BS
01933 224400

Irthlingborough Office
28 High Street Irthlingborough
Northants NN9 5TN
01933 651010

Rushden Office
74 High Street Rushden
Northants NN10 0PQ
01933 480480



Situated on the northern outskirts of Irthlingborough is this mature two bedroomed end of terraced property featuring a single storey extension and conservatory to the rear and rear vehicular access providing gated off road parking for three cars. Benefits include uPVC double glazing, gas radiator central heating, modern kitchen with built in appliances, modern bathroom and offers two double bedrooms and no upward chain. The accommodation briefly comprises entrance hall, lounge, kitchen/dining room, conservatory, cloakroom, landing, two bedrooms, bathroom, front and rear gardens and a driveway.

Entry via part-glazed front door through to:

Entrance Hall

Stairs rising to first floor landing, radiator, door through to:

Lounge

12' 3" x 14' 7" max (3.73m x 4.44m)

Window to front aspect, radiator, TV point, living flame gas fire with feature surround and raised hearth, display niche with wall light points, coving to ceiling, glazed door through to:

Kitchen

14' 7" x 8' 3" max (4.44m x 2.51m)

Modern fitted kitchen comprising one and half bowl ceramic single drainer sink unit with cupboard under, a range of eye and base level units providing work surfaces and tiled splash backs, integrated double oven, electric hob, extractor, laminate flooring, coving to ceiling, under stairs storage cupboard with light and window to side aspect, glazed door through to:

Rear Lobby

Part glazed door to rear, tiled floor, door to:

Cloakroom

Comprising low flush W.C, tiled flooring, tiled splash backs, window to rear aspect, coving to ceiling.

Dining Room

10' 5" x 7' 0" (3.18m x 2.13m)

Window to side aspect, radiator, laminate flooring, coving to ceiling, TV point, sliding patio door through to:

Conservatory

5' 2" x 7' 3" (1.57m x 2.21m)

Of brick/uPVC construction with Perspex roof, door to garden.

First Floor Landing

Window to side aspect, loft access with ladder, doors to:

Bedroom One

14' 8" x 9' 5" (4.47m x 2.87m)

Window to front aspect, picture rail, radiator, cupboard housing wall mounted gas boiler serving domestic hot water and central heating systems with fitted shelving, TV point.

Bedroom Two

11' 4" x 9' 8" (3.45m x 2.95m)

Window to rear aspect, radiator, picture rail.

Bathroom

7' 6" x 8' 3" (2.29m x 2.51m)

Fitted to comprise low flush W.C, vanity sink with cupboard under, panelled bath, double shower cubicle, tiled splash backs, tiled walls, chrome towel rail, window to rear aspect, shaver point with light, vinyl flooring.

Outside

Front - Mainly lawn with borders stocked with flowers and shrubs, enclosed by privet hedge and wooden panelled fencing.

Rear - Main lawn with border stocked with flowers and shrubs, greenhouse, large wooden shed, gated side pedestrian access, garden is enclosed by wooden panelled fencing. Driveway via wooden double gates through to blocked paved driveway providing off-road parking for up to 3 cars.

Material Information The tenure of this property is freehold.

Energy Performance Rating

This property has an energy rating of D. The full Energy Performance Certificate is available upon request.

Council Tax

We understand the council tax is band A (£1,623 per annum. Charges for 2025/26).

Agents Note

Please be aware that some photographs used in our particulars are obtained using a wide-angle lens.

Conveyancing

We are able to offer a free quotation for your conveyancing from a panel of local solicitors or licensed conveyancers.

Offers

For offers to be submitted in the best light, the majority of vendors require us to confirm buyers have been financially qualified. We will require a Mortgage Certificate or Agreement In Principle (A.I.P.) and proof of deposit or cash. This information will be treated confidentially and will not be seen by any other party. We are obliged by law to pass on all offers to the vendors until contracts have been exchanged.

Money Laundering Regulations 2017 & Proceeds of Crime Act 2002

In order to comply with the above Regulations, an intending purchaser will be required to provide official I.D; proof of address, evidence of funding and source of deposit clearly showing the name of the account holder. If funds are being provided by a third party i.e. family, we will require the same from them too. We will verify clients identity electronically from the details provided. The information will be checked against various databases. This is not a credit check of any kind and does not affect credit history. We will retain a record on file.

General Data Protection Regulations 2018

Should you view or offer on this property, we will require certain pieces of personal information in order to provide a professional service to you and our client.

The personal information provided by you may be shared with the seller, but it will not be shared with any other third parties without your consent.

More information on how we hold and process your data is available on our website - www.richardjames.net

Mortgages

We are able to offer our clients mortgage advice through our association with an independent mortgage advisor. Written quotations are available on request. A life policy may be required.

YOUR HOME MAY BE REPOSSESSED IF YOU DO NOT KEEP UP REPAYMENTS ON YOUR MORTGAGE.

