



P U T T E R I L L S
— est. 1992 —

Walsworth Road, Hitchin, SG4 9SX
Guide Price: £500,000
Freehold

PROPERTY SUMMARY

Spacious, chain-free three-bedroom, two-bathroom home on the popular Walsworth Road in Hitchin, blending character features with modern living. Highlights include a modern open-plan kitchen/breakfast room, two flexible reception rooms, and a ground-floor WC. The first floor offers two generous bedrooms and a stylish family bathroom, while the principal bedroom with en-suite occupies the top floor. Outside is a low-maintenance courtyard garden. Ideally located just 0.2 miles from Hitchin station and a short walk to the town centre, making it perfect for commuters, families, or investors.

3



2



2















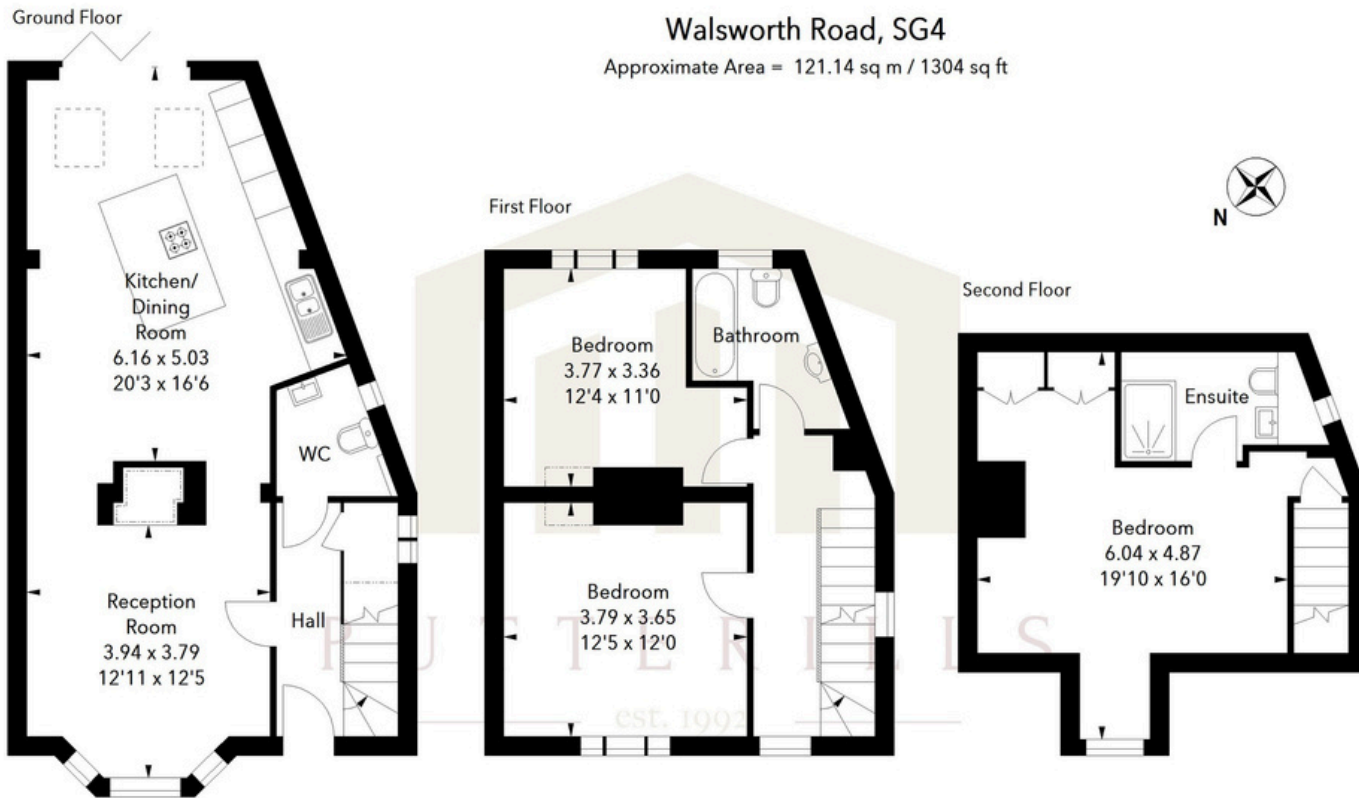

Illustration For Identification Purposes Only.
All measurements and areas are approximate, not to scale.
© Orange Tree Photography

LOCAL AUTHORITY
North Herts

TENURE
Freehold

COUNCIL TAX BAND
D

VIEWINGS
By prior appointment only

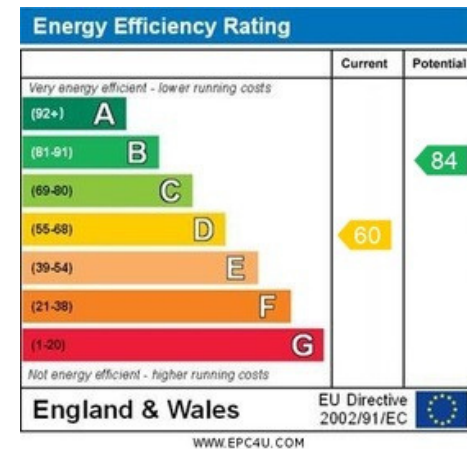

Agents Note: Whilst every care has been taken to prepare these particulars, they are for guidance purposes only. All measurements are approximate and are for general guidance purposes only and whilst every care has been taken to ensure their accuracy, they should not be relied upon and potential buyers/tenants are advised to recheck the measurements



OFFICE ADDRESS
Putterills Hitchin
60 Hermitage Road
Hitchin
SG5 1DB

CONTACT DETAILS

01462 632222
hitchin@putterills.co.uk
www.putterills.co.uk