



Bath Road

Bournemouth, BH1

1 Bedroom £995 pcm + Security Deposit



**Homes
& Steeple**

8 Jacey House Bath Road

Description

- Modern Town Centre Apartment
- Lounge diner
- Council Tax Band A
- Gas Central Heating
- Large bedroom
- Family bathroom + Shower
- White Goods
- Unfurnished

This large one bedroom apartment is located on the third floor of a character conversion and is set on the Lansdowne roundabout in the town centre. It is available to rent from the start of November, unfortunately there is no allocated parking with the property.

The property further benefits from Gas Central heating and Double Glazing. It is only moments away from a host of bars, shops and restaurants along with the BH2 Leisure Complex, Bournemouth International Centre and Pavilion. The award winning sandy beaches and seafront are only a short walk through the beautiful central gardens offering miles of stunning sandy beaches and views across to the Isle of Wight to Old Harrys Rock.



Accommodation Comprises:

Kitchen

Living/Dining Room



Bedroom

Bathroom



| Energy Efficiency Rating | | Environmental Impact (CO ₂) Rating | |
|---|-------------------------|--|----|
| | Current | Potential | |
| <i>Very energy efficient - lower running costs</i> | | | |
| (92-100) A | | | |
| (81-91) B | | | |
| (69-80) C | 72 | 78 | |
| (55-68) D | | | |
| (39-54) E | | | |
| (21-38) F | | | |
| (1-20) G | | | |
| <i>Not energy efficient - higher running costs</i> | | | |
| England | EU Directive 2002/91/EC | | |
| <i>Very environmentally friendly - lower CO₂ emissions</i> | | | |
| (92-100) A | | | |
| (81-91) B | | | 81 |
| (69-80) C | 71 | | |
| (55-68) D | | | |
| (39-54) E | | | |
| (21-38) F | | | |
| (1-20) G | | | |
| <i>Not environmentally friendly - higher CO₂ emissions</i> | | | |
| England | EU Directive 2002/91/EC | | |

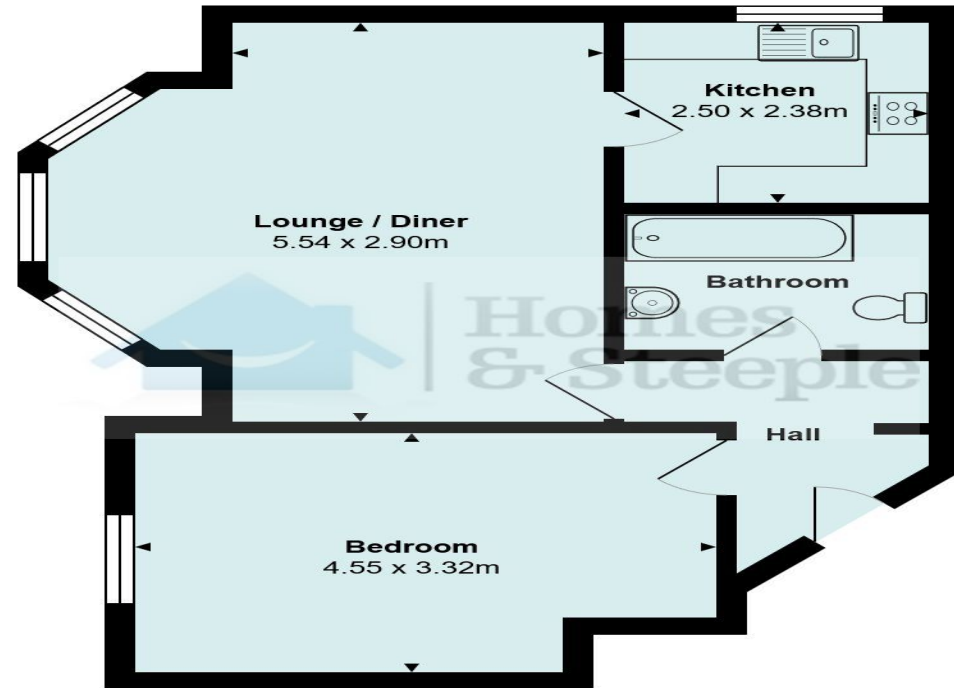

Homes & Steeple

30 The Triangle, Bournemouth
Dorset, BH2 5SE

telephone : 01202 553 898

email : lettings@homesandsteeple.co.uk

www.homesandsteeple.co.uk

THE PROPERTY MISDESCRIPTIONS ACT 1991: Any areas, measurements or distances are approximate. Land measurements are provided by the vendor and buyers are advised to obtain verification from their solicitor. The text, photographs and plans are for guidance only and are not necessarily comprehensive. Items shown in the property photographs are not included unless specifically mentioned within the sales particulars although they may be available by separate negotiation. Homes & Steeple Ltd cannot verify that the fixtures and fittings, equipment or services are in working order or fit for the purpose and buyers are advised to obtain verification from their solicitor. The tenure of a property is based upon information supplied by the seller and buyers are advised to obtain verification from their solicitor.