



## 21 Ashwell Street, Netherfield - NG4 2FQ

Guide Price £250,000 - £260,000





## 21 Ashwell Street

Netherfield, Nottingham

GUIDE PRICE £250,000–£260,000 Charming 3-storey mid-terrace home offered with no chain! Convenient location, 4 versatile bedrooms and 2 reception rooms. Viewing recommended! Council Tax band: A

Tenure: Freehold

EPC Energy Efficiency Rating: D

EPC Environmental Impact Rating: D

- Charming three-storey mid-terrace house
- Offered to the market with no upward chain
- Excellent amenities and transport links close by
- Entrance hall with traditional style flooring
- Two characterful reception rooms
- Modern kitchen with ample storage
- Four bedrooms (three doubles and a versatile fourth bedroom/dressing room)
- Bathroom/WC with white suite and mains shower
- Low-maintenance and south-easterly facing rear garden with decking area
- Viewing highly recommended











### Ground Floor

Approx. 51.1 sq. metres (550.1 sq. feet)

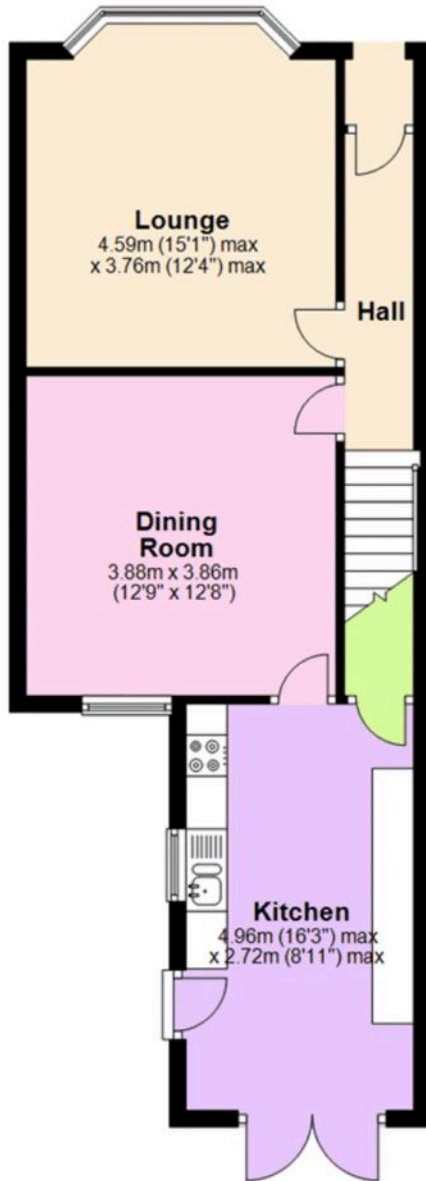

### First Floor

Approx. 50.4 sq. metres (543.0 sq. feet)

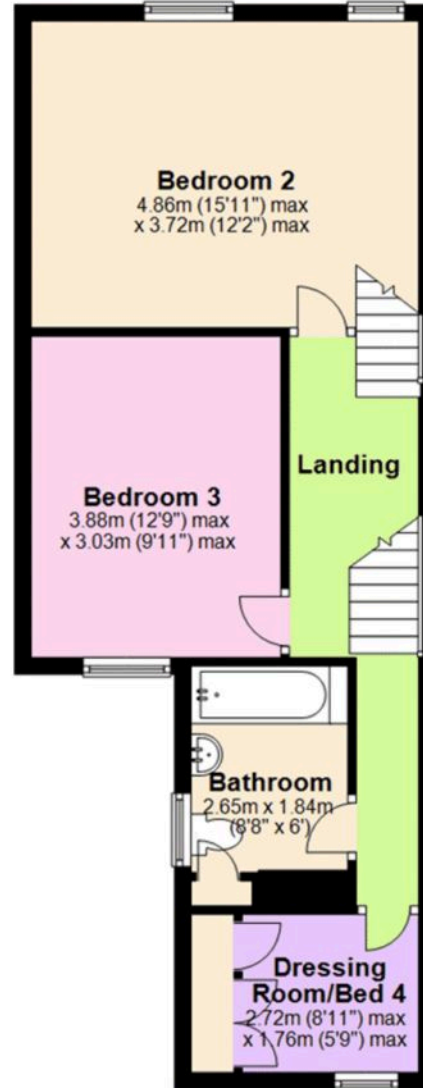

### Second Floor

Approx. 23.9 sq. metres (257.3 sq. feet)

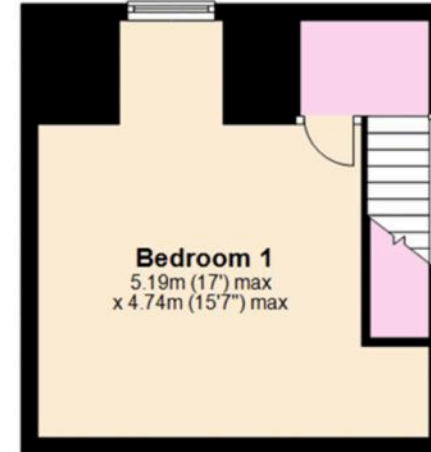

Total area: approx. 125.5 sq. metres (1350.4 sq. feet)





## David James Estate Agents

376 Carlton Hill, Carlton - NG4 1JA

0115 987 8957 • [carlton@david-james.com](mailto:carlton@david-james.com) • [www.david-james.com](http://www.david-james.com)

These particulars are produced in good faith and are set out as a general guide only. Measurements are approximate and floor plans are for illustrative purposes only. Services have not been tested. We have established professional relationships with third-party suppliers for the provision of services to Clients, details of which can be found on the property listing page on our website.