



Connells
connells.co.uk 0203 00 00 00
FOR SALE

Connells

Owen Drive
Fair Oak Eastleigh



Property Description

This spacious and modern two-bedroom end of terrace home is beautifully presented throughout and ideally situated in the highly sought-after location of Fair Oak. The immaculate front garden immediately sets the tone for this charming and well-maintained property.

Upon entering, the welcoming hallway leads to a convenient downstairs cloakroom, a bright and comfortable lounge to the front aspect, and a stunning open-plan kitchen/diner to the rear.

The contemporary kitchen benefits from integral appliances and French doors opening onto the rear garden, creating the perfect space for both everyday living and entertaining.

Upstairs, the property offers two generous double bedrooms, with the principal bedroom enjoying the added luxury of an en-suite shower room, alongside a modern family bathroom.

Externally, the rear garden features a patio seating area, lawn, shed and rear access, while the property further benefits from two allocated parking spaces.

Located in the ever-popular Fair Oak, this desirable home is within easy reach of local amenities, schools and excellent transport links, making it an ideal purchase for first-time buyers, professionals or those looking to downsize.

A truly beautiful home that must be viewed to be fully appreciated.

Cloakroom

Toilet. Extractor fan. Wash hand basin. Radiator.

Lounge

Double glazed window to front aspect. Radiator.

Kitchen

Double glazed window to rear aspect. French doors to rear aspect. Integrated white goods. Gas hob. Under stairs storage. Tiled flooring

Landing

Storage cupboard. Loft hatch.

Bedroom 1

Double glazed window to rear aspect.
Radiator.

En-Suite

Walk in shower. Toilet. Wash hand basin.
Heated towel rail. Extractor fan.

Bedroom 2

Double glazed window to front aspect.
Radiator. Storage cupboard.

Bathroom

Bath. Wash hand basin. Toilet. Heated towel
rail. Extractor fan.

Outside

Two allocated parking spaces.
Rear garden combines patio, lawn and flower
beds with rear access.



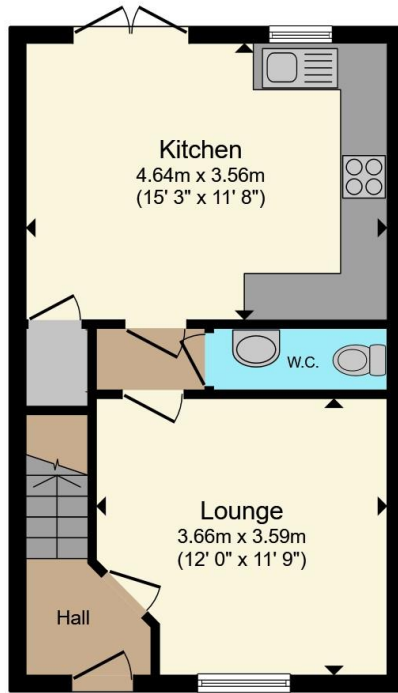

Ground Floor

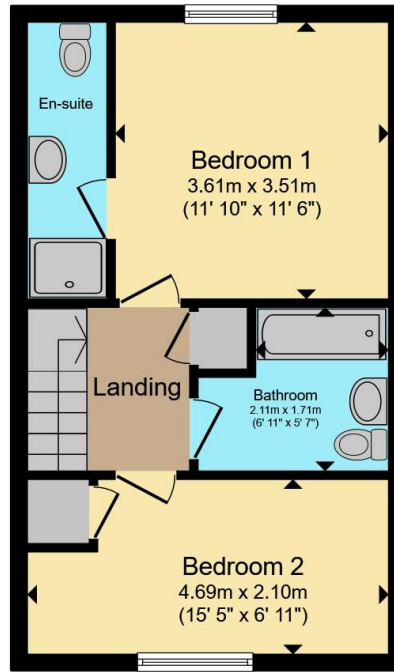

First Floor

Total floor area 75.4 m² (811 sq.ft.) approx

This floor plan is for illustrative purposes only. It is not drawn to scale. Any measurements, floor areas (including any total floor area), openings and orientation are approximate. No details are guaranteed, they cannot be relied upon for any purpose and they do not form part of any agreement. No liability is taken for any error, omission or misstatement. A party must rely upon its own inspection(s). Powered by www.propertybox.io



To view this property please contact Connells on

T 02380 618 343
E eastleigh@connells.co.uk

19 Market Street
EASTLEIGH SO50 5RH

EPC Rating: B Council Tax
Band: C

view this property online connells.co.uk/Property/EGH309662

Tenure: Freehold



1. MONEY LAUNDERING REGULATIONS Intending purchasers will be asked to produce identification documentation at a later stage and we would ask for your co-operation in order that there will be no delay in agreeing the sale. 2. These particulars do not constitute part or all of an offer or contract. 3. The measurements indicated are supplied for guidance only and as such must be considered incorrect. Potential buyers are advised to recheck measurements before committing to any expense. 4. We have not tested any apparatus, equipment, fixtures, fittings or services and it is in the buyers interest to check the working condition of any appliances.

Connells Residential is registered in England and Wales under company number 1489613, Registered Office is Cumbria House, 16-20 Hockliffe Street, Leighton Buzzard, Bedfordshire, LU7 1GN. VAT Registration Number is 500 2481 05.

See all our properties at www.connells.co.uk | www.rightmove.co.uk | www.zoopla.co.uk

Property Ref: EGH309662 - 0002