

33 Remus Avenue  
Heddon-On-The-Wall  
Newcastle Upon Tyne  
NE15 0BT

Price Guide  
£300,000



33 Remus Avenue  
Heddon-On-The-Wall  
Newcastle Upon Tyne  
NE15 0BT

- 3 Bedroomed Semi Detached Bungalow
- 22' Lounge with Feature Fireplace & Panoramic Views
- Shower/WC
- Well Stocked Gardens
- Solar Panels & Security Blinds
- Well Presented & Appointed
- Refitted Kitchen
- Garage with Electric Door
- Desirable Village
- Fabulous Opportunity





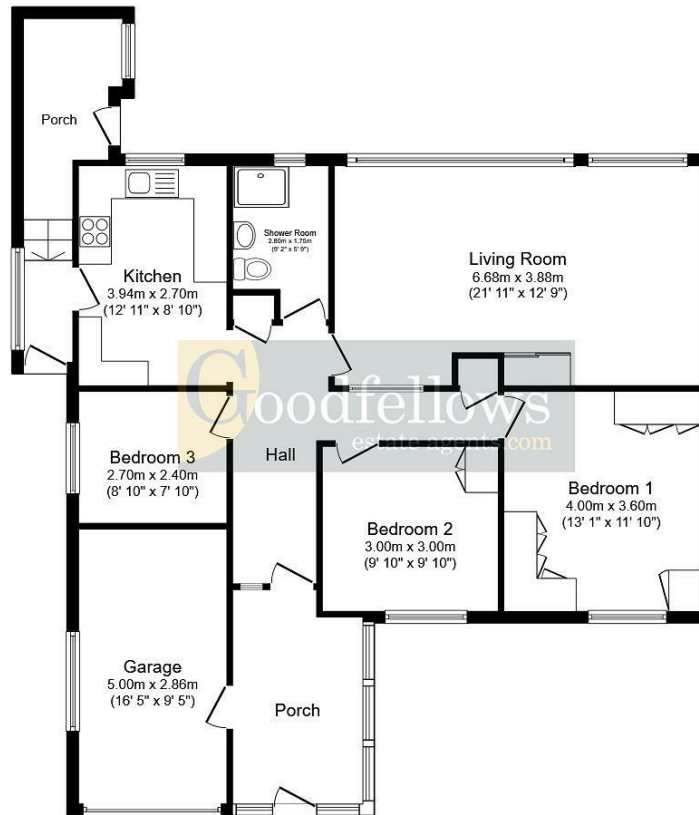

Floor Plan

Total floor area: 117.9 sq.m. (1,269 sq.ft.)

This floor plan is for illustrative purposes only. It is not drawn to scale. Any measurements, floor areas (including any total floor area), openings and orientations are approximate. No details are guaranteed, they cannot be relied upon for any purpose and do not form any part of any agreement. No liability is taken for any error, omission or misstatement. A party must rely upon its own inspection(s).



EPC Rating: C  
Council Tax Band: C

Whilst every care has been taken to prepare these particulars, they are for guidance purposes only. All measurements are approximate and whilst every care has been taken to ensure their accuracy, they should not be relied upon and potential buyers/tenants are advised to recheck the measurements. The agent has not tested any equipment, services, fixtures or fittings and makes no representation regarding their condition.

CONTACT

11 West Road, Ponteland,  
Northumberland, NE20 9SU

E: [ponteland@goodfellowsestateagents.com](mailto:ponteland@goodfellowsestateagents.com)  
T: 01661 829164

