



Princes Avenue

London, N3 2DF

£2,500 Per Month



This Bright and Spacious three double bedroom three bathroom Apartment located above the shops in Ballards Lane, Finchley Central. The apartment is within close walking distance to Finchley Central Northern Line Tube Station, local shops & Major road links.

The apartment comprises of a Large open plan fitted kitchen with appliances, dining area and lounge, three double bedrooms, two en-suites and a family bathroom. The property has recently been redecorated neutrally throughout. Available Now





Area Map



Floor Plans

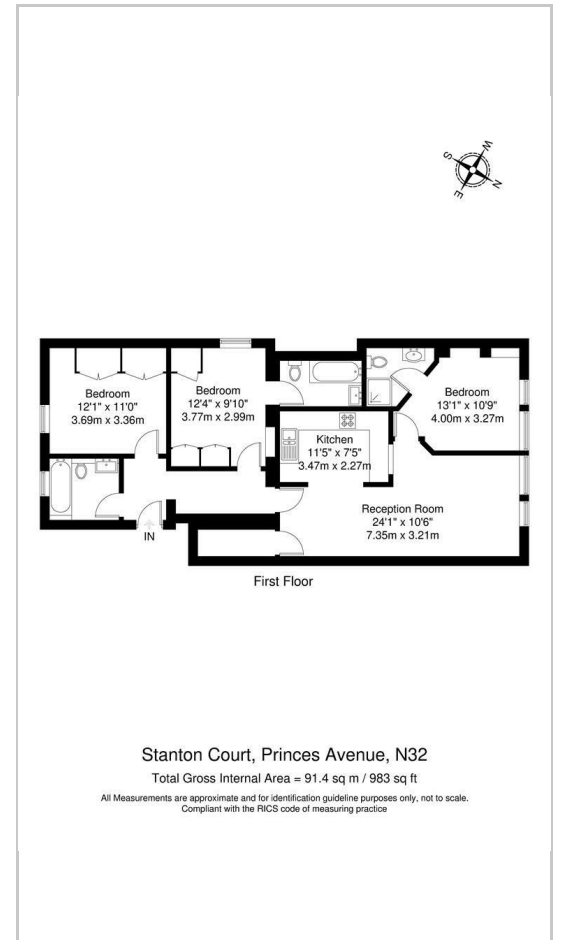

Energy Efficiency Graph

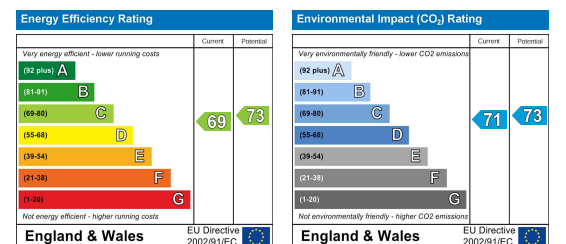

These particulars, whilst believed to be accurate are set out as a general outline only for guidance and do not constitute any part of an offer or contract. Intending purchasers should not rely on them as statements of representation of fact, but must satisfy themselves by inspection or otherwise as to their accuracy. No person in this firm's employment has the authority to make or give any representation or warranty in respect of the property.