

LANES

SALES & LETTINGS

*Joanna Bufton
Lettings Consultant***LANES**

SALES & LETTINGS

*Tel: 01908 508037**Email: Joanna@lanesmk.co.uk*

13 Sandown Court, Bletchley, Milton Keynes, Buckinghamshire, MK3 5LZ

Lanes offer this spacious 4 Bedroom Semi-Detached House, within Bletchley, comprising Fitted Kitchen/Breakfast Room, Family Bathroom, 4 Double Bedrooms, 3 with En-Suite Bathrooms, 2 Studies, Conservatory and Cloakroom. The property also offers a Rear Garden with large Pizza Oven and Entertaining Area and 2 Off Road, Allocated Parking Spaces. Please see our Floor plans for better appreciation of the layout. Additional per month for £600 for utilities which include Gas, Electricity, Water and Council Tax. Available early June 2026

- Semi Detached House
- Conservatory
- Allocated Parking
- Available NOW
- Four Double Bedrooms
- £250 Utilities, gas, electricity, water and council tax
- Part Furnished
- Three En-Suites
- Outside Entertaining space
- Professionals Only

£1,650 Per Month

13 Sandown Court, Bletchley, Milton Keynes, Buckinghamshire, MK3 5LZ
 15557077
 £1,650 Per Month

Ground Floor

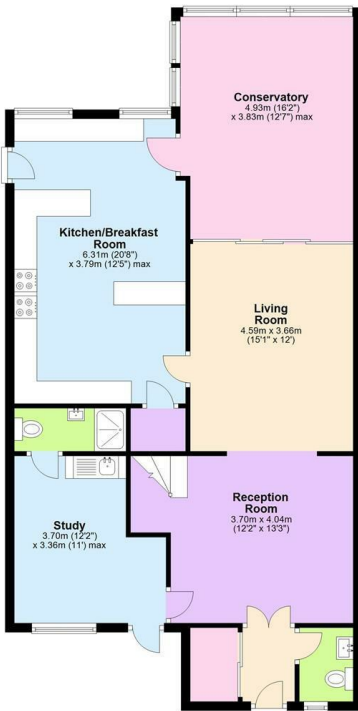

First Floor



Ground Floor

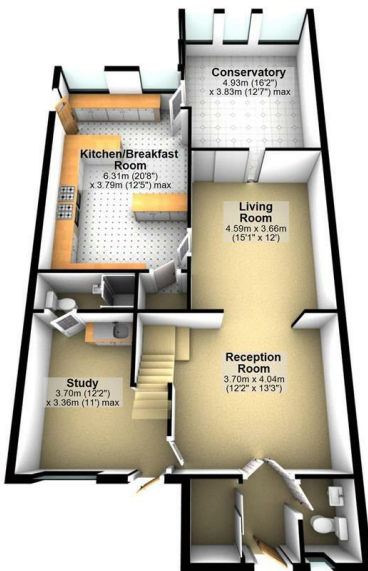

First Floor



Energy Efficiency Rating

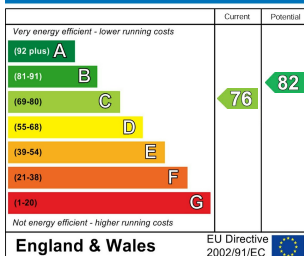

Environmental Impact (CO₂) Rating

