



STEPHENSON BROWNE

**Booth Street, Congleton**

CW12 4DG



**£165,000**

## Description

This beautifully presented two-bedroom end terrace has been fully renovated over the last two years by the current owner, creating a modern, move-in ready home that still retains a touch of character. With solar panels enhancing energy efficiency, this property is ideal for first-time buyers, investors, or downsizers looking for a stylish home in a sought-after location.

Situated on the edge of Congleton Town Centre, the location is hard to beat. A short walk takes you into the heart of town, offering a variety of shops, restaurants, and bars. Additional conveniences such as Tesco Extra, Shell Garage, and Astbury Mere Country Park are all nearby.

Upon entering, you are greeted by a welcoming lounge/dining area featuring beautiful herringbone flooring that extends into the kitchen, alongside a decorative cast iron feature fireplace. The modern kitchen is fitted with integrated appliances and offers space for a washer/dryer, complemented by a large under-stair storage cupboard.

Upstairs, the main bedroom is spacious and benefits from built-in wardrobes, while bedroom two can be used flexibly as a guest room or home office. The modern three-piece bathroom suite completes the first floor.

Externally, the property provides on-street parking at the front and a well-maintained rear yard, including a paved patio, plant plots, and lattice fencing for added privacy. With a south-west facing aspect, the garden is perfect for enjoying the summer months.

This property represents an ideal opportunity for those looking for a contemporary home with character, in a fantastic location with everything Congleton has to offer on your doorstep.

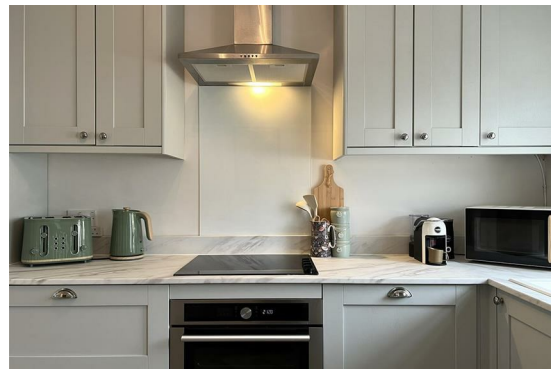

# Room Descriptions

## Lounge/Diner

12'0" x 12'2"

UPVC double glazed window to the front elevation. Decorative cast iron feature fireplace. Ceiling light fitting. Central heating radiator with radiator cover. Herringbone flooring. Power Points. Opaque window and open access into the kitchen.



## Kitchen

12'2" x 10'11"

Fitted kitchen comprising contemporary wall and base units with marble effect work surface over. Inset sink with single drainer and mixer tap. Integrated oven and hob with extractor over. Integrated fridge freezer and dishwasher. Space for a washer/dryer. Ceiling light fitting. Herringbone flooring. Central heating radiator with radiator cover. Spacious under stair storage. Power points. UPVC double glazed window to the rear elevation, with external door out into the rear yard.

## Landing

Providing access to all first floor accommodation.

## Bedroom One

12'2" x 10'9"

UPVC double glazed window to the front elevation. Ceiling light fitting. Central heating radiator with radiator cover. Carpet flooring. Decorative cast iron feature fireplace. Decorative alcove. Fitted Wardrobe. Power Points.



## Bedroom Two / Study

6'0" x 6'0"

UPVC double glazed window to the side elevation. Ceiling light fitting. Carpet flooring. Central heating radiator. Power points.



### Bathroom

9'1" x 4'7"

Three piece modern suite comprising low level WC. Hand wash basin with mixer tap and storage underneath. Wall mounted mirror. Walk in electric shower with removable shower head and tiled splash-back. Tiled flooring and half tiled walls throughout. Chrome heated towel rail. Ceiling light fitting, Store cupboard. UPVC double glazed opaque window to the rear elevation.

### Externally

To the front of the property en street parking is available directly outside the property. To the rear is a well maintained yard made up of paved patio perfect for outdoor seating with lattice fencing for additional privacy. Occupying a south west facing garden.

### Tenure

We understand from the vendor that the property is Freehold. We would however recommend that your solicitor check the tenure prior to exchange of contracts.

### Need to Sell?

For a FREE valuation please call or e-mail and we will be happy to assist.

### AML Disclosure

Agents are required by law to conduct Anti-Money Laundering checks on all those buying a property. Stephenson Browne charge £49.99 plus VAT for an AML check per purchase transaction . This is a non-refundable fee. The charges cover the cost of obtaining relevant data, any manual checks that are required, and ongoing monitoring. This fee is payable in advance prior to the issuing of a memorandum of sale on the property you are seeking to buy.



# Floorplans

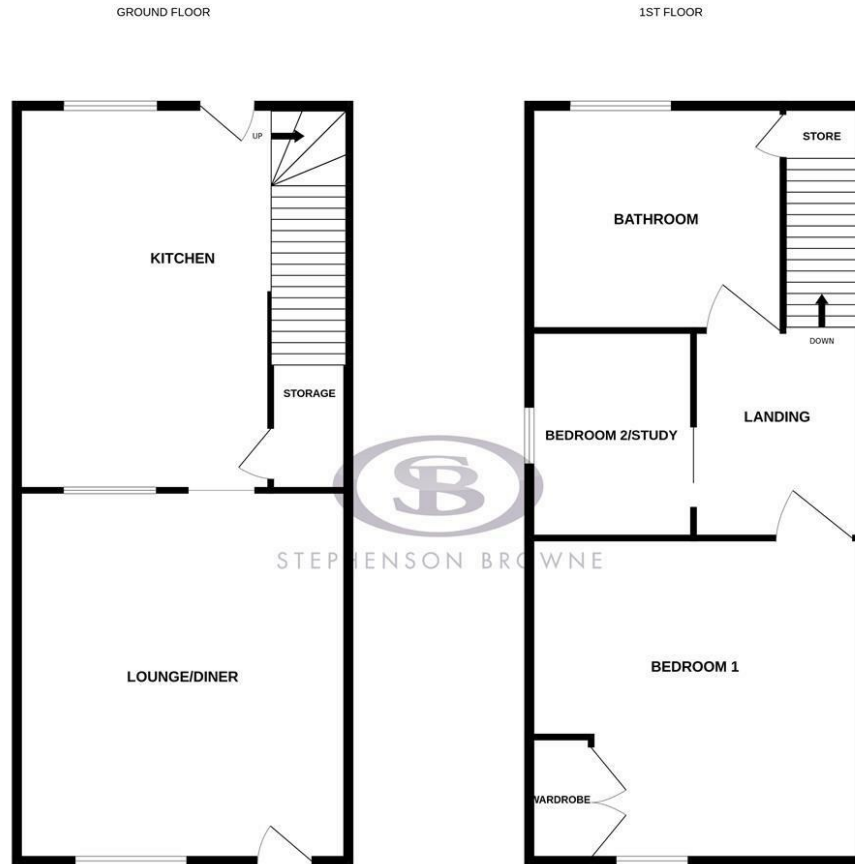

Whilst every attempt has been made to ensure the accuracy of the floorplan contained here, measurements of doors, windows, rooms and any other items are approximate and no responsibility is taken for any error, omission or mis-statement. This plan is for illustrative purposes only and should be used as such by any prospective purchaser. The services, systems and appliances shown have not been tested and no guarantee as to their operability or efficiency can be given. Made with Metropix ©2025

# Area Map

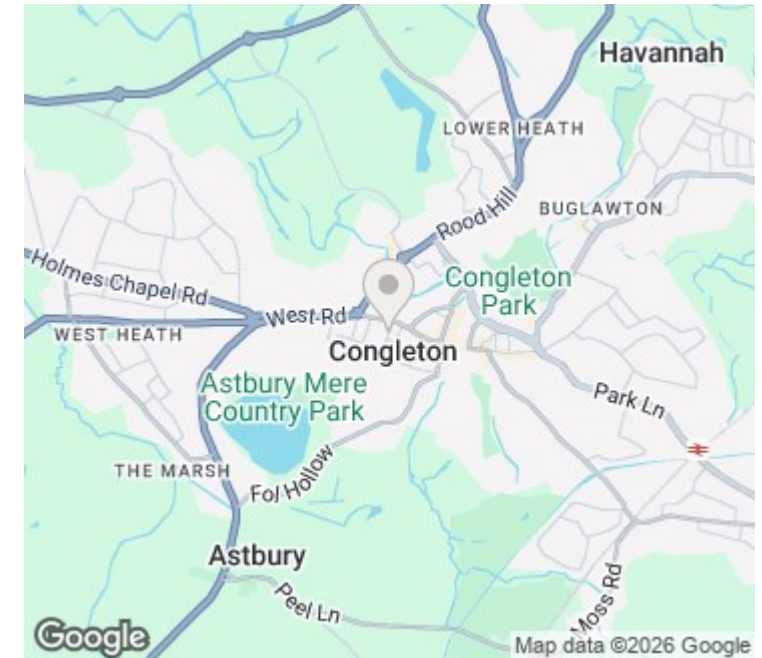

# EPC Rating

Energy Efficiency Rating	Current	Potential
Very energy efficient - lower running costs		
(92 plus) <b>A</b>		
(81-91) <b>B</b>		
(69-80) <b>C</b>		
(55-68) <b>D</b>		
(39-54) <b>E</b>		
(21-38) <b>F</b>		
(1-20) <b>G</b>		
Not energy efficient - higher running costs		
<b>England &amp; Wales</b>	EU Directive 2002/91/EC	<b>76</b>

Environmental Impact (CO <sub>2</sub> ) Rating	Current	Potential
Very environmentally friendly - lower CO <sub>2</sub> emissions		
(92 plus) <b>A</b>		
(81-91) <b>B</b>		
(69-80) <b>C</b>		
(55-68) <b>D</b>		
(39-54) <b>E</b>		
(21-38) <b>F</b>		
(1-20) <b>G</b>		
Not environmentally friendly - higher CO <sub>2</sub> emissions		
<b>England &amp; Wales</b>	EU Directive 2002/91/EC	

# Viewing

Please contact our office using the details provided at the bottom of this page if you are interested in booking a viewing or require further information.

NOTICE: Stephenson Browne for themselves and for the vendors or lessors of this property whose agents they are give notice that: (1) the particulars are set out as a general guideline only for the guidance of intending purchasers or lessees, and do not constitute, nor constitute part of, an offer or contract; (2) all descriptions, dimensions, references to condition and necessary permissions for use and occupation, and other details are given in good faith and are believed to be correct but any intending purchasers or tenants should not rely on them as statements or representations of fact but must satisfy themselves by inspection or otherwise as to the correctness of each theme; (3) no person in the employment of Stephenson Browne has any authority to make representation or warranty whatever in relation to this property. (4) fixtures & fittings are subject to a formal list supplied by the vendors solicitors. **Referring to: Move with Us Ltd Average Fee: £123.64**

**T: 01260 545600 E: congleton@stephensonbrowne.co.uk**

[www.stephensonbrowne.co.uk](http://www.stephensonbrowne.co.uk)