

for sale

£98,000



Milestone Way Whitestone HEREFORD HR1 3TG

This very well-presented three bedroom family home offers comfortable accommodation in a popular Village Setting. Being offered at a 35% Share, this Shared Ownership property is an ideal opportunity for First Time Buyers to get on the property ladder and wanting a sizable home to move straight in to.

Milestone Way Whitestone HEREFORD HR1 3TG

Entrance Hall

Frosted Double glazed door, central heating radiator, one centre light point.

Lounge

Double glazed window to the front & side aspect, Feature electric fireplace, central heating radiator, one centre light point.

Kitchen

Double glazed window to the rear aspect, under stair storage cupboard with centre light point, wall & base units, wash basin, plumbing for washing machine & dishwasher, central heating boiler, integrated gas cooker/ hob/ extractor fan, space for fridge freezer, six spotlights, central heating radiator.

Cloakroom

Central heating radiator, one centre light point, wash basin , W.C.

Hall To Rear

Double glazed door to the rear, central heating radiator, one centre light point.

Landing

Loft hatch, one centre light point.

Bedroom One

Double glazed window to the front aspect, central heating radiator, built in storage cupboard, one centre light point, two wall light points.

Bedroom Two

Double glazed window to the rear aspect, central heating radiator, one centre light point.

Bedroom Three

Double glazed window to the rear aspect, central heating radiator, one centre light point.



Bathroom

Frosted window to the side aspect, wash basin, W.C, panelled bath with shower, wall storage unit, central heating radiator, four spotlights.

Rear Garden

Indian stone patio to the rear, side access via gate, fence surround, pergola, large decking for entertaining with seating area.

Parking

Drive way to the side of the property.



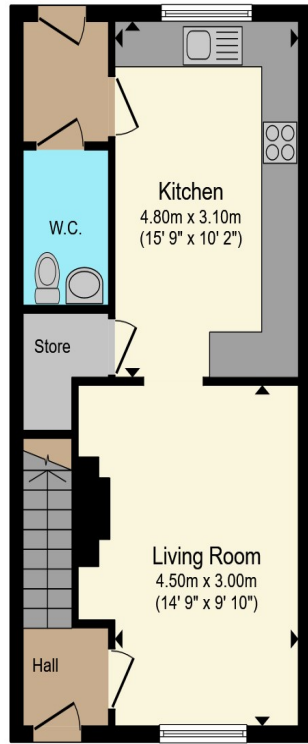

Ground Floor

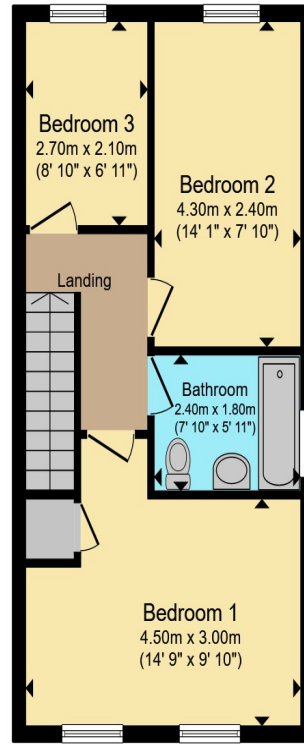

First Floor

Total floor area 83.7 m² (901 sq.ft.) approx

This floor plan is for illustrative purposes only. It is not drawn to scale. Any measurements, floor areas (including any total floor area), openings and orientation are approximate. No details are guaranteed, they cannot be relied upon for any purpose and they do not form part of any agreement. No liability is taken for any error, omission or misstatement. A party must rely upon its own inspection(s). Powered by www.propertybox.io



To view this property please contact Connells on

T 01432 267 511
E hereford@connells.co.uk

23 King Street
 HEREFORD HR4 9BX

Property Ref: HER316267 - 0005

Tenure:Leasehold EPC Rating: B

Council Tax Band: C Service Charge: Ask Agent

Ground Rent: 649.92

view this property online [connells.co.uk/Property/HER316267](https://www.connells.co.uk/Property/HER316267)

This is a Leasehold property with details as follows; Term of Lease 125 years from 31 Aug 2018. Should you require further information please contact the branch. Please Note additional fees could be incurred for items such as Leasehold packs.

1. MONEY LAUNDERING REGULATIONS Intending purchasers will be asked to produce identification documentation at a later stage and we would ask for your co-operation in order that there will be no delay in agreeing the sale. 2. These particulars do not constitute part or all of an offer or contract. 3. The measurements indicated are supplied for guidance only and as such must be considered incorrect. Potential buyers are advised to recheck measurements before committing to any expense. 4. We have not tested any apparatus, equipment, fixtures, fittings or services and it is in the buyers interest to check the working condition of any appliances.

Connells Residential is registered in England and Wales under company number 1489613, Registered Office is Cumbria House, 16-20 Hockliffe Street, Leighton Buzzard, Bedfordshire, LU7 1GN. VAT Registration Number is 500 2481 05.

