



Kennington Park Road, SE11

£550,000



- Two Bedrooms
- First Floor

- High Ceilings
- Period Conversion

- Chain Free
- Excellent Location





ABOUT THE PROPERTY

A beautifully presented two bedroom apartment situated on the first floor of an elegant Georgian period conversion. The property is in excellent condition and enjoys an abundance of natural light throughout. The apartment features high ceilings and an impressive open plan living space to the rear, complemented by bow bay windows offering a delightful south facing aspect and attractive views.

The contemporary kitchen is generous in size, with ample storage and modern fittings.

Located on a popular tree lined road, the property is moments from Kennington Station (Northern Line) and within easy reach of numerous bus routes providing convenient access to the City and the West End. A wide selection of popular bars, cafés, shops and restaurants are all within a short walk. The green open spaces of Kennington Park are nearby, as well as the well-regarded farmers' market at St Mark's Church opposite Oval Underground Station.



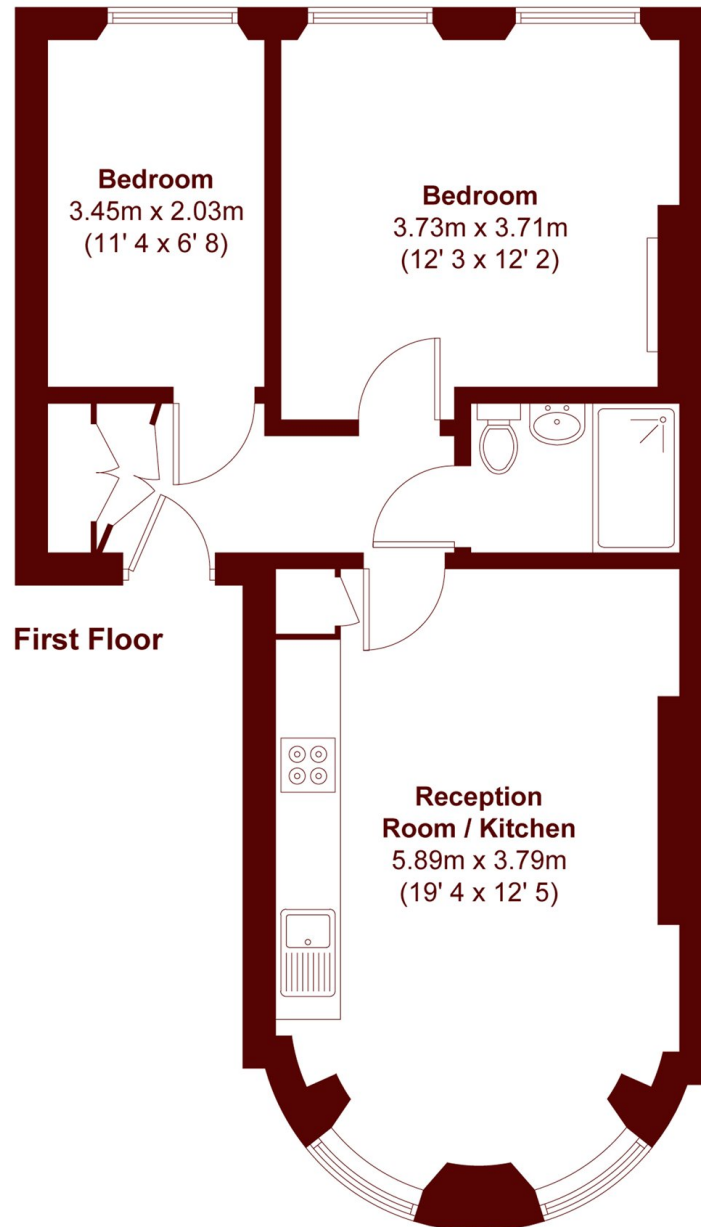

APPROX. GROSS INTERNAL FLOOR AREA
542 SQFT / 50.4 SQM

Marsh & Parsons Kennington

295 Kennington Road,
London, SE11 4QE
020 7587 1533

We aim to make our particulars both accurate and reliable. However, they are not guaranteed; nor do they form part of an offer or contract. If you require clarification on any points then please contact us, especially if you're traveling some distance to view. Please note that appliances and heating systems have not been tested and therefore no warranties can be given as to their good working order.