

# 126 St. Johns Close - Guide Price £185,000

Mildenhall Suffolk IP28 7NZ

**shires**  
residential



*"Consistently providing outstanding service to our clients"*

# Guide Price £185,000

## The Property

INVESTMENT OPPORTUNITY FOR HMO LANDLORDS ONLY. The 5 renting rooms bring in an annual rent of around £26,940 and a yield of around 16%.

This house of multiple occupation with all licences in place has now come to the market.

There are 5 renting rooms and communal areas.

Call 01638 712132 for further details and to book a viewing slot.

## Features

- ANNUAL YIELD OF CIRCA 16%
- ALL LICENCES IN PLACE
- CURRENTLY LET ON AST'S
- ANNUAL RENT OF CIRCA £26100
- HMO
- 5 LETTING ROOMS
- COMMUNAL AREAS
- CALL 01638 712132 TO DISCUSS FURTHER







These sales particulars have been produced as a general guide only and we would draw to your attention that we have not carried out a detailed Survey of the property nor have we tested services, appliances or specific fittings. Whilst measurements and statements given within the details are provided in good faith, their accuracy should not be relied upon. If there are any points about which you may be uncertain or would like further clarification, we would suggest that you telephone this office and speak to our staff who will endeavour to assist you.

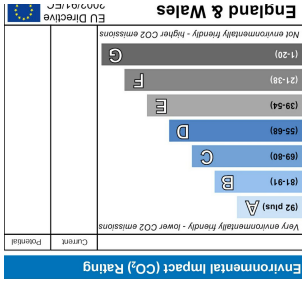
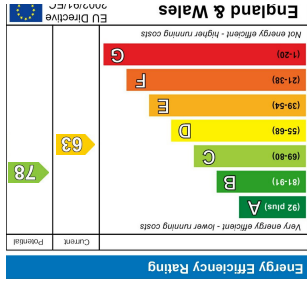

Shires Residential  
4 New Street, Mildenhall, Suffolk, IP28 7EN  
T: 01638 712132  
E: mildenhall@shiresestateagents.co.uk  
www.shiresresidential.com

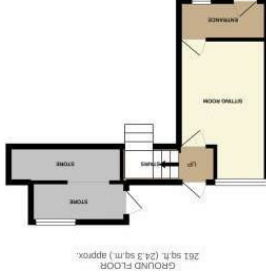

What every attempt has been made to ensure the accuracy of the floorplan contained herein, measurements of doors, windows, rooms and any other items are approximate and no guarantee is taken by any contractor or his agent. This plan is for illustrative purposes only and should be used as such by any prospective purchaser. The services, fixtures and appliances shown have not been tested and no guarantee as to their operability or efficiency can be given.

Made with MapInfo v5.02/21

1200  
A CAN