

Sherbourne Street

ST. GEORGE

APPROXIMATE FLOOR AREA
88 SQM / 954 SQFT



GROUND FLOOR

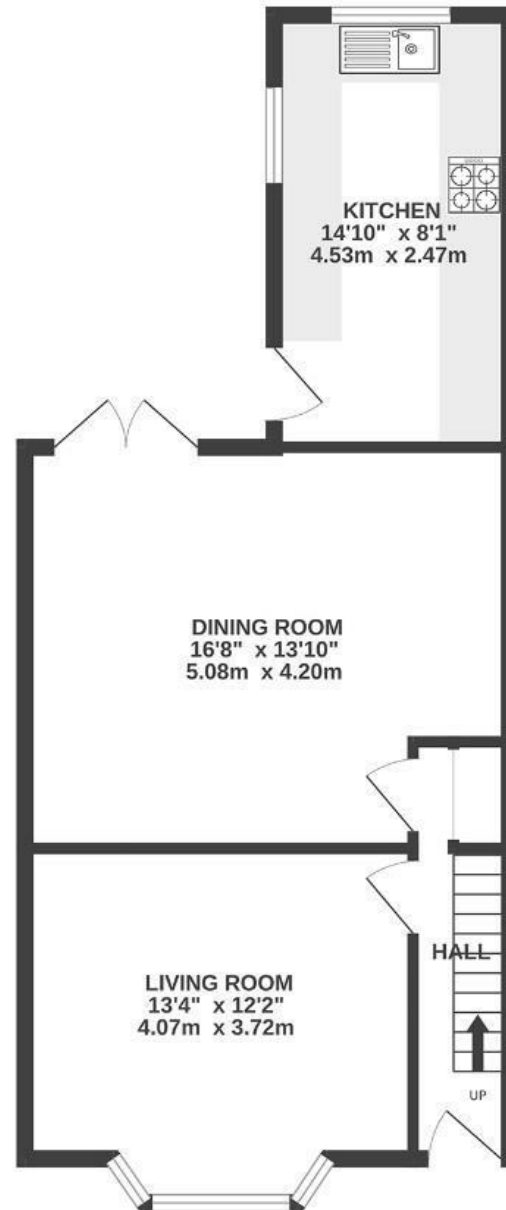

FIRST FLOOR

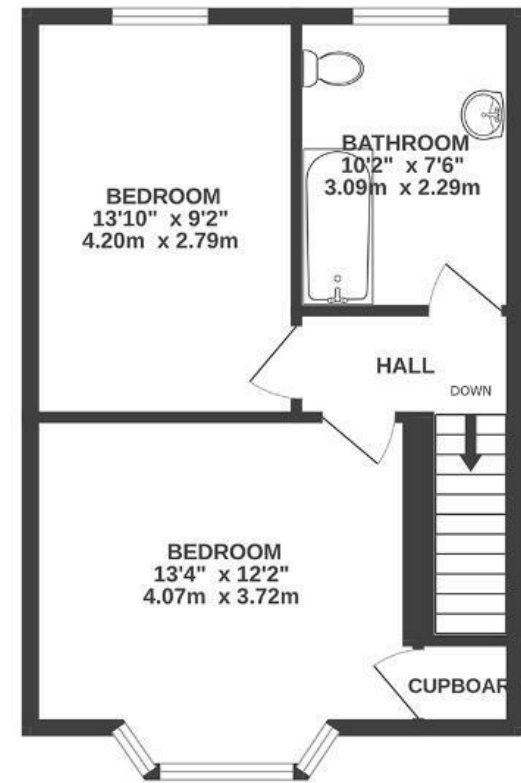

Boardwalk

Sherbourne

, BRISTOL

£

£385,000



BS5 8EQ

zZz

2 Bedrooms



1 Bathrooms

This home has been the perfect place for us to see through big changes in our lives. Moving in as a couple, we loved being able to host friends and go out on Church road. After we got our dog we started to explore the green places nearby, loving troopers hill and the river and being able to easily drive out to the countryside. These places have then become so special in a different way as we started a family, having so much on your doorstep but also a peaceful garden and space for our child to play.

