



# Standish Bank, Shirecliffe, S5 8YB

Offers In Region Of £420,000

🛏️ 4 🚿 3 🚗 1



## Why You'll Love It

Set on a quiet cul-de-sac within the popular Standish Bank development, this stunning four-bedroom detached home offers an ideal mix of modern design and family-friendly living. From the moment you step inside, the thoughtful layout, natural light, and high-quality finish make a lasting impression.

The heart of the home is the expansive open-plan kitchen, dining, and living area, a bright, sociable space perfect for both family life and entertaining. The rear extension has transformed the ground floor, creating a seamless flow between cooking, dining, and relaxing areas. The kitchen features sleek cabinetry and integrated appliances, offering a contemporary yet practical space to prepare meals while still being part of the action.

Bi-folding doors open directly onto the garden, bringing the outside in and providing an easy transition to outdoor dining in the warmer months. The rear garden is both manageable and inviting, offering space for children to play, barbecues in summer, or simply a peaceful spot to unwind.

The ground floor also includes a stylish family bathroom and a utility area, keeping laundry and storage neatly tucked away. This practical addition enhances the home's functionality without compromising on style.

Upstairs, you'll find four well-proportioned bedrooms, each offering space and flexibility for family, guests, or a home office. The main bedroom enjoys the luxury of an ensuite shower room, adding an extra layer of comfort and privacy. A further family bathroom serves the remaining bedrooms, featuring modern fittings.

Throughout, the home is beautifully presented and finished to a high standard, allowing new owners to simply move in and enjoy. From the beautiful décor and modern flooring to the attention to layout and light, this property flows beautifully from room to room, the very definition of a well-thought-out family home.

To the front, there is off-road parking for multiple vehicles, with easy access to the property and side pathways leading to the rear garden.



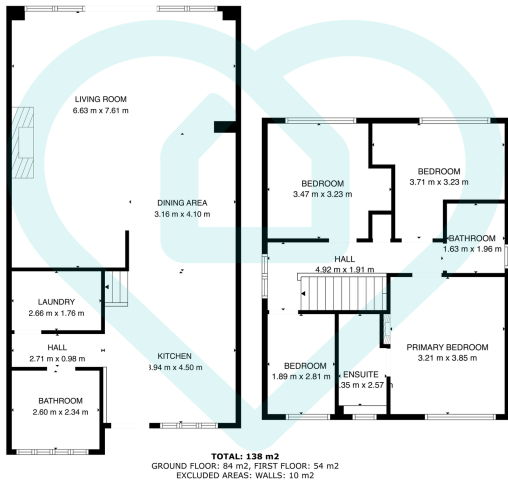

This floor plan is for illustrative purposes only. All measurements and layouts are approximations and do not necessarily capture the precise specifications of the property. No responsibility is taken for any error, omission, or misstatement. We always recommend viewing in person to confirm the exact floor plan of a property. Made with Metropix.



- Offers In Region Of £450,000
- Extended To The Rear
- Open Plan Living
- Beautiful Family Home
- Four Good Sized Bedrooms
- Separate Utility Space
- Parking and Rear Garden
- Good Schools Nearby
- Good Transport Links
- Excellent Location Near Parks and Amenities

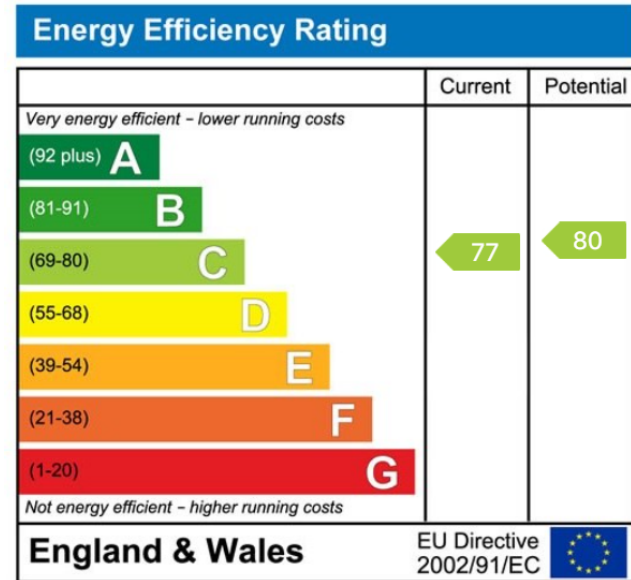

### Sales | Lettings | New Homes

VAT Reg Number: 191 3588 84  
 Company Reg Number: 08610489  
 Company Reg Address: 67 Middlewood Road, Hillsborough, Sheffield, S6 4GX.

The MorfittSmith Building  
 67 Middlewood Road  
 Hillsborough  
 Sheffield  
 S6 4GX

### Get in touch - arrange an appointment



0114 232 1764  
 sales@morfittsmith.co.uk  
 lettings@morfittsmith.co.uk  
 newhomes@morfittsmith.co.uk  
 www.morfittsmith.co.uk



@MorfittSmith  
 @MorfittSmith  
 MorfittSmith  
 Estate & Letting Agent