



36 Birdwood Avenue, Dartford, DA1 5GB  
**£1,600 Per month**



36 Birdwood Avenue, Dartford, DA1 5GB

**£1,600 Per month**

Nestled in the desirable area of Birdwood Avenue, Dartford, this purpose-built flat offers a perfect blend of modern living and convenience. Spanning an impressive 775 square feet, the property boasts a well-designed layout that includes one inviting reception room, two comfortable bedrooms, and two contemporary bathrooms, making it an ideal choice for couples, small families, or professionals seeking a stylish home.

Constructed in 2007, the flat benefits from modern fixtures and fittings, ensuring a comfortable and low-maintenance lifestyle. The spacious reception room serves as a welcoming area for relaxation and entertaining, while the two bedrooms provide ample space for rest and privacy. The presence of two bathrooms adds to the convenience, catering to the needs of busy households.

Additionally, the property includes parking for one vehicle.

This property will be legally prepared enabling any interested buyer to secure the property immediately once their bid/offer has been accepted. Ultimately a transparent process which provides speed, security and certainty for all parties.

Auctioneers Additional Comments

## Description

Nestled in the desirable area of Birdwood Avenue, Dartford, this purpose-built flat offers a perfect blend of modern living and convenience. Spanning an impressive 775 square feet, the property boasts a well-designed layout that includes one inviting reception room, two comfortable bedrooms, and two contemporary bathrooms, making it an ideal choice for couples, small families, or professionals seeking a stylish home.

Constructed in 2007, the flat benefits from modern fixtures and fittings, ensuring a comfortable and low-maintenance lifestyle. The spacious reception room serves as a welcoming area for relaxation and entertaining, while the two bedrooms provide ample space for rest and privacy. The presence of two bathrooms adds to the convenience, catering to the needs of busy households.

Additionally, the property includes parking for one vehicle.

This flat on Birdwood Avenue is not just a place to live; it is a home that offers comfort, style, and practicality in a sought-after location. Whether you are looking to buy or rent, this property is sure to impress with its modern appeal and convenient features.

## Situation

Located within easy reach of the M25 and A2 major roads into London and further into the South East.

Dartford train station is a bus ride away nearby.

Unfurnished

Council Tax Band: D

Available: 3rd June 2026



## Floor Plans

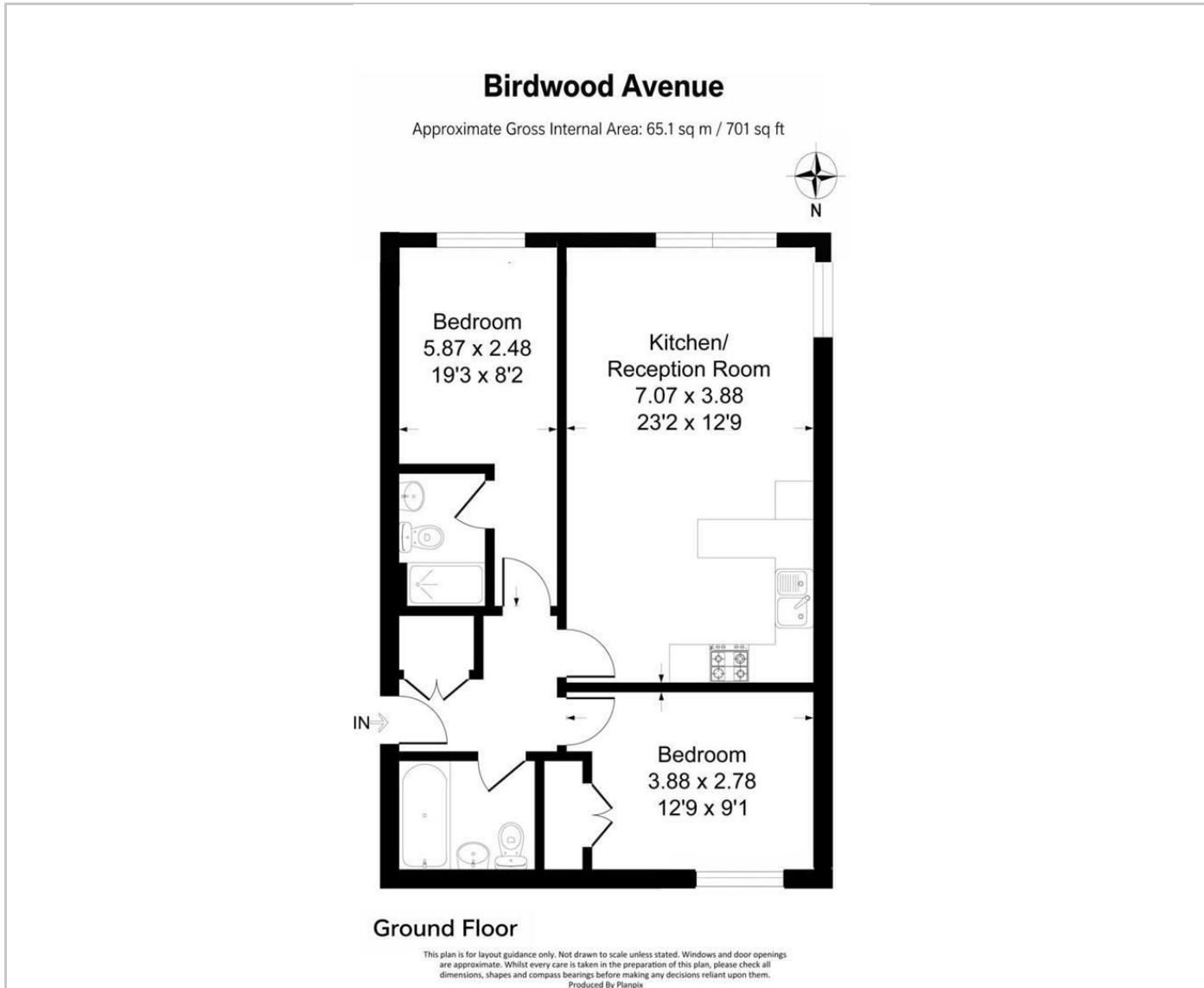

## Area Map

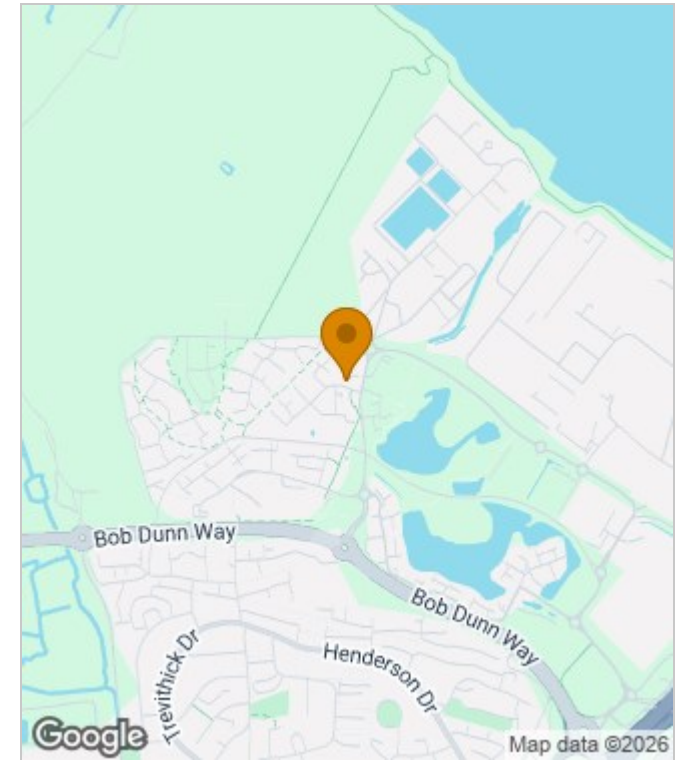

## Energy Performance Graph

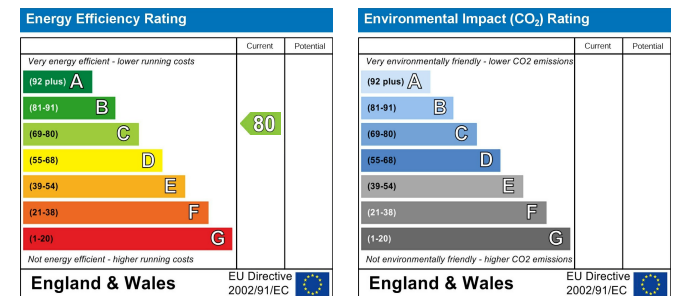

These particulars, whilst believed to be accurate are set out as a general outline only for guidance and do not constitute any part of an offer or contract. Intending purchasers should not rely on them as statements of representation of fact, but must satisfy themselves by inspection or otherwise as to their accuracy. No person in this firm's employment has the authority to make or give any representation or warranty in respect of the property.

The Nucleus Brunel Way, Dartford, Kent, DA1 5GA

Tel: 02081758868 Email: [property@lyhpropertyconsultants.com](mailto:property@lyhpropertyconsultants.com) [www.lyhpropertyconsultants.com](http://www.lyhpropertyconsultants.com)