



21C Stanley Park Road, Wallington, SM6 0HL



Guide price £875,000

**Cromwells**  
ESTATE AGENTS



# 21C Stanley Park Road

Wallington, SM6 0HL

Guide price £875,000

Cromwells Wallington are delighted to bring to market this deceptively spacious four-bedroom detached home, offering a generous total internal floor area of approximately 1,961 sq. ft. (182.2 sq. m.). The property has been thoughtfully designed to suit comfortable modern living, and is offered to the market with NO ONWARD CHAIN.

The property is located in a prime Wallington location close to an abundance of shops, transport links and sought after schools.



## Accommodation

UPVC double glazed entrance porch  
Quarry tiled step

Part glazed wooden front door to..

Entrance hall  
Herringbone parquet flooring, single panel radiator,  
under stairs storage cupboard, wall mounted thermostat.

Lounge/diner  
UPVC double glazed window to front aspect and  
sliding doors to rear, two double panel radiators, feature  
cast iron fireplace, herringbone parquet flooring.

Kitchen/breakfast room  
Range of fitted gloss wall units with matching  
cupboards and drawers below, quartz worktops with  
inlaid stainless steel sink and chrome mixer tap,  
integrated oven/grill/microwave, integrated dishwasher,  
inlaid gas hob with extractor fan above, UPVC double  
glazed window and door to rear aspect and further  
window at front, tiled flooring, double panel radiator,  
decorative tiled splash back.

Utility room  
UPVC double glazed window to rear aspect, wood  
laminated flooring, space for American style fridge/freezer  
and ample storage, access to garage.

Downstairs shower room





Consisting of tiled cubicle with thermostatic shower, pedestal wash hand basin with chrome mixer tap, low-level push button flush WC, heated chrome towel, tiled flooring, tiled walls, obscure UPVC double glazed window to rear aspect.

Stairs to 1st floor landing  
UPVC double glazed window to front aspect, double panel radiator, fitted storage cupboards, loft access.

Bedroom one  
UPVC double glazed window to front aspect, single panel radiator, coved ceiling.

Bedroom two  
UPVC double glazed window to rear aspect, single panel radiator.

Bedroom three  
UPVC double glazed window to front aspect, single panel radiator.

Bedroom four  
UPVC double glazed window to rear aspect, single panel radiator.

Bathroom  
Comprising panel enclosed corner bath with chrome mixer tap and shower attachment, pedestal wash hand basin with chrome mixer tap, low-level push button flush WC, heated chrome towel, tiled flooring, tiled walls, obscure UPVC double glazed window to rear aspect.

Rear garden  
Large rear garden, spacious patio area and mainly laid to lawn.

Garage at side  
Up/over door at front.

Front  
Large driveway providing ample off street parking.

#### BUYER'S INFORMATION

Under UK law, estate agents are legally required to conduct Anti-Money Laundering (AML) checks on buyers and sellers to comply with regulations. These checks are mandatory, and estate agents can face penalties if they fail to perform them. We use the services of a third party to help conduct these checks thoroughly. As such there is a charge of £36 including vat, per person. Please note, we are unable to issue a memorandum of sale until these checks are complete

## Floor Plan

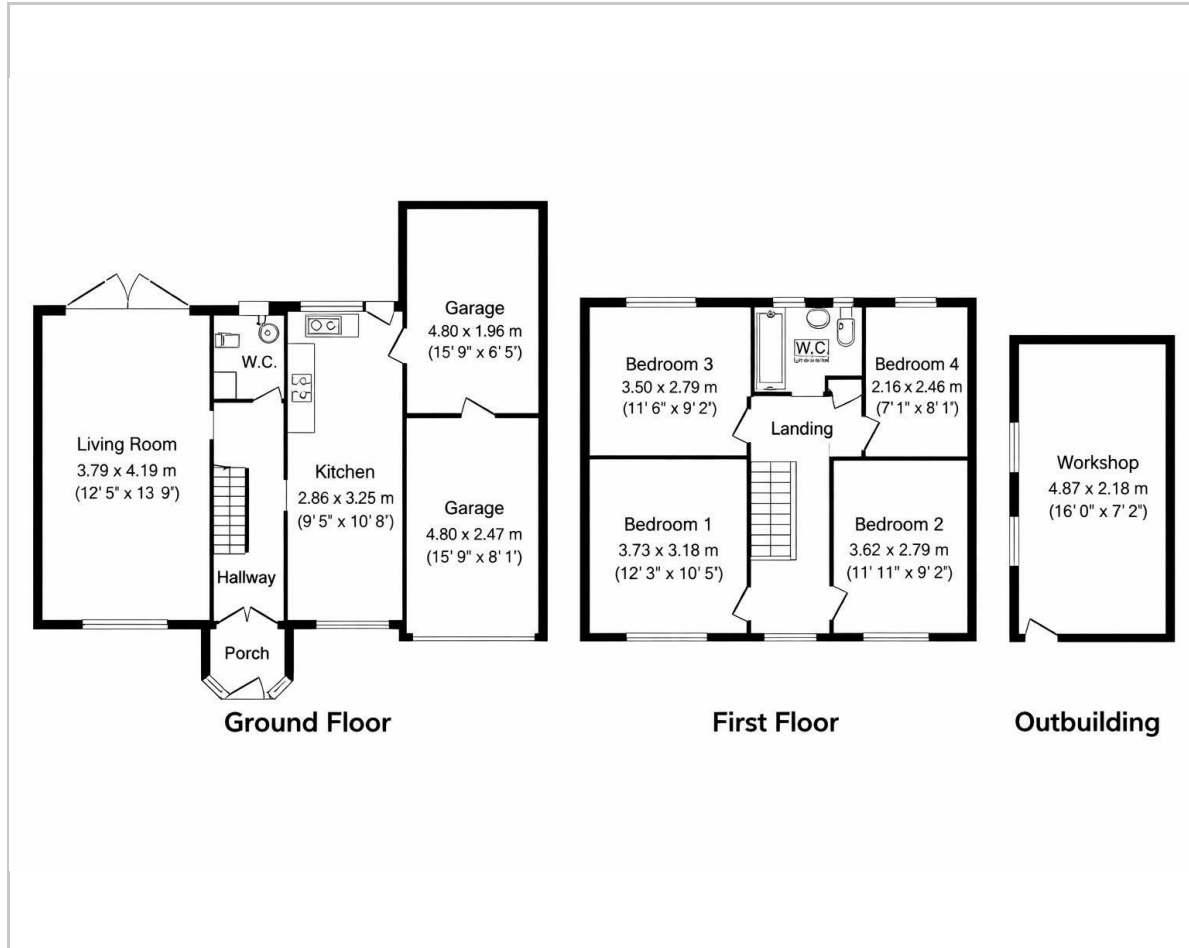

## Area Map

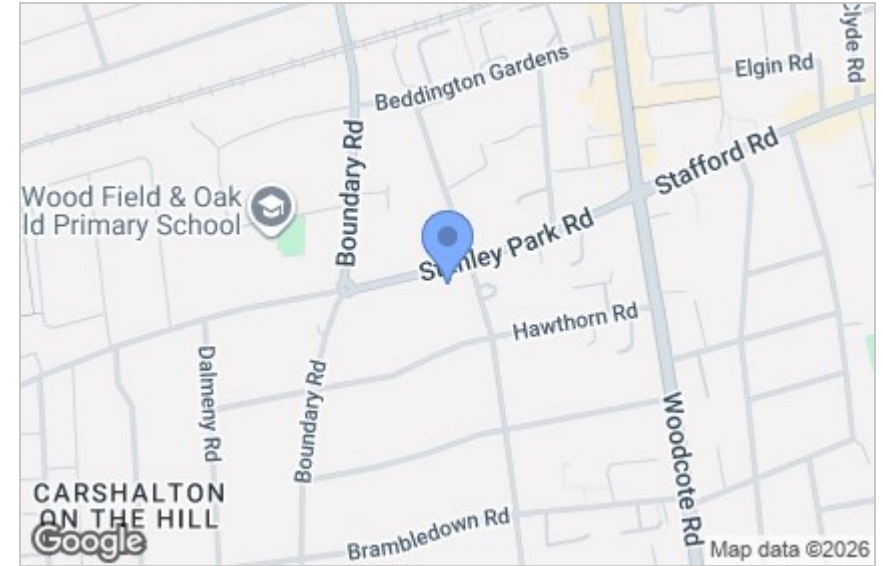

## Energy Efficiency Graph

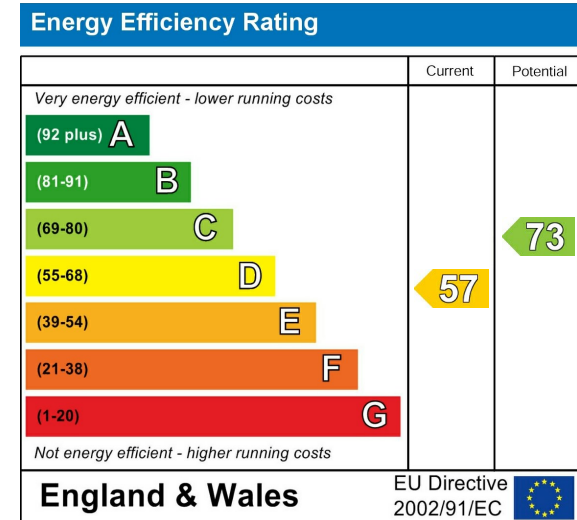

## Viewing

Please contact our Cromwells Office on 0208 647 4422

if you wish to arrange a viewing appointment for this property or require further information.

These particulars, whilst believed to be accurate are set out as a general outline only for guidance and do not constitute any part of an offer or contract. Intending purchasers should not rely on them as statements of representation of fact, but must satisfy themselves by inspection or otherwise as to their accuracy. No person in this firm's employment has the authority to make or give any representation or warranty in respect of the property.