

# LANES



## 2 Salters Mews, Neath Hill, Milton Keynes, Bucks, MK14 6HF

Lanes Sales and Lettings are delighted to offer this charming ONE BED FURNISHED FLAT on a POPULAR ESTATE CLOSE TO THE CITY CENTRE and M1. The property compromises GOOD SIZE LOUNGE with FEATURE FIRE, SOFA BED with TASTEFUL FURNISHING & FITTINGS. KITCHEN with WHITE GOODS. BEDROOM with FITTED WARDROBE, FULL TILED BATHROOM with SHOWER over bath. HALLWAY includes several STORAGE CUPBOARDS. SINGLE GARAGE with OFF ROAD PARKING and REAR PATIO GARDEN. VIEWING HIGHLY RECOMMENDED to appreciate this property. LANES AVAILABLE END JANUARY 26.

- One Bedroom
- Garge
- Available end Jan 26
- Furnished
- Garden
- Gas Central Heating
- Off Road Parking

### £895 PCM

## 2 Salters Mews, Neath Hill, Milton Keynes, Bucks, MK14 6HF





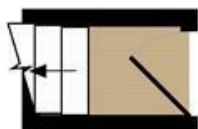

GROUND FLOOR  
APPROX. FLOOR  
AREA 13 SQ.FT.  
(1.2 SQ.M.)

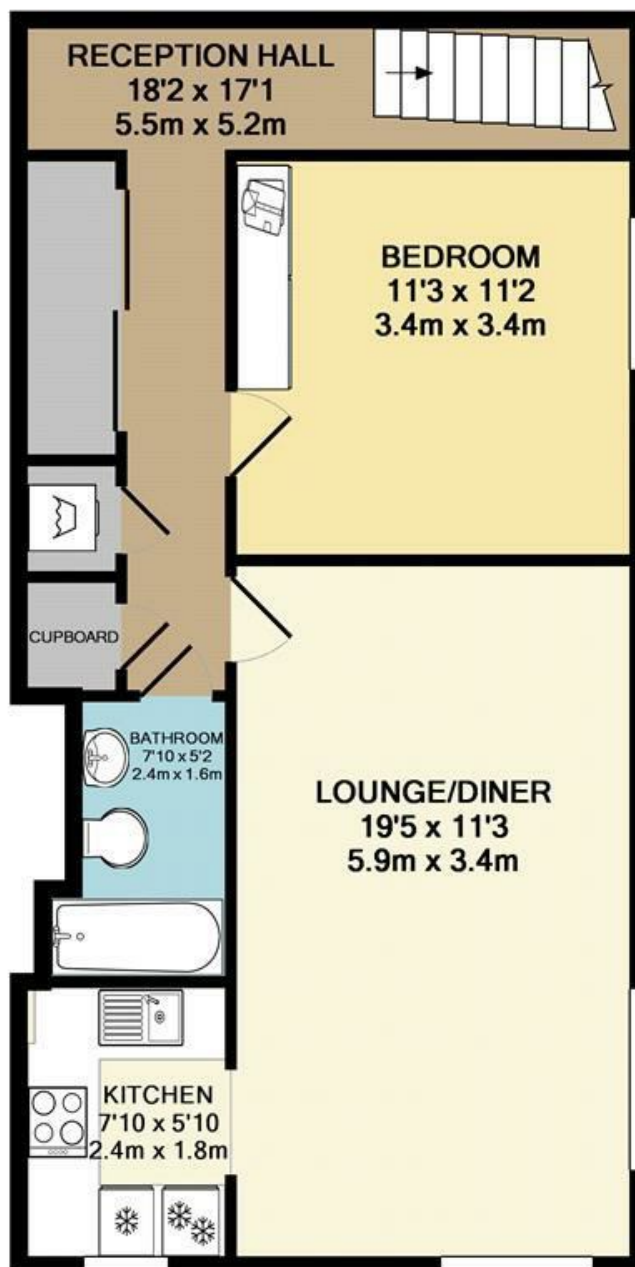

1ST FLOOR  
APPROX. FLOOR  
AREA 576 SQ.FT.  
(53.5 SQ.M.)

**SALTERS MEWS**  
TOTAL APPROX. FLOOR AREA 589 SQ.FT. (54.7 SQ.M.)

Whilst every attempt has been made to ensure the accuracy of the floor plan contained here, measurements of doors, windows, rooms and any other items are approximate and no responsibility is taken for any error, omission, or mis-statement. This plan is for illustrative purposes only and should be used as such by any prospective purchaser. The services, systems and appliances shown have not been tested and no guarantee as to their operability or efficiency can be given  
Made with Metropix ©2010

Energy Efficiency Rating		Current	Potential
Very energy efficient - lower running costs			
(92 plus) <b>A</b>			
(81-91) <b>B</b>			
(69-80) <b>C</b>			
(55-68) <b>D</b>			
(39-54) <b>E</b>			
(21-38) <b>F</b>			
(1-20) <b>G</b>			
Not energy efficient - higher running costs			
England & Wales		EU Directive 2002/91/EC	

Environmental Impact (CO <sub>2</sub> ) Rating		Current	Potential
Very environmentally friendly - lower CO <sub>2</sub> emissions			
(92 plus) <b>A</b>			
(81-91) <b>B</b>			
(69-80) <b>C</b>			
(55-68) <b>D</b>			
(39-54) <b>E</b>			
(21-38) <b>F</b>			
(1-20) <b>G</b>			
Not environmentally friendly - higher CO <sub>2</sub> emissions			
England & Wales		EU Directive 2002/91/EC	