



## Winchester Road, NW3

£6,000 Per calendar month

Beautifully refurbished to an exceptional standard, this rarely available two-bedroom apartment offers stylish, contemporary living with high-quality finishes throughout. The spacious open-plan kitchen and living area creates a bright, welcoming space that's perfect for both relaxing and entertaining.

Ideally located just a short walk from Swiss Cottage Underground Station (Jubilee Line), the property provides excellent transport links while being moments from the vibrant shops, cafés, restaurants, and amenities of Finchley Road. Residents can also enjoy the popular Swiss Cottage Farmers' Market and benefit from the area's excellent selection of highly regarded local schools, making this an outstanding home in one of North West London's most desirable neighbourhoods.

### Features

- Sixth Floor
- Concierge
- Exquisite Finishes
- Underfloor heating
- Built in Sonos Audio and high spec entertainment system
- Smart Lock Facial recognition software for extra security

# Winchester Road, London, NW3

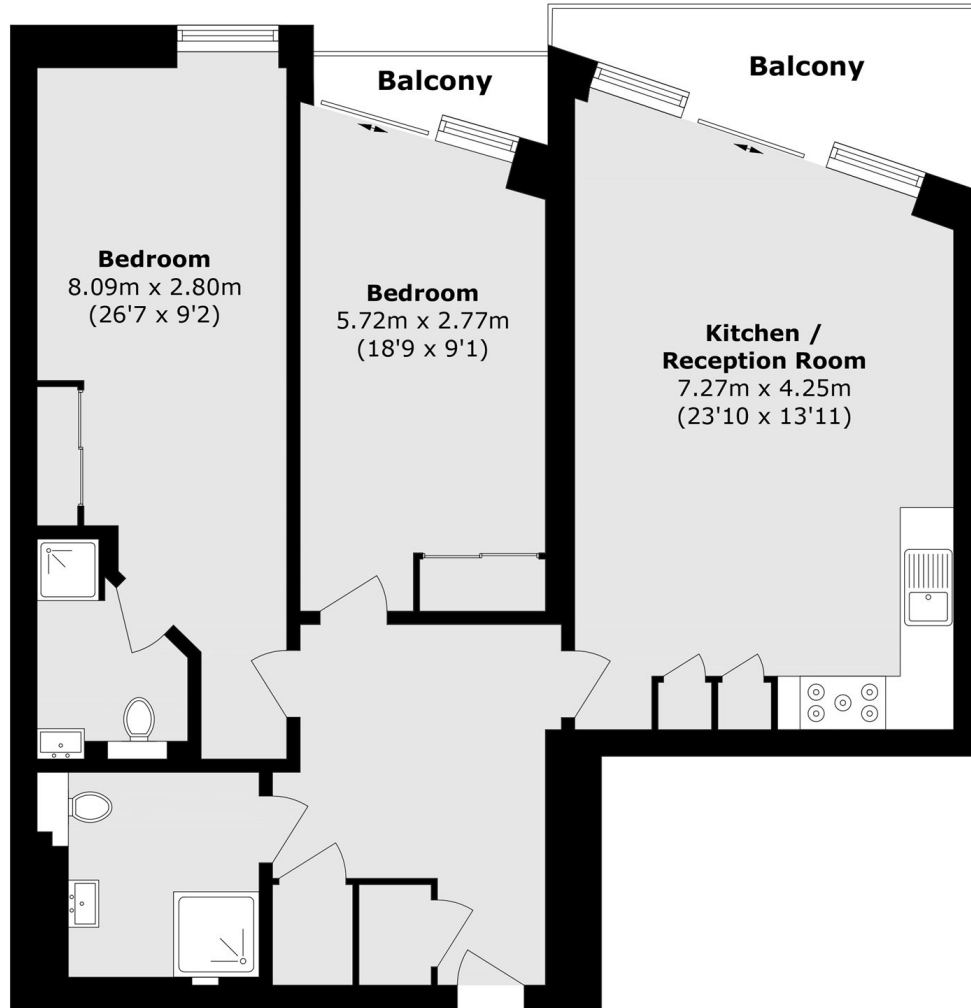

Total area (approx.): 87.8 sq. m (945 sq. ft)  
Balconies area (approx.): 4.9 sq. m (52.7 sq. ft)