



HR ESTATE AGENTS

3 Bedrooms

House - Semi-Detached

£172,500

Located in

Coventry





George Ebburn Close

Coventry | CV2 2PL



*** SUPERB OPPORTUNITY FOR THOSE THAT MEET THE CRITERIA *** 25% MARKET DISCOUNT ***

Emma Sheridan is absolutely delighted to offer this very rare opportunity to purchase a fabulous home under the Discount Market Sale Home Scheme - you pay 75% of the open market value for 100% ownership.

*** Please do check the criteria and information below before you enquire ***

Criteria:

*Available to local first time buyers, those setting up home following a relationship split, forces employees, people moving into the area for employment and key workers.

*The 75% price applies in perpetuity i.e when each of the low cost homes is sold it will always be at 75% of the market value.

*Buyer(s) must have a total household income at or below the average for Coventry ie £33,900 if a single person or £45,000 if joint - evidence required would be payslips or a letter of offer of a job showing the salary.

George Ebburn Close

£172,500 Freehold



- 25% Discount Scheme - Please Check Criteria
- Three Bedrooms - Master Ensuite
- Off Road Parking & Private Rear Garden
- Built in 2017 - Remainder of Warranty
- Downstairs WC
- EPC Rating B & Council Tax Band B

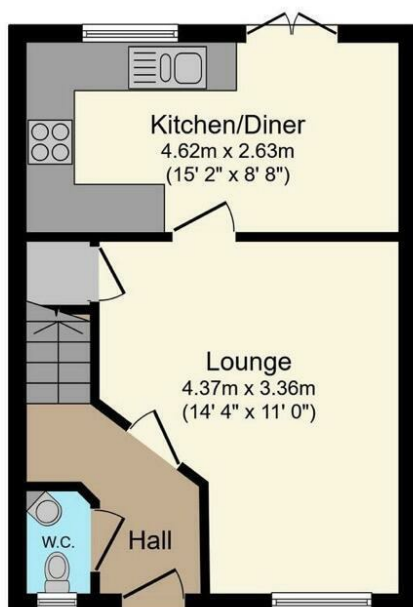

Ground Floor

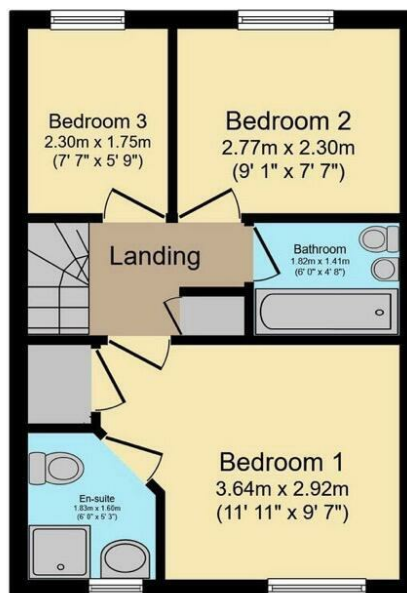

First Floor

Council Tax Band B

Local Authority

Agents Note: Whilst every care has been taken to prepare these particulars, they are for guidance purposes only. All measurements are approximate and are for general guidance purposes only and whilst every care has been taken to ensure their accuracy, they should not be relied upon and potential buyers/tenants are advised to recheck the measurements.

Energy Efficiency Rating		
	Current	Potential
Very energy efficient - lower running costs		
(92 plus) A		96
(81-91) B	83	
(69-80) C		
(55-68) D		
(39-54) E		
(21-38) F		
(1-20) G		
Not energy efficient - higher running costs		
England & Wales		EU Directive 2002/91/EC

Number Three Siskin Drive
Coventry
CV3 4FJ

HR ESTATE AGENTS