

SIGNATURE

NORTH EAST

OFFICIALLY RATED THE NO.1 ESTATE AGENT IN THE NORTH EAST





📍 Clifton Terrace, Whitley Bay NE26 2JD

Clifton Terrace, Whitley Bay NE26 2JD

Offers Over £148,000

Signature North East welcomes you to this two-bedroom terraced flat, ideally located in the heart of Whitley Bay. Offered for sale with a tenant in situ, the property presents an attractive opportunity for investors seeking a well-positioned home close to the coast. A wide range of local amenities, including shops, bars and eateries, are located close by, while Whitley Bay Beach is within easy reach. Whitley Bay Metro also provides excellent transport links across the region.

From the entrance hallway, step into the bright living room, where a large window allows natural light to flood the space. Character features, including an exposed brick wall and alcove detailing, add charm and personality to the room. The kitchen is fitted with wall and base units, offering practical worktop space, well-suited to everyday use. This property benefits from a new combi boiler fit at the beginning of February 2026.

Continuing through the home, you will find two spacious double bedrooms, both offering ample room for furnishings and each benefiting from a large window that fills the space with natural light. The family bathroom is fitted with a bathtub, overhead shower, wash basin and WC, providing functional facilities for day-to-day living.

Externally, the property benefits from a rear yard, offering a peaceful outdoor space. On-street parking is available close by, adding further convenience to this well-located coastal home.



PROPERTY FLOORPLAN

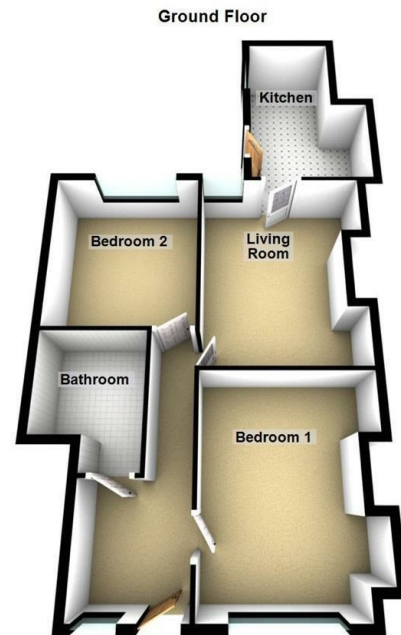

Total area: approx. 71.9 sq. metres (774.3 sq. feet)

Measurements:

Living Room
15'1" x 12'2"

Kitchen
9'7" x 13'6"

Bedroom One
15'5" x 6'6"

Bedroom Two
11'1" x 11'4"

Bathroom
7'7" x 9'9"

Energy Efficiency Rating

	Current	Potential
<i>Very energy efficient - lower running costs</i>		
(92 plus) A		
(81-91) B		
(69-80) C	73	76
(55-68) D		
(39-54) E		
(21-38) F		
(1-20) G		
<i>Not energy efficient - higher running costs</i>		
England & Wales	EU Directive 2002/91/EC 	





More 5 Star Customer Reviews than any other Agent based in the North East on allAgents.co.uk



SALES

LETTINGS

FINANCE

LAW

WE COVER THE WHOLE OF THE NORTH EAST

Whitley Bay
0191 251 3344

Cramlington
01670 897 213

Tynemouth
0191 296 6689

Morpeth
01670 513 966

Ponteland
01661 820 082

Wallsend
0191 432 4151

Alnwick
01665 511 800

Heaton
0191 432 4275

Forest Hall
0191 266 9966

Other locations
0191 640 3523

Newcastle
0191 640 2284

Durham
0191 303 8252

Gosforth
0191 640 3523

Sunderland
0191 543 6390

Whickham
0191 432 5102

Gateshead
0191 432 4294

Jesmond
0191 281 1037

Killingworth
0191 640 3602

Ryton
0191 413 9845

Head Office &
Lettings
0191 253 4815

*Highest recommended 5-star reviews than any other Estate Agent based in the North East on allAgents.co.uk - The UK's Largest Customer Review Website for the Property Industry & Awarded Best Estate Agency 2018 & 2019 - North East England by SME News