



142 BARROWMEAD DRIVE

LAWRENCE WESTON
BS11 0JT

142 BARROWMEAD DRIVE

LAWRENCE WESTON BS11 0JT

ENTRANCE HALLWAY

12'5" x 6'8"

Entrance via uPVC door, stairs rising to first floor.

LIVING ROOM

13'4" x 12'0"

Window to front aspect, fireplace, double doors leading into dining room

DINING ROOM

10'6" x 8'11"

Window to rear aspect, door leading into kitchen

KITCHEN

10'6" x 9'8"

Window to rear aspect, fitted with a range of wall and base units with roll top work surfaces. Ceramic hob and electric oven, stainless steel one and a half bowl sink with mixer tap over, integrated fridge, door leading to covered store room

STORE ROOM

23'3" x 3'9"

This storeroom has side and rear access and has 2 separate rooms and a wc.

FIRST FLOOR LANDING

6'1" x 8'0"

Window to side aspect, door leading to all rooms

WC

2'6" x 4'7"

Window to side aspect, low level wc

SHOWER ROOM

5'4" x 7'5"

Window to side aspect, double shower enclosure, wall mounted sink, cupboard housing water tank.

BEDROOM 1

11'5" x 11'2"

Window to front aspect, 2 cupboards

BEDROOM 2

10'2" x 11'2"

Window to rear aspect, cupboard,

BEDROOM 3

8'4" x 8'2"

Window to front aspect, over stairs cupboard

GARDENS

To the rear, the property boasts a beautifully established garden with a well-maintained lawn, a patio area perfect for outdoor entertaining, and a variety of mature plants, shrubs, and pretty flowering borders. The garden has been thoughtfully arranged into different areas, creating charming spaces to relax and enjoy. A delightful pond adds to the tranquil setting, there is also a green house while a generously sized storage shed provides excellent practicality. With an abundance of colourful flowers and attractive planting throughout, this lovely garden offers a peaceful and inviting outdoor retreat.

PARKING

There is parking to the front for 1 small car.





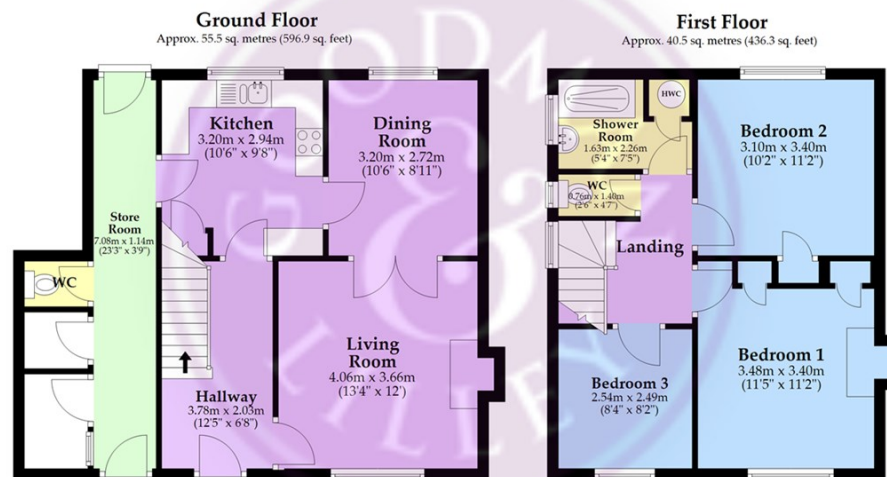

Total area: approx. 96.0 sq. metres (1033.2 sq. feet)

Whilst every attempt has been made to ensure accuracy of the floor plan all measurements are approximate and no responsibility is taken for any error, omission or measurement.

**GOODMAN & LILLEY
BRANCH NETWORK**

HENLEAZE

156 Henleaze Road
Henleaze
BS9 4NB
0117 213 0777
henleaze@goodmanlilley.co.uk

SHIREHAMPTON

9 HIGH STREET
SHIREHAMPTON
BS11 0DT
0117 213 0333

PORTISHEAD

Rembrandt House
36 High Street|
Portishead
BS20 6EN
01275 430440
sales@goodmanlilley.co.uk

SHIRE@GOODMANLILLEY.CO.UK

LETTINGS

01275 299010
LETTINGS@GOODMANLILLEY.CO.UK

CLEVEDON

28 Hill Road
Clevedon
BS21 7PH
01275 403 660
clevedon@goodmanlilley.co.uk

LAND & NEW HOMES

0117 213 0151
LNH@GOODMANLILLEY.CO.UK

3 BEDROOMS
TENURE - FREEHOLD

2 RECEPTION ROOMS
IN ALL SQ.FT

1 BATHROOMS
COUNCIL TAX BAND - B

- 3 Bedroom End of Terraced House Offered with No Onward Chain
- Ideally situated close to a range of highly regarded local schools, making it a great choice for families.
- Enjoy nearby green spaces and historic landmarks, including Kings Weston House and Blaise Estate, perfect for walks and outdoor leisure.Castle
- Requiring some updating throughout, the property offers spacious living accommodation with plenty of potential.
- Excellent transport links provide convenient access to the surrounding areas and city centre.
- A fantastic opportunity for first-time buyers, families, or investors seeking a property with scope to add value.

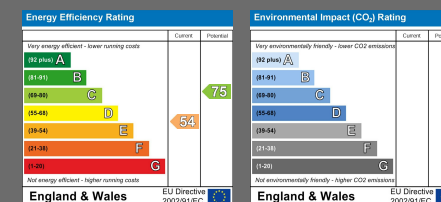

Opening hours vary slightly in each office
 Mon to Fri - Usually 9am till 6pm
 Saturday 9.00am-4.00pm