



56 Gill Crescent Taunton TA1 4NS

£285,000





An immaculately presented 3 bedroomed semi-detached house situated within 1.6 miles of Taunton town centre, close to local amenities, Musgrove Park Hospital and within Castle School catchment with enclosed garden to rear, store and driveway parking.





Features

- Entrance Hall
- Living / Dining Room
- Fitted Kitchen / Breakfast Room with French doors to garden
- Utility Room with door to garden
- Cloakroom
- Master Bedroom
- 2 further Bedrooms
- Family Bathroom
- Enclosed garden to rear
- Store
- Gas central heating
- Double glazing
- Castle School catchment
- Council tax band C
- What3words:
///bliss.branch.actual



56 Gill Crescent, Taunton, TA1

Approximate Area = 820 sq ft / 76.1 sq m

Garage = 72 sq ft / 6.6 sq m

Outbuilding = 23 sq ft / 2.1 sq m

Total = 915 sq ft / 84.8 sq m

For identification only - Not to scale

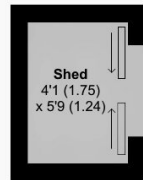

OUTBUILDING

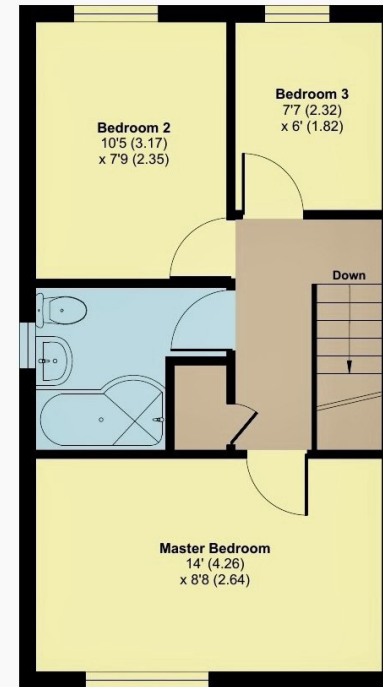

Floor plan produced in accordance with RICS Property Measurement 2nd Edition, Incorporating International Property Measurement Standards (IPMS2 Residential). © nchecom 2025. Produced for Robert Cooney. REF: 1296111



Viewing strictly through the selling agents:

Robert Cooney

Corporation Street, Taunton,
Somerset TA1 4AW

Telephone 01823 230 230

E-mail taunton@robertcooney.co.uk

Website www.robertcooney.co.uk



For clarification, we wish to inform prospective purchasers that: these particulars are set out as a general outline only for the guidance of intended purchasers, and do not constitute, nor constitute part of, an offer or contract; all descriptions, dimensions, references to condition and necessary permission for use and occupation, and other details, are given without responsibility and any intending purchasers should not rely on them as statements or representation of fact, but must satisfy themselves by inspection or otherwise as to the correctness of each of them; no person in the employment of Robert Cooney has any authority to make or give any representation or warranty whatever in relation to this property; we have not carried out a detailed survey nor tested the services, appliances and specific fittings.

**robert
cooney**