



88 Staverton Park, Staverton, Cheltenham, GL51 6TD

£92,000

**FOR SALE**



- Park home
- Off road parking
- EPC Rating - Exempt
- Two bedrooms
- Bright & airy living accommodation
- Council Tax Band - A

## THE PROPERTY

Entering this two bedroom park home from the front door, you step into an entry area that opens up to the main living spaces.

To the front is the living room, a decent sized space with large windows along the front and side, giving it a reasonably light feel. It connects directly to the kitchen area which sits alongside it. The kitchen includes fitted units, a cooker with hob, and work surfaces, along with space for a small table or appliances.

Moving down along the home, the central hallway leads to the second bedroom on the right, a small room with a window and enough space for a bed or basic furniture. Next to this is the bathroom, which contains a bath with overhead shower, a toilet and sink. The bathroom is compact but functional.

At the far end is the master bedroom, another double room of similar proportions to the first, with good window light and space for wardrobes and other furniture.

Overall it is a straightforward, functional home suitable for basic everyday living.

## SITUATION

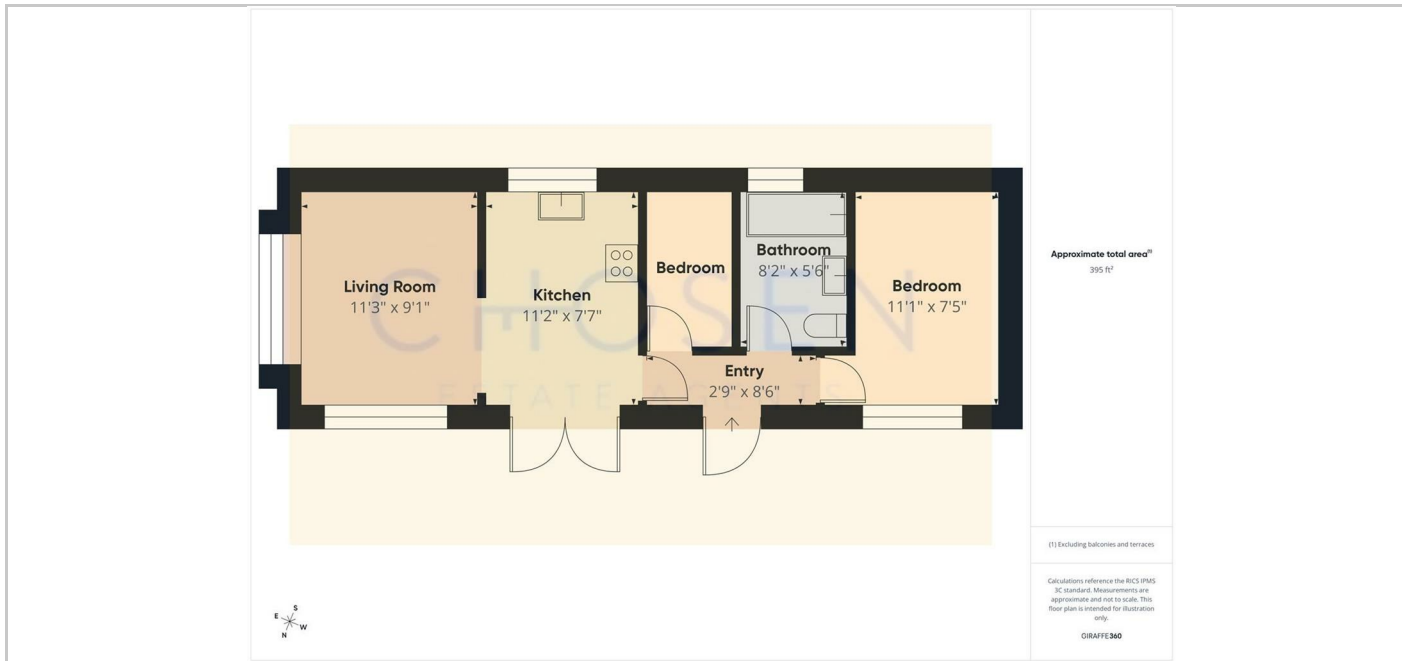

## Directions