



## St. Augustines Avenue, W5

£550,000

\* Offers Over \*

A three bedroom family home with a secluded garden attractively offered to the market with no onward chain and with the potential to extend (STPP).



The ground floor accommodation offers two large reception rooms and a kitchen with garden access. The first floor comprises three bedrooms and a bathroom with a separate WC.

Hanger Lane, Alperton & Park Royal stations are all within walking distance and a range of well regarded schools nearby.

- Three Bedrooms • Secluded Garden • No Onward Chain •
- Potential To Extend (STPP) • Excellent Transport Links • Well Regarded Schools •





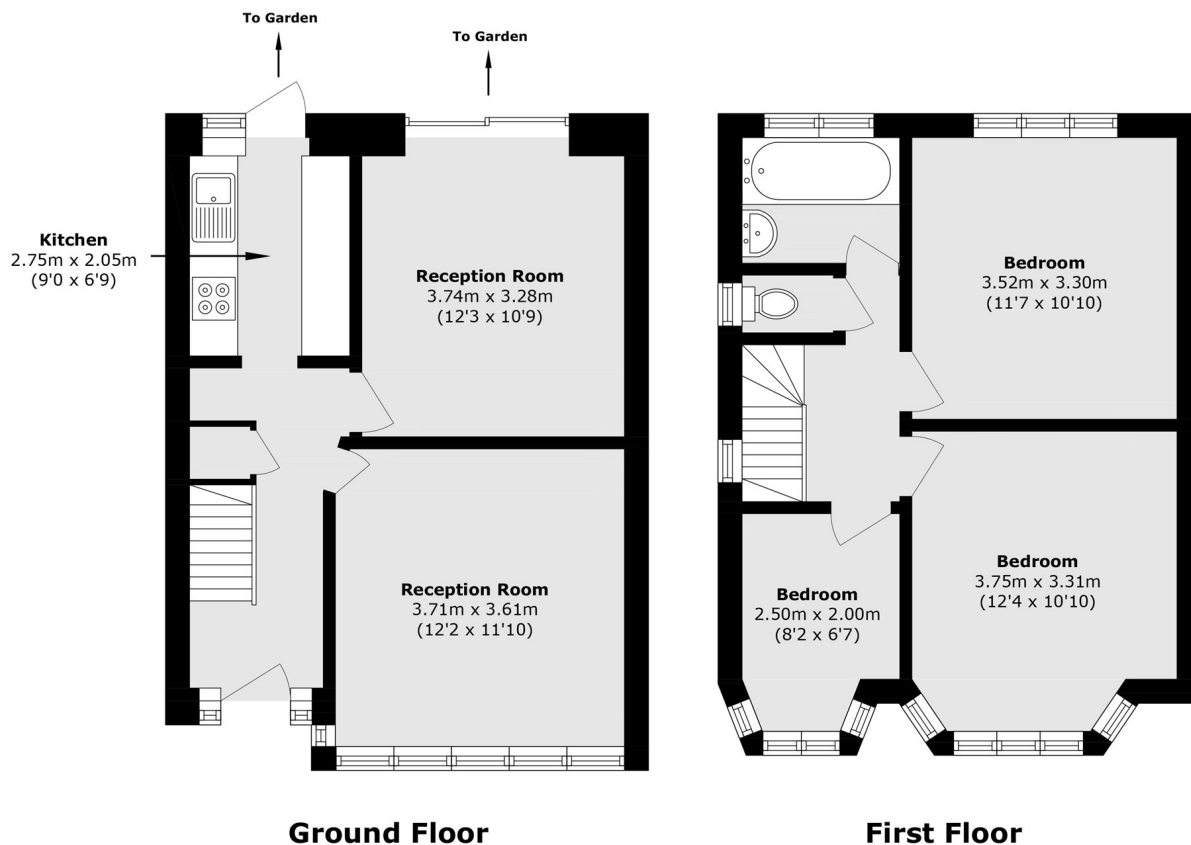

Total area (approx.): 78.8 sq. m (848.2 sq. ft)

Robertson Smith & Kempson Ealing Sales  
 1 The Broadway, London,  
 W5 2NT  
 020 8840 7677  
[ealingsales@robertsonsmithandkempson.co.uk](mailto:ealingsales@robertsonsmithandkempson.co.uk)

Energy Rating: D. We aim to make our particulars both accurate and reliable. However they are not guaranteed; nor do they form part of an offer or contract. If you require clarification on any points then please contact us, especially if you're traveling some distance to view. Please note that appliances and heating systems have not been tested and therefore no warranties can be given as to their good working order.