

Abbott & Abbott

Estate Agents, Valuers and Lettings



50 Ashdown Road, Bexhill-On-Sea, TN40 1SF

£299,950





£299,950

50 Ashdown Road

Bexhill-On-Sea, TN40 1SF

- SEMI- DETACHED HOUSE
- TWO BEDROOMS
- LIVING ROOM
- DOUBLE GLAZING
- CLOSE SEAFRONT
- 1980S BUILT
- KITCHEN/DINER
- REFITTED BATHROOM
- CENTRAL HEATING - NEW BOILER
- GARAGE AT REAR

Abbott and Abbott are offering for sale this extremely well presented two bedroom semi-detached 1980s built house, situated on an east/west aspect in a quiet close within walking distance of the town, station and seafront.

The property has new internal doors, double glazing/gas heating with a new boiler in 2018. The bathroom has also been refitted.

There is a garage to the rear of the garden

Viewing advised



HALL

LIVING ROOM 16'8" x 12'5" (5.1 x 3.8)

KITCHEN/BREAKFAST ROOM 12'5" x 10'5" (3.8 x 3.2)

LANDING

BEDROOM 1 12'5" x 10'5" (3.8 x 3.2)

BEDROOM 2 12'5" x 9'2" (3.8 x 2.8)

BATHROOM

REAR GARDEN

GARAGE



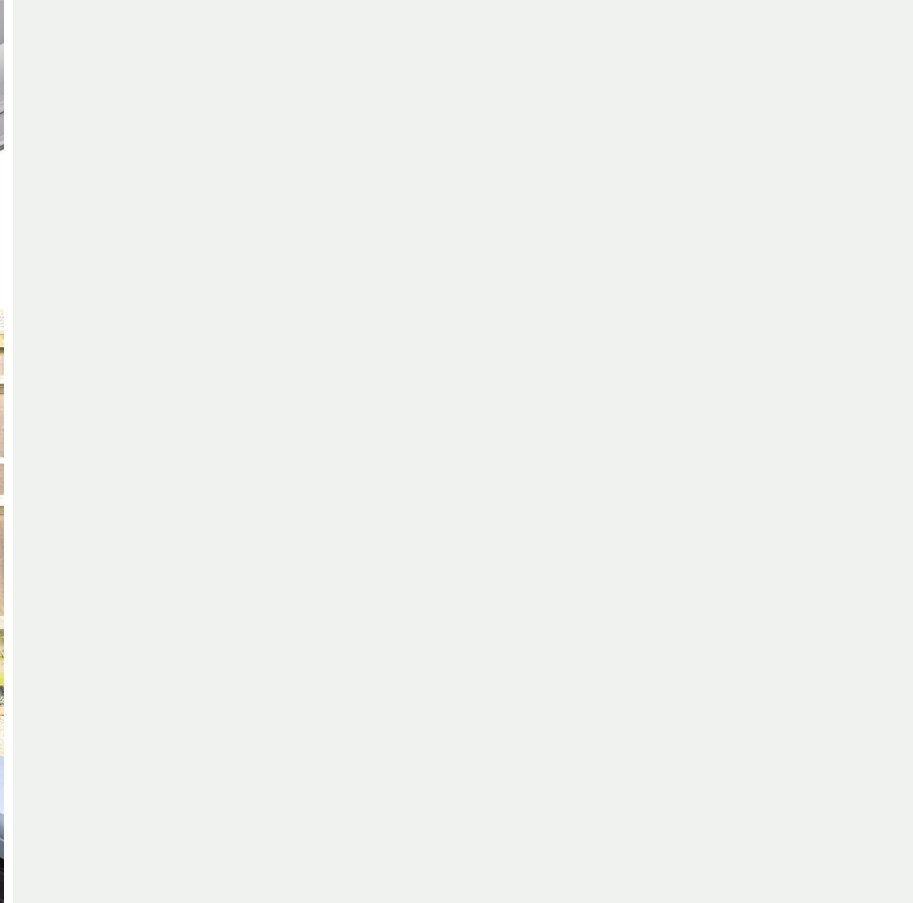



Floor Plans

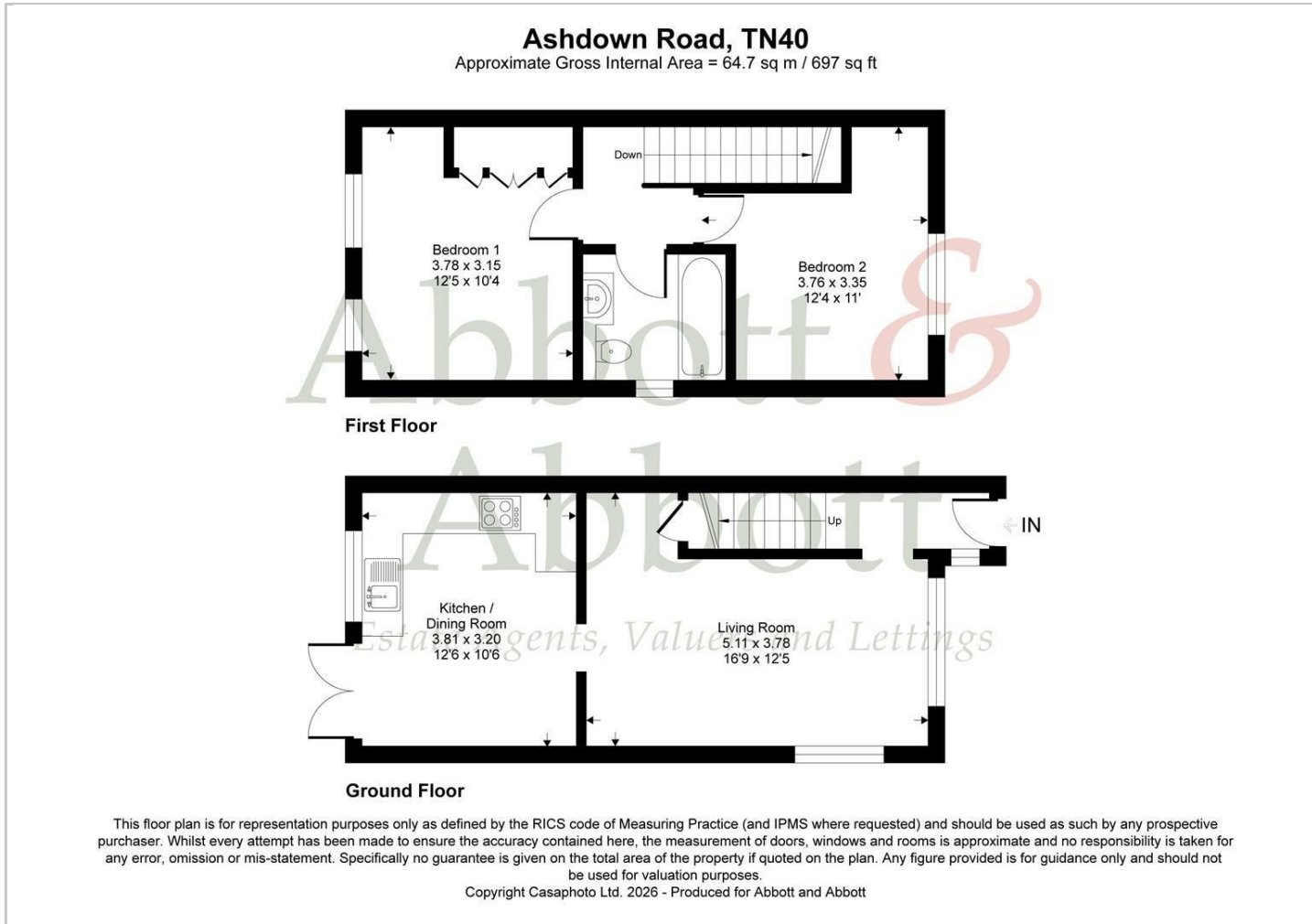

Viewing

Please contact our Sales Office on 01424 212233 if you wish to arrange a viewing appointment for this property or require further information.

The particulars are set out as a general outline only for the guidance of intended purchasers or lessees, and do not constitute, any part of a contract. Nothing in these particulars shall be deemed to be a statement that the property is in good structural condition or otherwise nor that any of the services, appliances, equipment or facilities are in good working order. Purchasers should satisfy themselves of this prior to purchasing.

25 Devonshire Road, Bexhill On Sea, East Sussex, TN40 1AH
Tel: 01424 212233 Email: sales@abbottandabbott.co.uk

Location Map

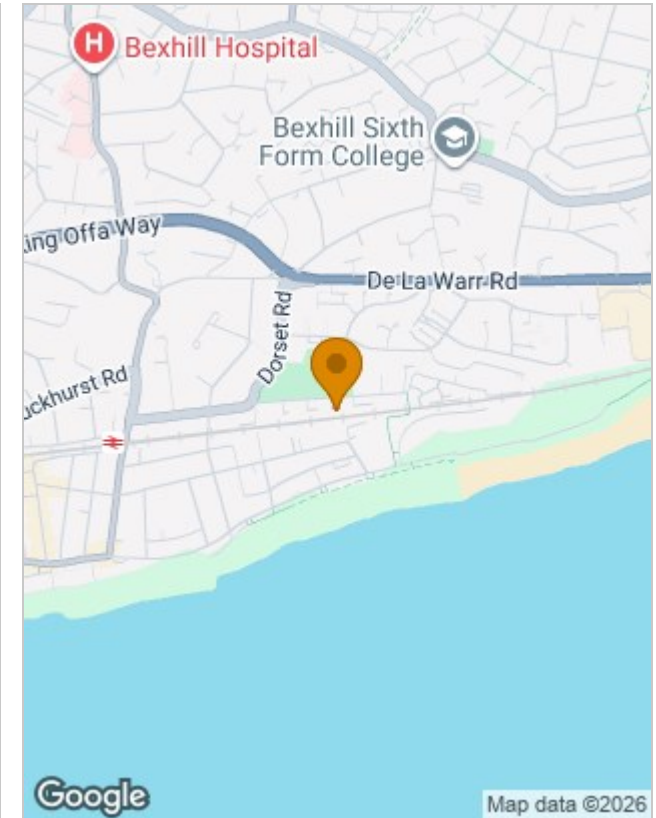

Energy Performance Graph

