



jordan fishwick

ALTRINCHAM
Sandleigh Avenue



Sandileigh Avenue, Altrincham, WA15 8AR

Offers In Excess Of £520,000



The Property

POTENTIAL FOR NO ONWARD CHAIN. Jordan Fishwick are proud to present for sale this extended three bedroom semi-detached property located within walking distance of Altrincham town centre, local parks, local transport links, amenities and within catchment of highly regarded schools.

Internally, to the ground floor, the house boasts an entrance hall, bay fronted lounge diner, sitting room and extended modern kitchen. To the first floor there are two double bedrooms with fitted wardrobes and single bedroom. The family bathroom is a four piece suite. There are also shutters throughout the property. Externally the rear garden is enclosed and south facing with a lawned area bordered by flower beds and there is also decking area, paved patio and access to the detached garage. To the front there is paved off road parking and gated access to the rear garden.

Viewings are strongly advised.

Directions

WA15 8AR



- Offering No Onward Chain
- Extended Three Bedroom Semi-Detached
- South Facing Rear Garden
- Off Road Parking
- Council Tax - C - £1,887 p.a.
- Freehold
- Detached Garage
- Walking Distance to Altrincham Town Centre
- Catchment for Highly Regarded Schools
- Four Piece Family Bathroom

Postcode - WA15 8AR

EPC Rating - C

Floor Area - 1080.00 sq ft

Local Authority - Trafford

Council Tax - C



GROUND FLOOR
643 sq.ft. (59.7 sq.m.) approx.

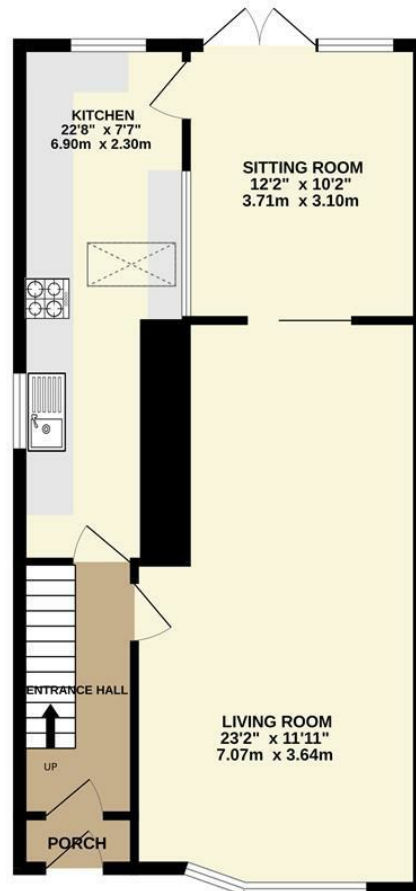

1ST FLOOR
437 sq.ft. (40.6 sq.m.) approx.

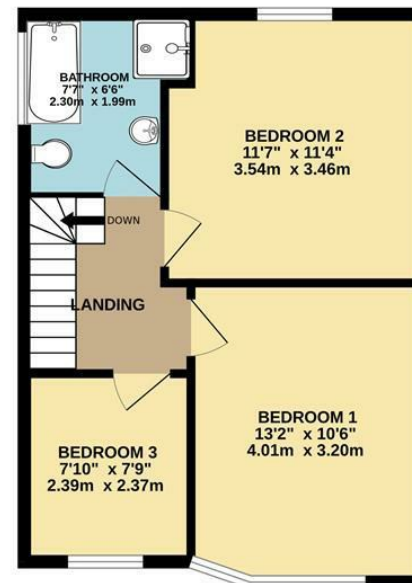

TOTAL FLOOR AREA : 1080 sq.ft. (100.3 sq.m.) approx.

Whilst every attempt has been made to ensure the accuracy of the floorplan contained here, measurements of doors, windows, rooms and any other items are approximate and no responsibility is taken for any error, omission or mis-statement. This plan is for illustrative purposes only and should be used as such by any prospective purchaser. The services, systems and appliances shown have not been tested and no guarantee as to their operability or efficiency can be given.
Made with Metropix ©2025



These particulars are believed to be accurate but they are not guaranteed and do not form a contract. Neither Jordan Fishwick nor the vendor or lessor accept any responsibility in respect of these particulars, which are not intended to be statements or representations of fact and any intending purchaser or lessee must satisfy himself by inspection or otherwise as to the correctness of each of the statements contained in these particulars. Any floorplans on this brochure are for illustrative purposes only and are not necessarily to scale.

Offices at: Chorlton, Didsbury, Disley, Hale, Glossop, Macclesfield, Manchester Deansgate, Manchester Whitworth Street, New Mills, Sale, Wilmslow and Withington

0161 929 9797

hale@jordanfishwick.co.uk
www.jordanfishwick.co.uk