



Castles

ASKING PRICE

£165,000

Tiverton House, Exeter Road

Enfield, EN3 7TW Leasehold

PROPERTY SUMMARY

CASH BUYERS ONLY. A 2 double bedroom 10th floor flat located in a high rise flat in Ponders End overlooking Durants Park close to local amenities. The property is offered for sale chain free.

Features include:- lift, own balcony, 2 double bedrooms, kitchen, bathroom, security entryphone system, chain free sale.





APPROXIMATE GROSS INTERNAL AREA
65.04 sqm / 700.08 sqft

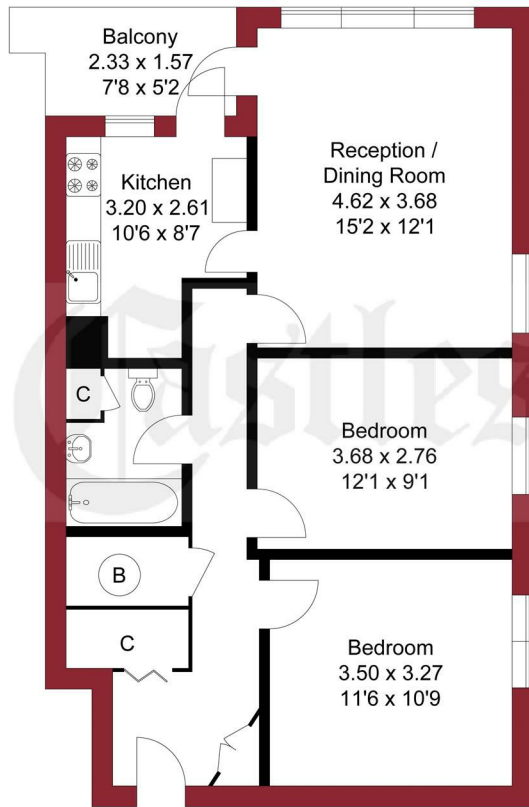

TENTH FLOOR

THIS PLAN IS FOR ILLUSTRATION ONLY AND MAY NOT BE REPRESENTATIVE OF THE PROPERTY

For a guide to the area
please scan this code for
more information

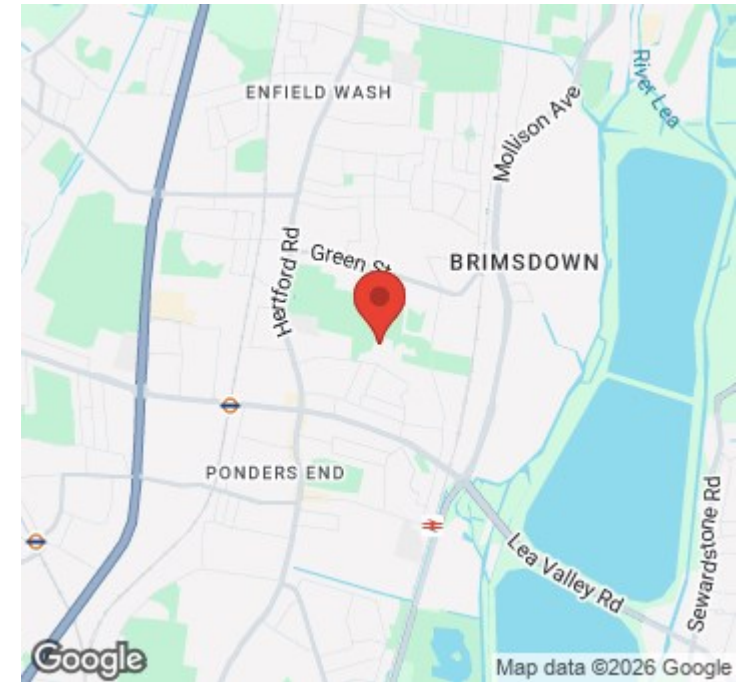

House

Leasehold

Council: Enfield

Council Tax Band: A

Lease Remaining: 125 years from 01/04/1988

Service Charge: TBC

Ground Rent: £10 P/A

Agents Note: Whilst every care has been taken to prepare these particulars, they are for guidance purposes only. All measurements are approximate and are for general guidance purposes only and whilst every care has been taken to ensure their accuracy, they should not be relied upon and potential buyers/tenants are advised to recheck the measurements



OFFICE ADDRESS

243 - 245 Hertford Road
Enfield
London
EN3 5JJ

OFFICE DETAILS

0208 804 8000
enfield@castles.london
<https://www.castles.london>

Energy Efficiency Rating		Current	Potential
Very energy efficient - lower running costs			
(92-100) A			
(81-91) B			
(69-80) C			
(55-68) D			
(39-54) E		55	61
(21-38) F			
(1-20) G			
Not energy efficient - higher running costs			
England & Wales		EU Directive 2002/91/EC	