



DAVID WILSON -
ESTATE AGENT

exp[®] UK

@ david.wilson@exp.uk.com

🌐 davidwilson.exp.uk.com

☎ 07877 818209

14 Warneage Green, Wanborough

Guide Price £150,000

2 1

Ref - DW157

Beautifully presented two-bedroom upper maisonette with an exceptionally large private garden and summer house, located in the heart of the sought-after village of Wanborough. Spacious accommodation, excellent condition throughout and ideal for investors or locals looking for something unique in this sought after village. Estimated Rental Value £1200pcm



Floor Area: sq. ft.

Tenure: Leasehold

Service Charge: £351 per annum

Ground Rent: £10 per annum

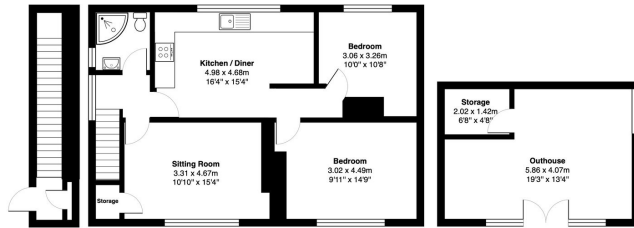

Total Area: 63.6 m² ... 685 ft² (excluding outhouse)
All measurements are approximate and for display purposes only

