



## High Holborn, WC1V

£1,199,950

This beautifully designed apartment is perfectly positioned in the heart of Holborn, set on the third floor of a sought after modern development with lift access, CCTV security, and a communal bicycle store.

Located in Midtown and just 300m from Holborn underground, this property would make the perfect London home and includes excellent access to transport, the legal district, the West End and theatreland.

### Features

- Three Bedrooms
- Two Bathrooms
- Excellent Condition
- Juliette Balcony
- Lift Access
- No Onward Chain

# High Holborn, London, WC1V

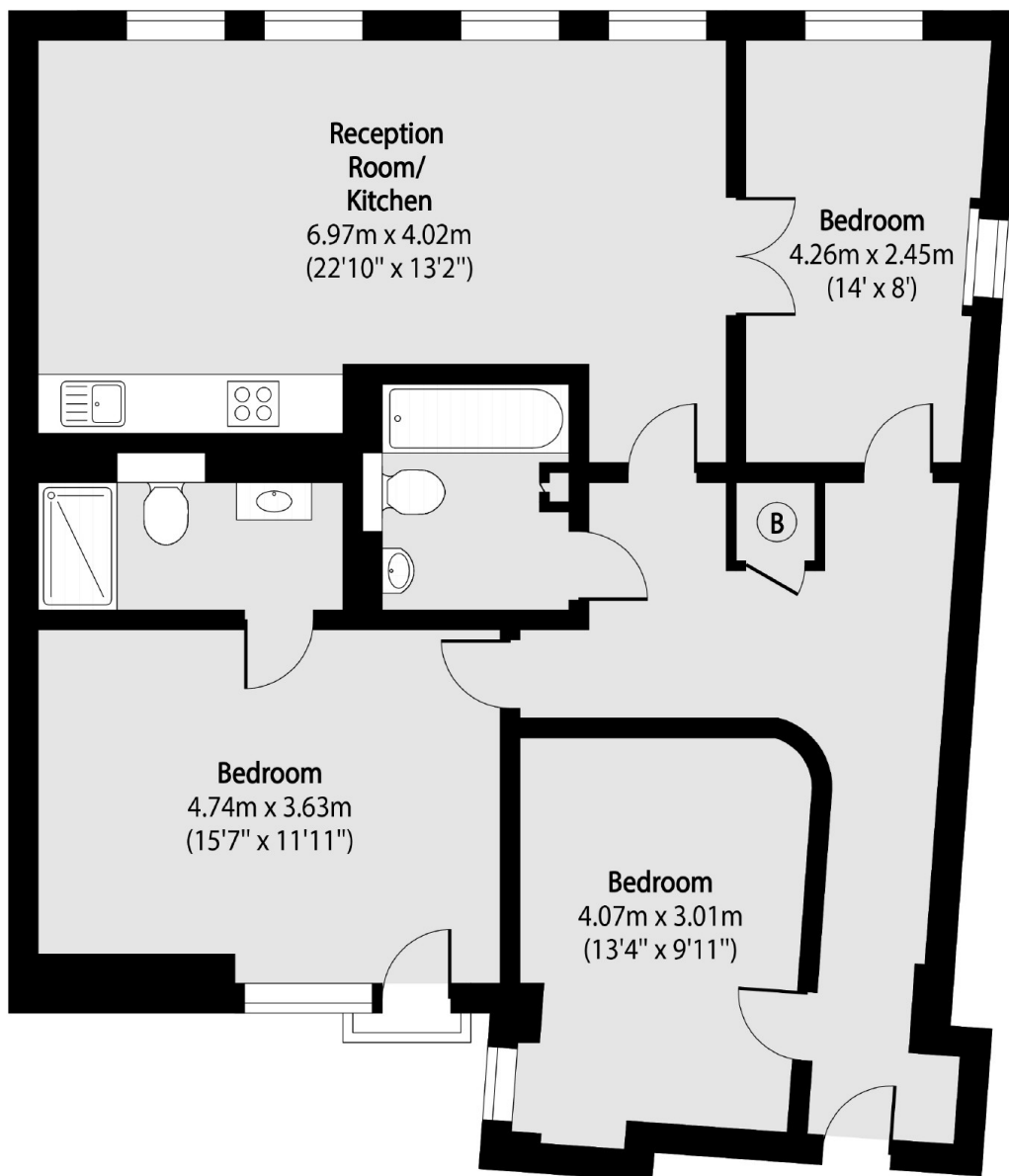

Total area (approx): 95.64 sq m (1029 sq. ft)