

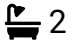

## Bryning Way, Buckshaw Village, PR7

Offers Over £230,000

 4  2  2



- Allocated parking
- Spacious accommodation across three floors
- En-suite to master bedroom
- Generous living room
- Private rear garden
- Four-bedroom townhouse
- Large top-floor master suite
- Open-plan kitchen/diner
- Family bathroom plus ground floor WC
- Sought-after Buckshaw Village location

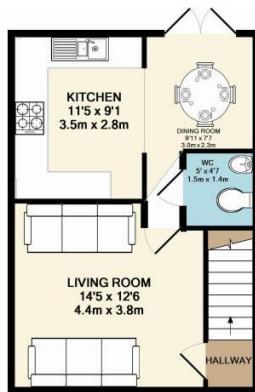

GROUND FLOOR

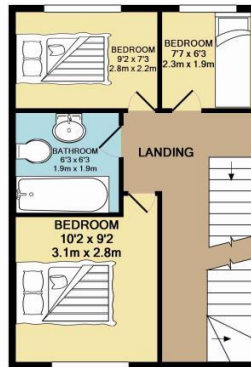

1ST FLOOR



2ND FLOOR

Whilst every attempt has been made to ensure the accuracy of the floor plan contained here, measurements of doors, windows, rooms and any other items are approximate and no responsibility is taken for any error, omission, or mis-statement. This plan is for illustrative purposes only and should be used as such by any prospective purchaser. The services, systems and appliances shown have not been tested and no guarantee as to their operability or efficiency can be given.  
Made with Metropix ©2016

**Viewing Day - 16th May - Booking Required** Clarke Residential are proud to present this spacious four-bedroom, semi detached townhouse set across three well-designed floors in the heart of Buckshaw Village. Offering versatile family living with a large lounge, open-plan kitchen/diner, two bathrooms, and a standout top-floor master suite. Externally benefitting from a private rear garden and allocated parking, this is an ideal home for growing families or professionals seeking modern living in a highly convenient location.