



Offerton Road, London SW4 0DJ



welcome to
Offerton Road, London

Set on one of Clapham Old Town's most desirable residential streets, this charming one-bedroom period conversion offers an appealing balance of vibrant London living, open green space and village-like character.

Occupying part of the top floor of an attractive Victorian end-of-terrace building, the flat enjoys a peaceful garden-facing aspect, far-reaching views and excellent natural light.

The accommodation extends to approximately 366 square feet and is well arranged, with a bright reception room, practical semi open-plan kitchen, and a bedroom quietly positioned to the rear of the building.

Clapham Common park is effectively on the doorstep, while Clapham Common Underground Station is within a short walk, providing excellent Northern line access into both the City and the West End. Clapham High Street Overground is also nearby.

The location also benefits from the character of nearby Clapham Old Town and Abbeville Village, with an excellent choice of shops, cafés, restaurants, bakeries, pubs and local amenities close by.



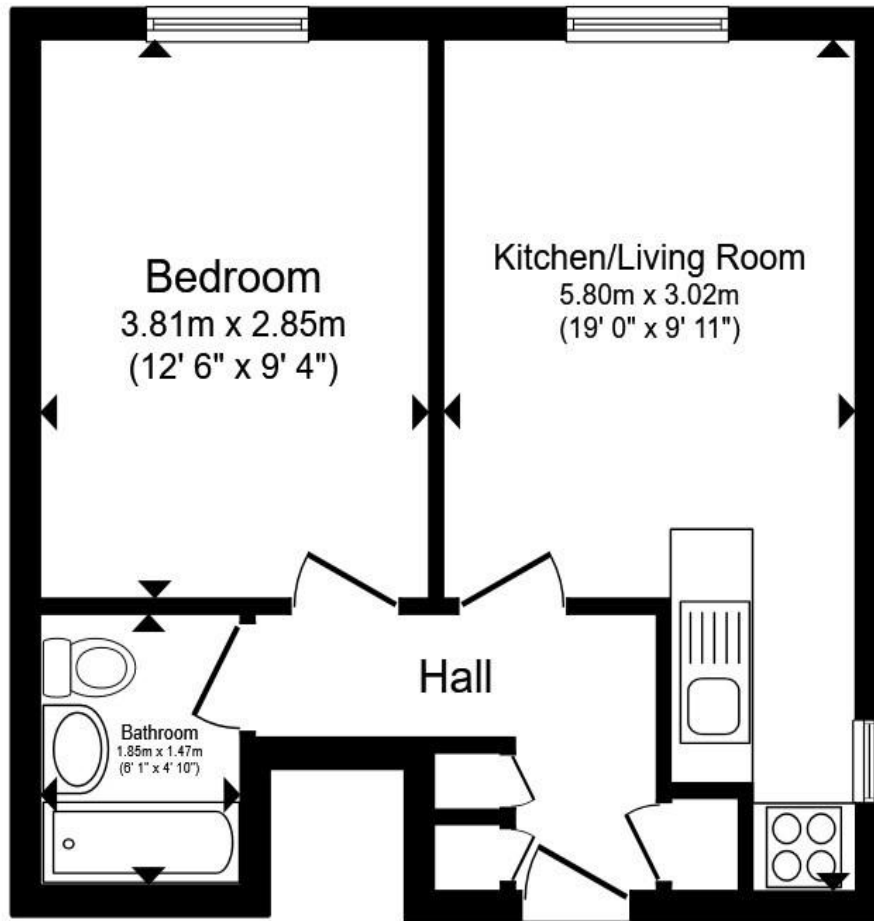

Total floor area 34.0 m² (366 sq.ft.) approx

This floor plan is for illustrative purposes only. It is not drawn to scale. Any measurements, floor areas (including any total floor area), openings and orientation are approximate. No details are guaranteed, they cannot be relied upon for any purpose and they do not form part of any agreement. No liability is taken for any error, omission or misstatement. A party must rely upon its own inspection(s). Powered by www.propertybox.io



welcome to

Offerton Road, London

- Top floor one-bedroom period conversion with share of freehold
- Peaceful garden-facing outlook with far-reaching views
- Prime Clapham Old Town location
- Clapham Common park on the doorstep
- Peaceful garden-facing outlook with far-reaching views

Tenure: Leasehold EPC Rating: D

Council Tax Band: C Service Charge: 2400.00

Ground Rent: Ask Agent

This is a Leasehold property with details as follows; Term of Lease 999 years from 25 Dec 1990. Should you require further information please contact the branch. Please Note additional fees could be incurred for items such as Leasehold packs.

£420,000



view this property online barnardmarcus.co.uk/Property/CPM107447



Property Ref:
CPM107447 - 0009

1. MONEY LAUNDERING REGULATIONS Intending purchasers will be asked to produce identification documentation at a later stage and we would ask for your co-operation in order that there is no delay in agreeing the sale. 2. These particulars do not constitute part or all of an offer or contract. 3. The measurements indicated are supplied for guidance only and as such must be considered incorrect. Potential buyers are advised to recheck measurements before committing to any expense. 4. We have not tested any apparatus, equipment, fixtures or services and it is in the buyers interest to check the working condition of any appliances. 5. Where an EPC, or a Home Report (Scotland only) is held for this property, it is available for inspection at the branch by appointment. If you require a printed version of a Home Report, you will need to pay a reasonable production charge reflecting printing and other costs. 6. We are not able to offer an opinion either written or verbal on the content of these reports and this must be obtained from your legal representative. 7. Whilst we take care in preparing these reports, a buyer should ensure that his/her legal representative confirms as soon as possible all matters relating to title including the extent and boundaries of the property and other important matters before exchange of contracts.

Barnard Marcus is a trading name of Sequence (UK) Limited which is registered in England and Wales under company number 4268443, Registered Office is Cumbria House, 16-20 Hockliffe Street, Leighton Buzzard, Bedfordshire, LU7 1GN. VAT Registration Number is 500 2481 05.



barnard marcus



020 7720 5932



Clapham@barnardmarcus.co.uk



85 Rectory Grove, Clapham, LONDON, SW4 0DR



barnardmarcus.co.uk

Please note the marker reflects the postcode not the actual property